

FLEXIBLE EXTERIOR BODY PANELS

CONTENTS

DESCRIPTION AND OPERATION	
Description of Flexible Body Panels	8G-1
DIAGNOSIS: (Not Applicable)	
MAINTENANCE AND ADJUSTMENTS: (Not Applicable)	
MAJOR REPAIR	
H Series Rear End Panel Removal and Installation	8G-1
Removal and Installation of Rear Quarter Panel Extension Caps	
C Series	8G-1
E Series	8G-1
SPECIFICATIONS: (Not Applicable)	

DESCRIPTION AND OPERATION

DESCRIPTION OF FLEXIBLE BODY PANELS

Certain exterior body panels are made of a highly flexible, color co-ordinated, molded urethane. Since these panels are flexible they cannot be painted with acrylic lacquer.

Urethane paint and materials are especially made with a flexible conditioner so that the cured film will flex without cracking.

MAJOR REPAIR

H SERIES REAR END PANEL REMOVAL AND INSTALLATION

Removal

1. Open trunk and remove the top center retainer. Figure 8G-1.
2. Remove the jack assembly cover.
3. Remove the panel to back of body nuts. Figure 8G-1.
4. Remove the panel to Quarter panel nuts.
5. Remove the panel to bumper cover nuts and retainers.
6. Remove the tail light assemblies and remove rear end cover.

Installation

1. Reverse the removal procedures for installation.

REMOVAL AND INSTALLATION OF REAR QUARTER PANEL EXTENSION CAPS

C Series Removal

1. Open trunk and remove the two screws securing the cardboard and carpet (if equipped) to the rear ledge of the trunk well.
2. Lift up the bottom carpet (if equipped) on the side to be worked on and remove the side panel carpet. Set aside.
3. Remove the end cap screw located at the small chrome strip. Also the screws at the bottom and inside bottom of the cap.

4. Remove the six nuts from inside the trunk and remove cap.

5. Remove metal framework if cap is to be replaced or painted.

C Series Installation

1. Clean the holes in the body and the cap studs of body sealer. Install frame inside cap and position cap to car.
2. Reseal studs. Install nuts and align cap while tightening nuts.
3. Install the 3 screws.
4. Install side carpet, reposition bottom carpet and install two screws in rear ledge area carpet.

E Series Removal

1. Open trunk and remove the side and rear trunk coverings (on the side to be worked on) enough to gain access to the cap attaching nuts.
2. Remove the tail lamp chrome covering attaching nuts. Prop gas door open and remove chrome covering.
3. Remove the 2 screws securing the extension cap at the lower outer corner of the tail lamp opening.
4. Disconnect the side marker light socket to protect from damage and remove the 9 cap attaching nuts.
5. Remove the bottom metal framework to aid in removal of cap. Protect cap from scratching and remove.
6. If extension cap is to be replaced or painted, remove the two metal frameworks inside by removing one screw and one retainer. Discard Retainer.

E Series Installation

1. Install metal frames in extension cap and secure the one with the screw.
2. Clean stud holes in body of sealer to aid installation. Carefully install extension cap.
3. Install bottom metal frame and seal studs with body sealer.

5. Install the two screws at the tail lamp opening and tighten.

4. Install cap attaching nuts and align cap to body while tightening nuts. Connect side marker light.

6. Install the tail lamp chrome covering and tighten nuts.

7. Reinstall the trunk side coverings.

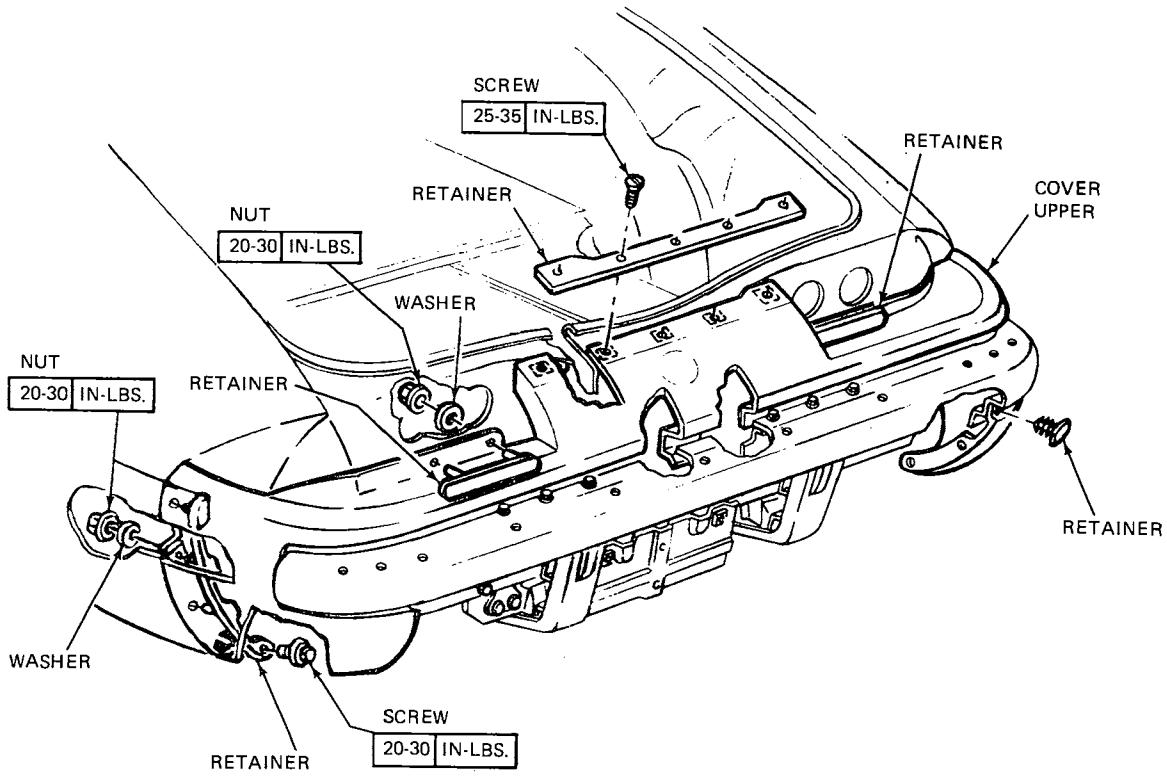

5B8G1

Figure 8G-1 H Series Rear End Panel