

FRONT END PANEL

WARNING: IF EQUIPPED WITH AIR CUSHION RESTRAINT SYSTEM, DO NOT ATTEMPT ANY ADJUSTMENT, REPAIR OR REMOVAL OF ANY PORTION OF THE CHASSIS SHEET METAL WHICH WOULD REQUIRE REMOVAL OR DISCONNECTING OF THE BUMPER IMPULSE DETECTOR UNTIL THE DISCONNECTION PROCEDURE IS COMPLETED. THIS PROCEDURE MUST BE FOLLOWED TO PREVENT ACCIDENTAL DEPLOYMENT OF THE SYSTEM WHICH COULD RESULT IN PERSONAL INJURY AND/OR DAMAGE TO THE SYSTEM'S COMPONENTS. IN ADDITION, CARE MUST BE EXERCISED TO NEVER BUMP OR STRIKE THE BUMPER IMPULSE DETECTOR IN A MANNER WHICH COULD CAUSE INADVERTENT DEPLOYMENT OR IMPROPER OPERATION OF THE SYSTEM.

A.C.R.S. DISCONNECTION PROCEDURE

1. Turn ignition switch to "LOCK" position. Disconnect the negative battery cable from the battery and tape end.

CONTENTS

DESCRIPTION AND OPERATION:	
Description of Panels	8D-1
DIAGNOSIS: (Not Applicable)	
MAINTENANCE AND ADJUSTMENTS: (Not Applicable)	
MAJOR REPAIR:	
Front End Panel Extension Removal and Installation	8D-1
Front End Panel Removal and Installation.....	8D-1
SPECIFICATIONS: (Not Applicable)	

DESCRIPTION AND OPERATION

DESCRIPTION OF FRONT END PANEL

The H Series front end panel is made of a molded, flexible urethane plastic. Since the panel is flexible it cannot be painted with acrylic lacquer.

Urethane paint and materials are especially made with a flexible conditioner so that the cured film will flex without cracking.

The front end panel on the A Series Regal is made of a one piece molded fiber glass panel. As when handling any panel, caution should be used to prevent damage.

The A Series Century, B, C and E Series use a metal front end panel.

MAJOR REPAIR

A SERIES CENTURY FRONT END PANEL EXTENSION REMOVAL AND INSTALLATION

A Series Removal

1. Remove radiator grille as per Grille Section.
2. Unplug headlight wiring and remove the 2 parking light lens assembly nuts, per each side, and pull assemblies out of way.
3. Remove the nuts that attach the extension to vehicle, Figure 8D-4, and remove extension.

4. Remove headlight items from extension.

A Series Installation

1. Reverse the removal procedure for installation.

FRONT END PANEL REMOVAL AND INSTALLATION

H Series removal and installation procedure are covered in the 1975 Body Manual. Refer to Figure 8D-1, 8D-2 and 8D-3 for exploded views.

A Series Removal

1. Remove radiator grille as per Grille Section.
2. Remove the front end panel extension assemblies as per extension removal in this section.
3. Remove the panel to fender bolts, see Figures 8D-4 and 8D-5.
4. Remove the panel to radiator support bolts, see Figures 8D-4 and 8D-5.
5. Remove the panel and protect from scratching.

It may be necessary to loosen the front of one fender and pull outward to allow room for removal.

A Series Installation

1. It may be necessary to loosen the front of one fender

and pull outward to allow room for the panel to slide in place.

2. Reverse the removal procedure for installation.

B-C Series Removal

1. Remove radiator grille, and grille extension - (per Grille section).
2. Remove panel to radiator support bolts see Figure 8D-8.
3. Remove panel to fender bolts see Figure 8D-7.
4. Remove the panel and protect from scratching.

It may be necessary to loosen the front of one fender and pull outward to allow room for removal.

B-C Series Installation

1. If panel will not slide into place it may be necessary to loosen a fender and pull outward.

E Series Removal

1. Remove radiator grille - (per Grille section).
2. Remove panel to radiator support, and fender bolts. See Figure 8D-10.
3. Remove the panel and protect from scratching.

It may be necessary to loosen the front of one fender and pull outward to allow room for removal.

E Series Installation

1. If panel will not slide into place it may be necessary to loosen a fender and pull outward.
2. Reverse the removal procedure for installation.

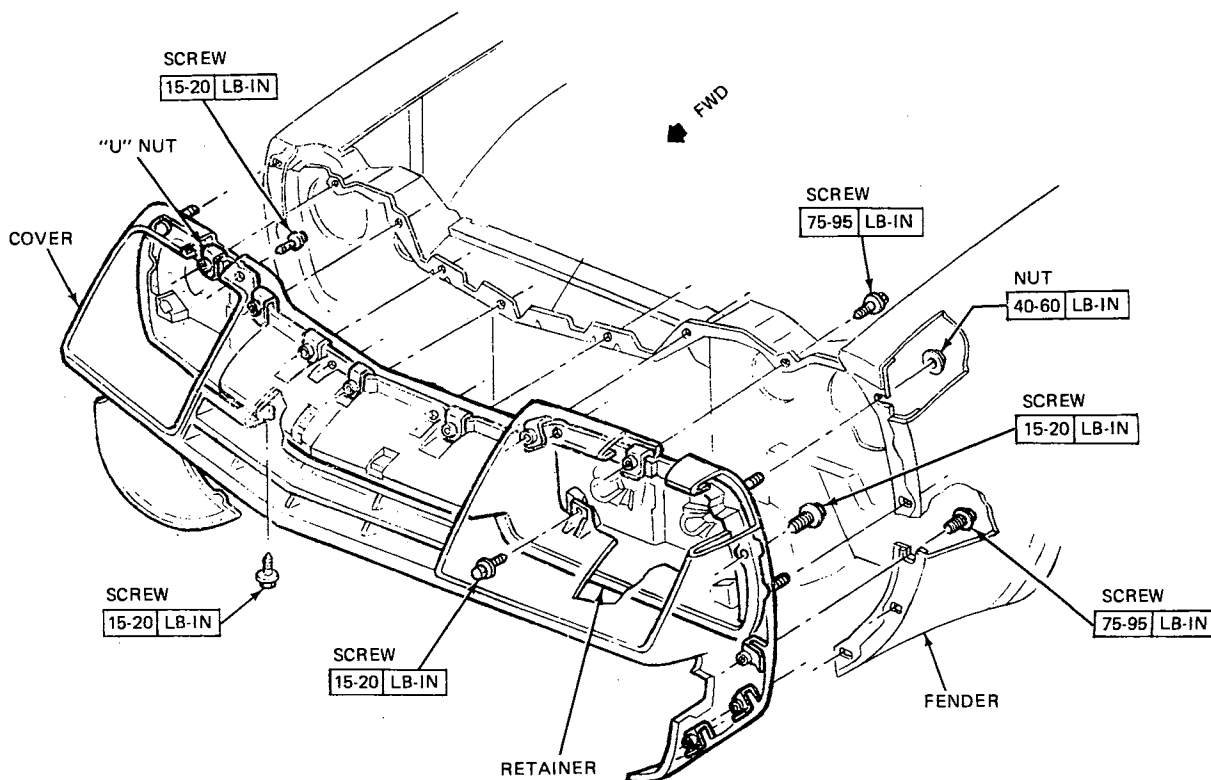

5B8D1

Figure 8D-1 H Series Front End Panel

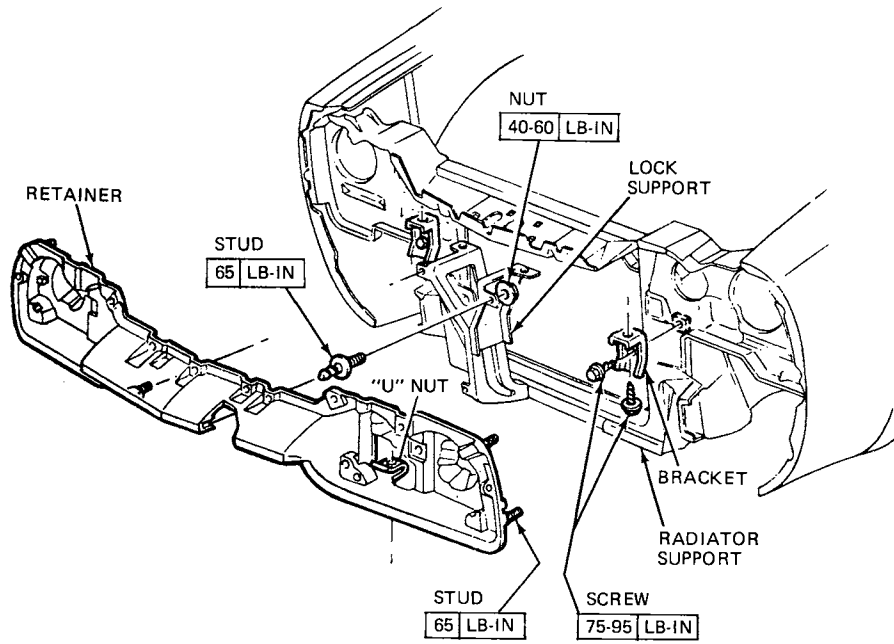

588D2

Figure 8D-2 H Series Front End Panel Retainer

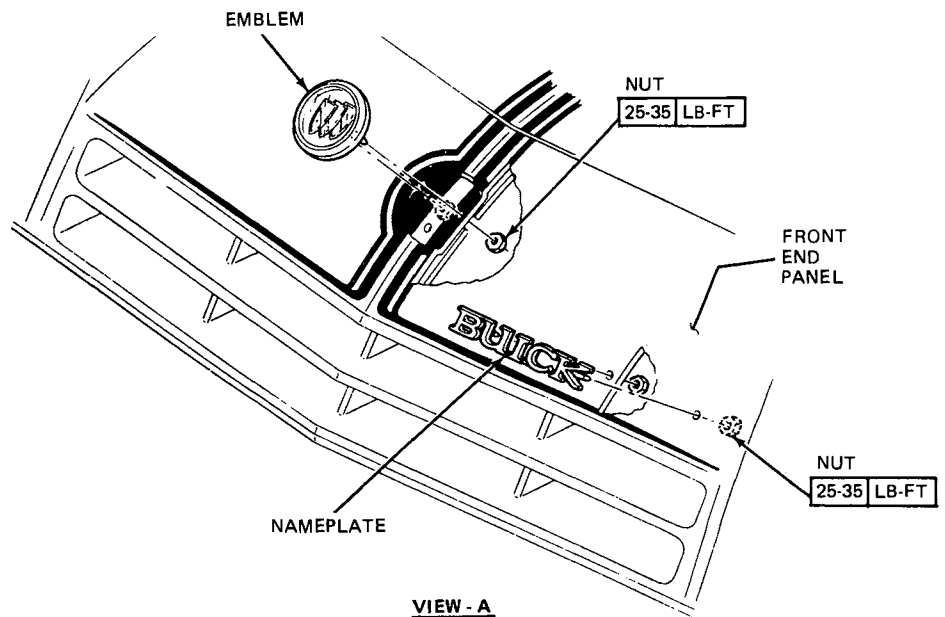
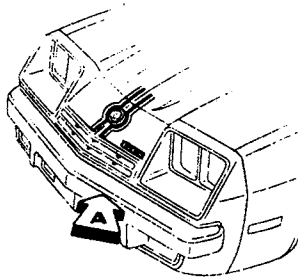

588D3

Figure 8D-3 H Series Front End Panel Ornamentation

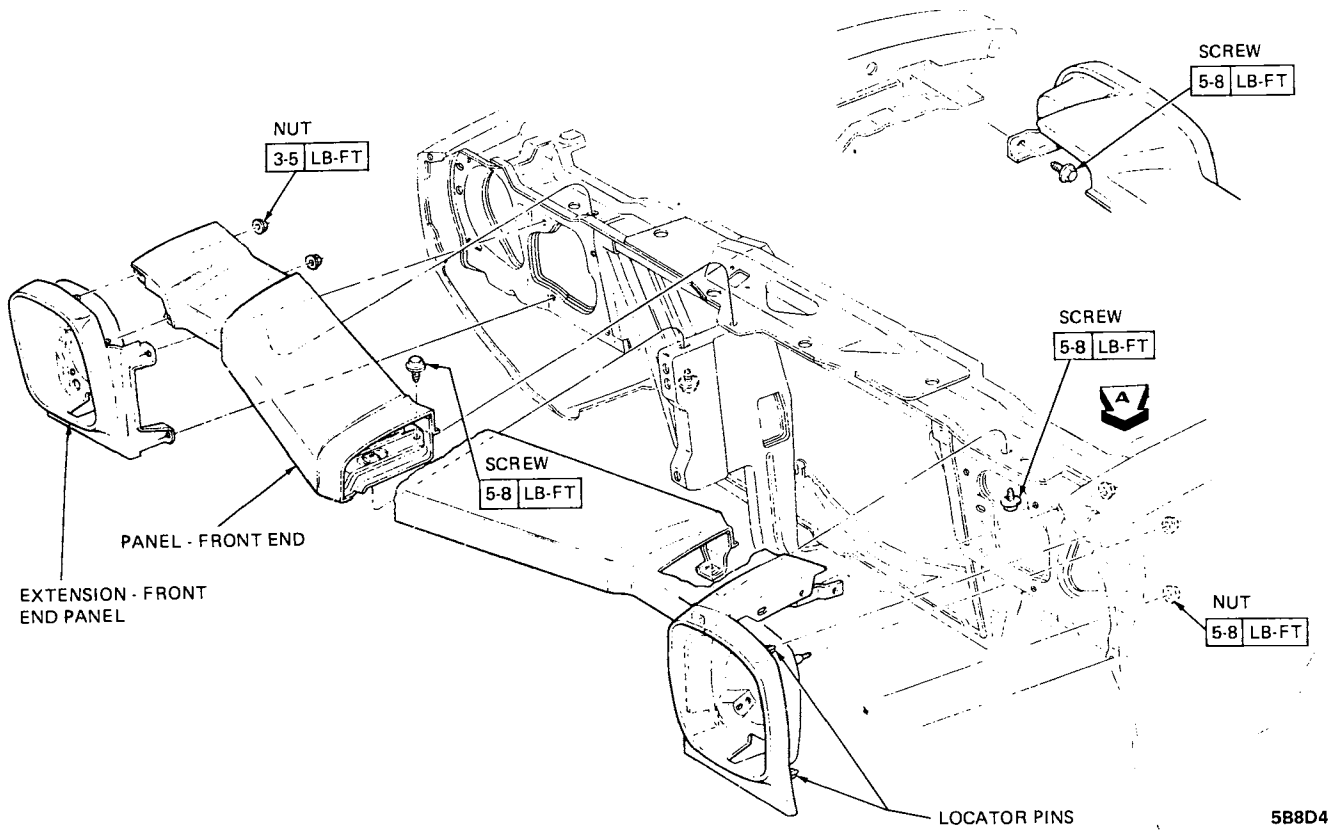

Figure 8D-4 A Series less Regal Front End Panel Assembly

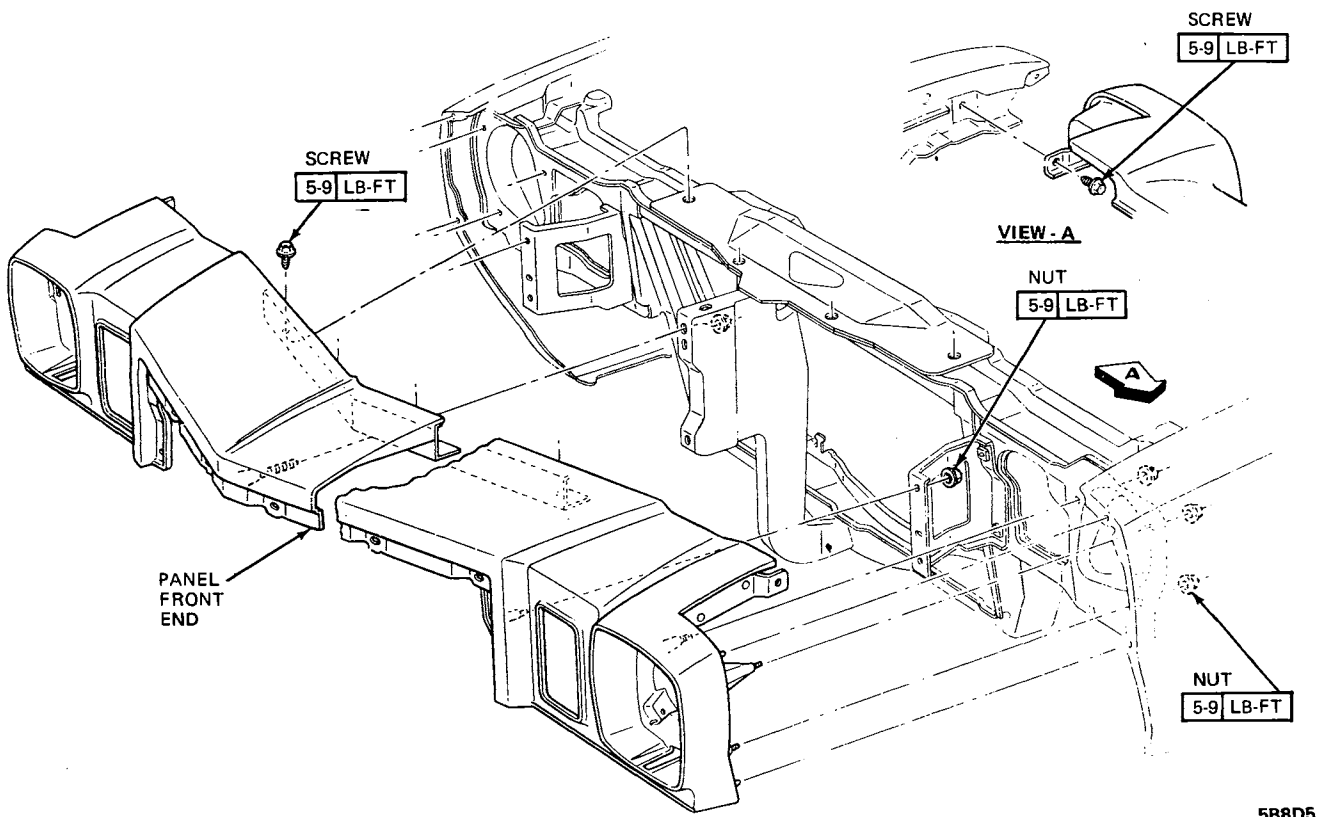
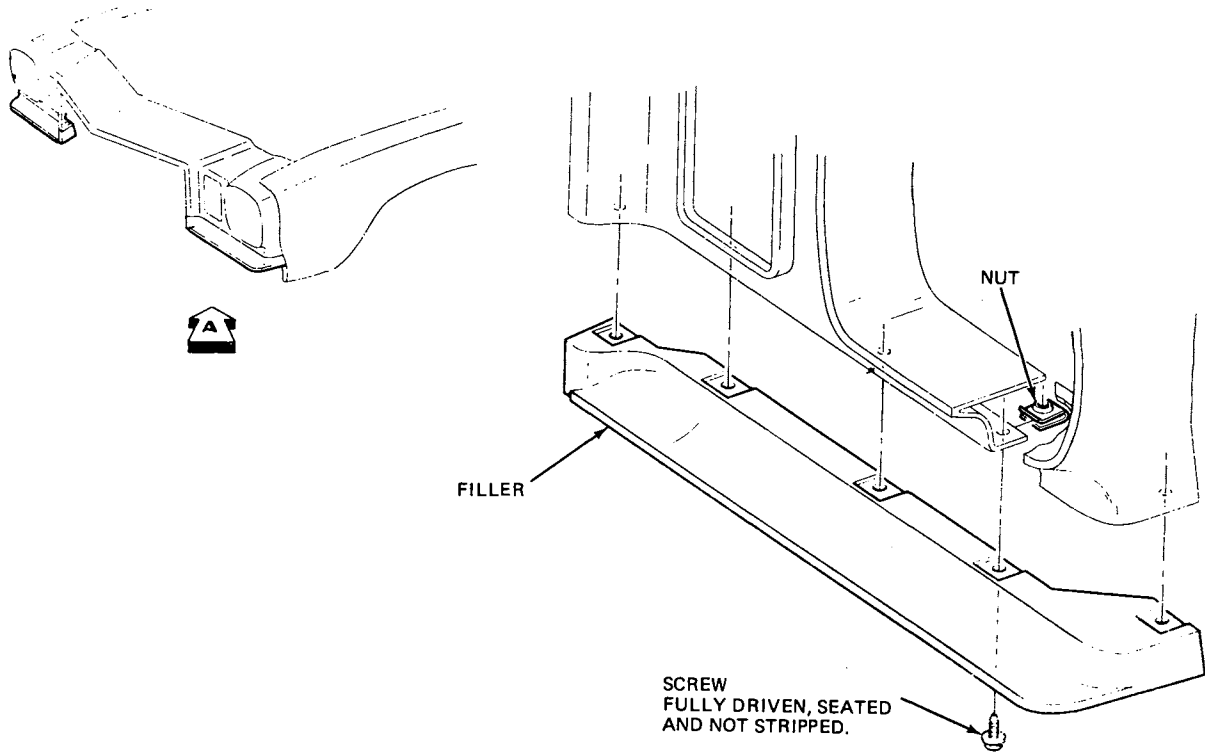
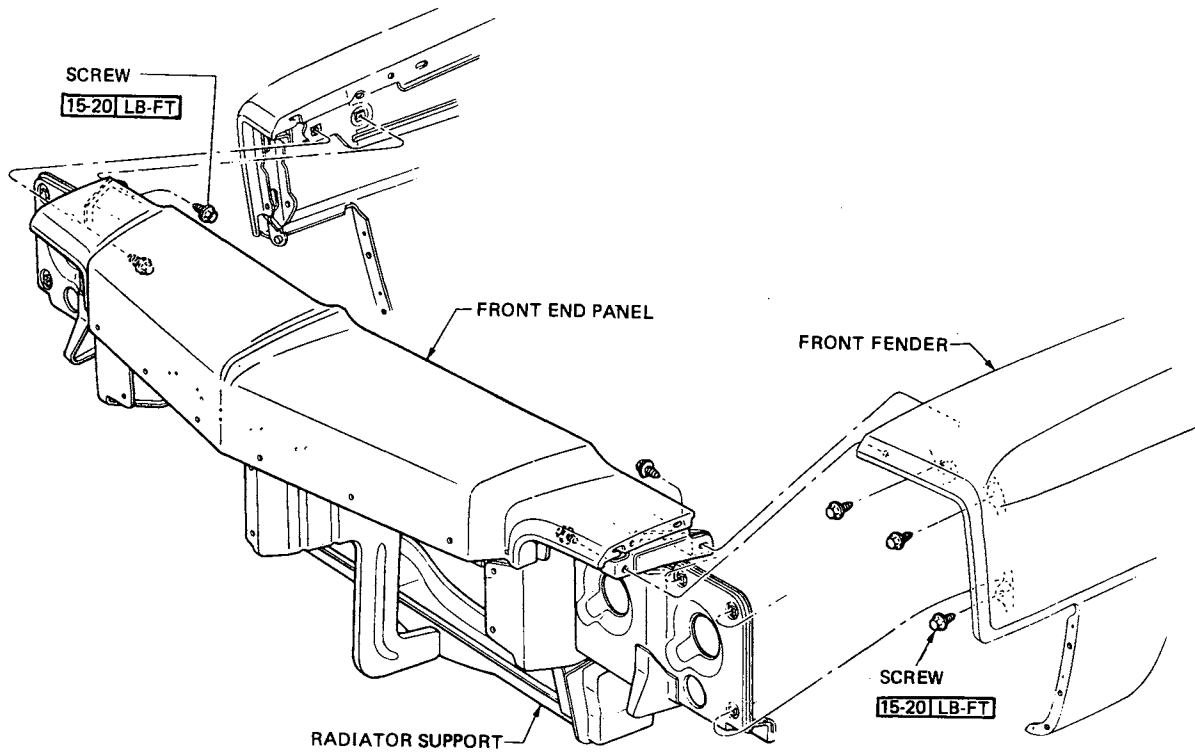

Figure 8D-5 A Series Regal Front End Panel



5B8D6

Figure 8D-6 A Series Regal Front End Pillar



5B8D7

Figure 8D-7 B-C Series Front End Panel to Fender

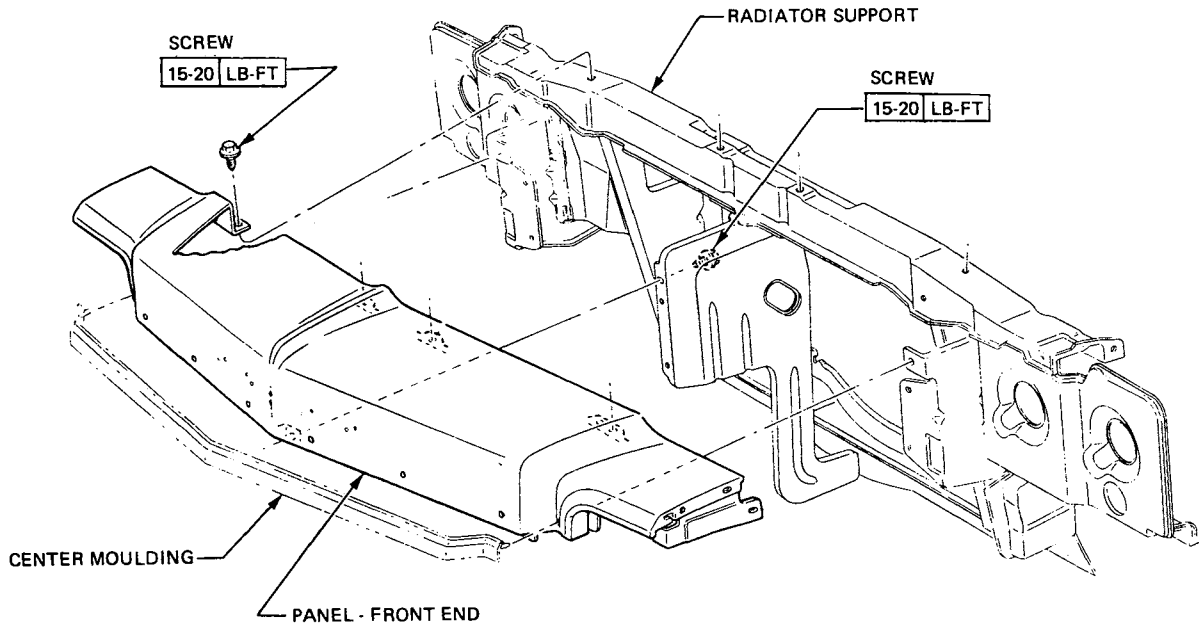

5B8D8

Figure 8D-8 B-C Series Front End Panel to Radiator Support

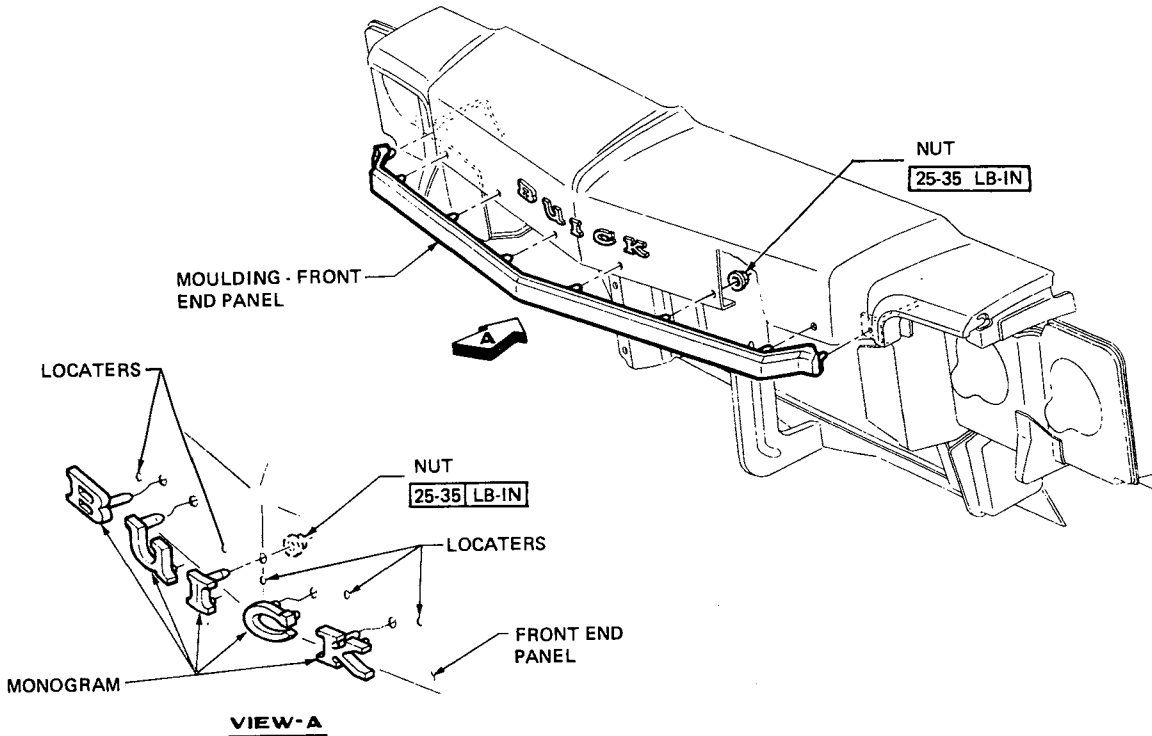

5B8D9

Figure 8D-9 B-C Series Front End Panel Ornamentation

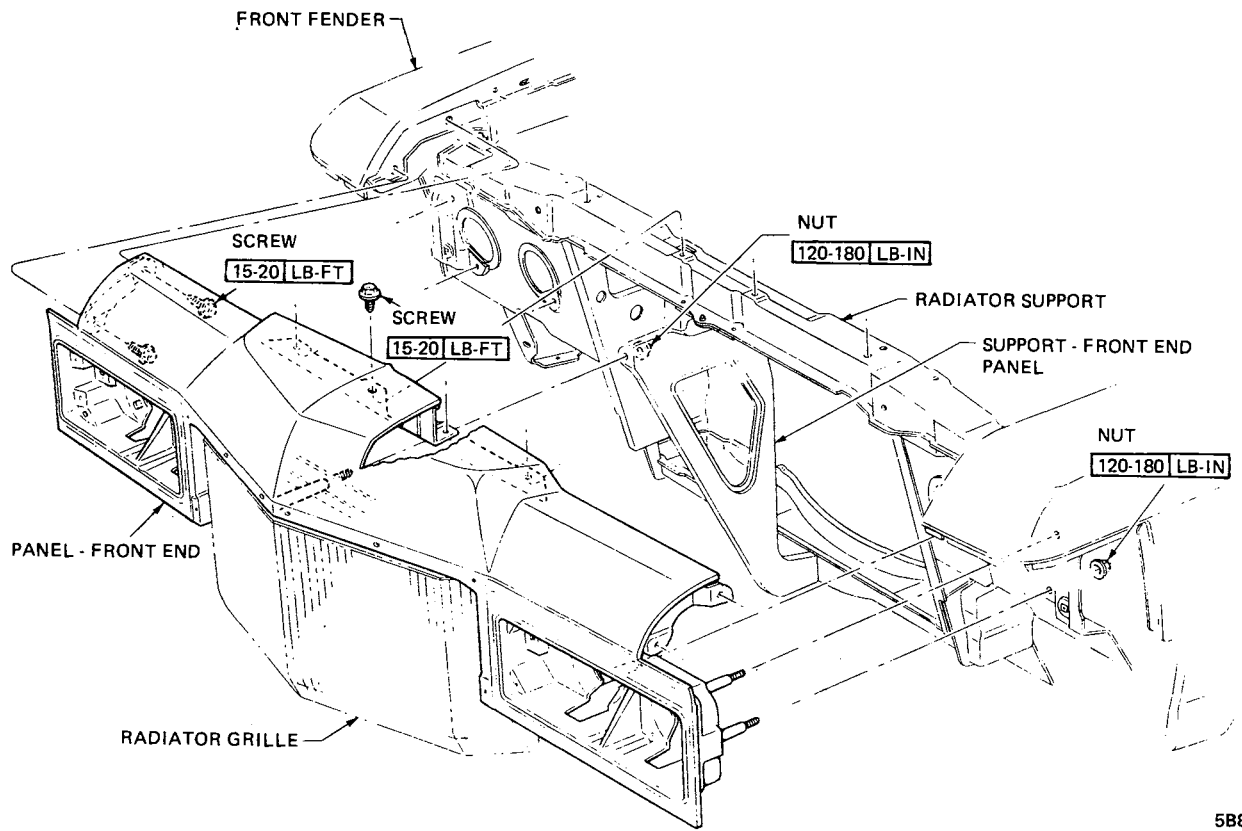

5B8D10

Figure 8D-10 E Series Front End Panel

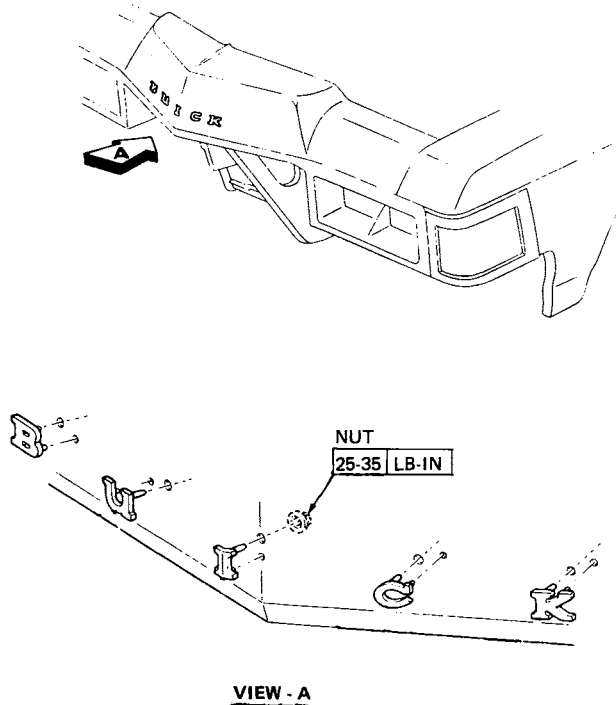

5B8D11

Figure 8D-11 E Series Front End Panel Ornamentation

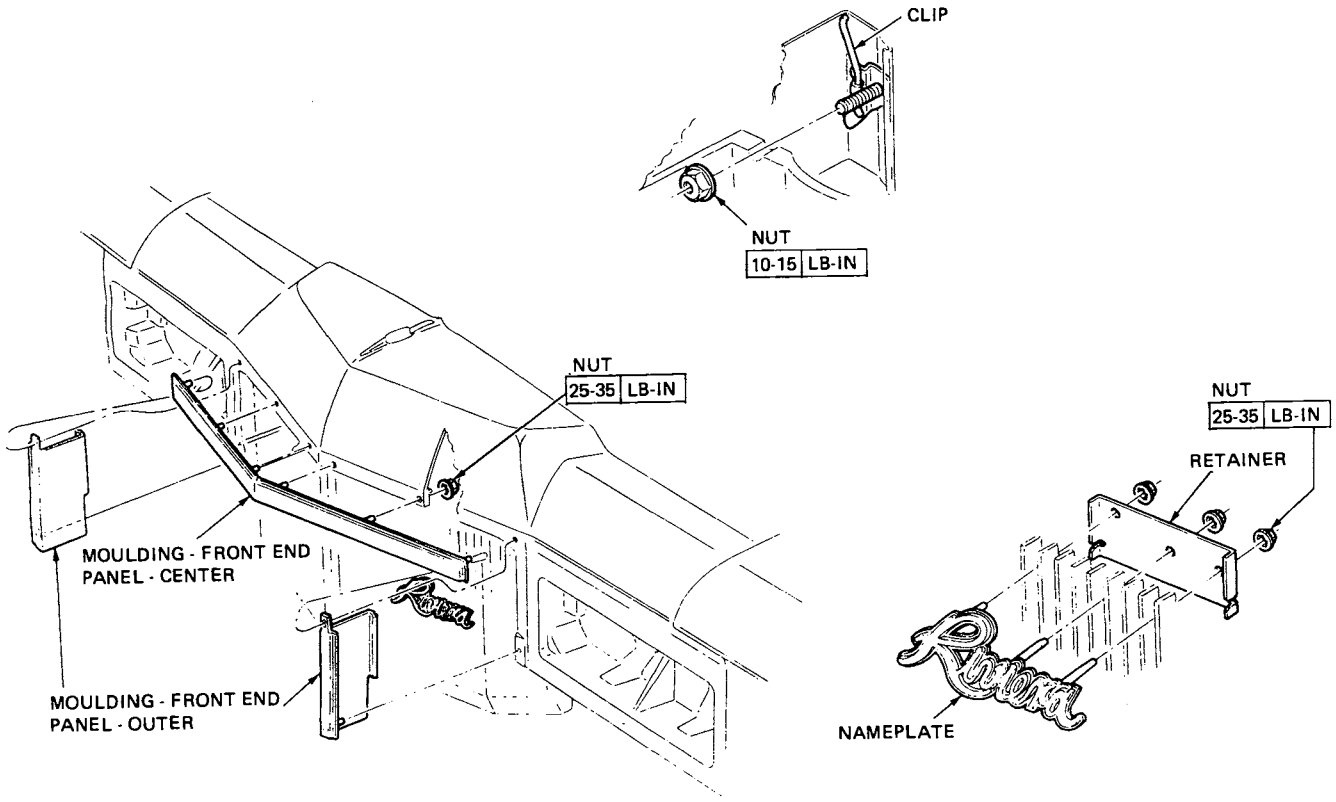

5B8D12

Figure 8D-12 E Series Front End Panel Ornamentation