

FRONT END PANEL

WARNING: IF EQUIPPED WITH AIR CUSHION RESTRAINT SYSTEM, DO NOT ATTEMPT ANY ADJUSTMENT, REPAIR OR REMOVAL OF ANY PORTION OF THE CHASSIS SHEET METAL WHICH WOULD REQUIRE REMOVAL OR DISCONNECTING OF THE BUMPER IMPULSE DETECTOR UNTIL THE DISCONNECTION PROCEDURE IS COMPLETED. THIS PROCEDURE MUST BE FOLLOWED TO PREVENT ACCIDENTAL DEPLOYMENT OF THE SYSTEM WHICH COULD RESULT IN PERSONAL INJURY AND/OR DAMAGE TO THE SYSTEM'S COMPONENTS. IN ADDITION, CARE MUST BE EXERCISED TO NEVER BUMP OR STRIKE THE BUMPER IMPULSE DETECTOR IN A MANNER WHICH COULD CAUSE INADVERTENT DEPLOYMENT OR IMPROPER OPERATION OF THE SYSTEM.

A.C.R.S. DISCONNECTION PROCEDURE

1. Turn ignition switch to "LOCK" position. Disconnect the negative battery cable from the battery and tape end.

CONTENTS

Subject	Page No.
DESCRIPTION AND OPERATION:	
Description of Panels	8D-46
DIAGNOSIS: (Not Applicable)	
MAINTENANCE AND ADJUSTMENTS:	
(Not Applicable)	
MAJOR REPAIR:	
Front End Panel Extension Removal and Installation	8D-46
Front End Panel Removal and Installation	8D-46
SPECIFICATIONS: (Not Applicable)	

DESCRIPTION AND OPERATION

DESCRIPTION OF FRONT END PANEL

The front end panel on the A Series Regal is made of a one piece molded fiber glass panel. As when handling any panel, caution should be used to prevent damage.

The X Series, A Series Century, B, C and E Series use a metal front end panel.

MAJOR REPAIR

A SERIES CENTURY FRONT END PANEL EXTENSION REMOVAL AND INSTALLATION

A Series Removal

1. Remove radiator grille as per Grille Section.

2. Unplug headlight wiring and remove the 2 parking light lens assembly nuts, per each side, and pull assemblies out of way.

3. Remove the 6 nuts per side that attach the extension to vehicle, Figure 8D-3, and remove extension.

4. Remove headlight items from extension.

A Series Installation

1. Reverse the removal procedure for installation.

FRONT END PANEL REMOVAL AND INSTALLATION

X Series Removal

1. Remove radiator grille as outlined in grille section.

2. Remove headlamp bezels.
3. Remove the front end panel to radiator support bolts (3). (See Figure 8D-1).
4. Remove the front end panel to fender bolts (8) and pull panel forward (Figure 8D-1).

X Series Installation

1. Reverse the removal procedure for installation.

A Series Removal

1. Remove radiator grille as per Grille Section.
2. Remove the front end panel extension assemblies as per extension removal in this section.
3. Remove the panel to fender bolts, see Figures 8D-3 and 8D-4.
4. Remove the panel to radiator support bolts, see Figures 8D-3 and 8D-4.
5. Remove the panel and protect from scratching.

A Series Installation

1. It may be necessary to loosen the front of one fender and pull outward to allow room for the panel to slide in place.
2. Reverse the removal procedure for installation.

B-C Series Removal

1. Remove radiator grille, and grille extension - (per Grille section).
2. Remove panel to radiator support bolts see Figure 8D-8.
3. Remove panel to fender bolts see Figure 8D-9.
4. Remove the panel and protect from scratching.

B-C Series Installation

1. If panel will not slide into place it may be necessary to loosen a fender and pull outward.
2. Reverse the removal procedure for installation.

E Series Removal

1. Remove radiator grille - (per Grille section).
2. Remove panel extensions see Figure 8D-10.
3. Remove panel to radiator support, and fender bolts. See Figure 8D-11.
4. Remove the panel and protect from scratching.

E Series Installation

1. If panel will not slide into place it may be necessary to loosen a fender and pull outward.
2. Reverse the removal procedure for installation.

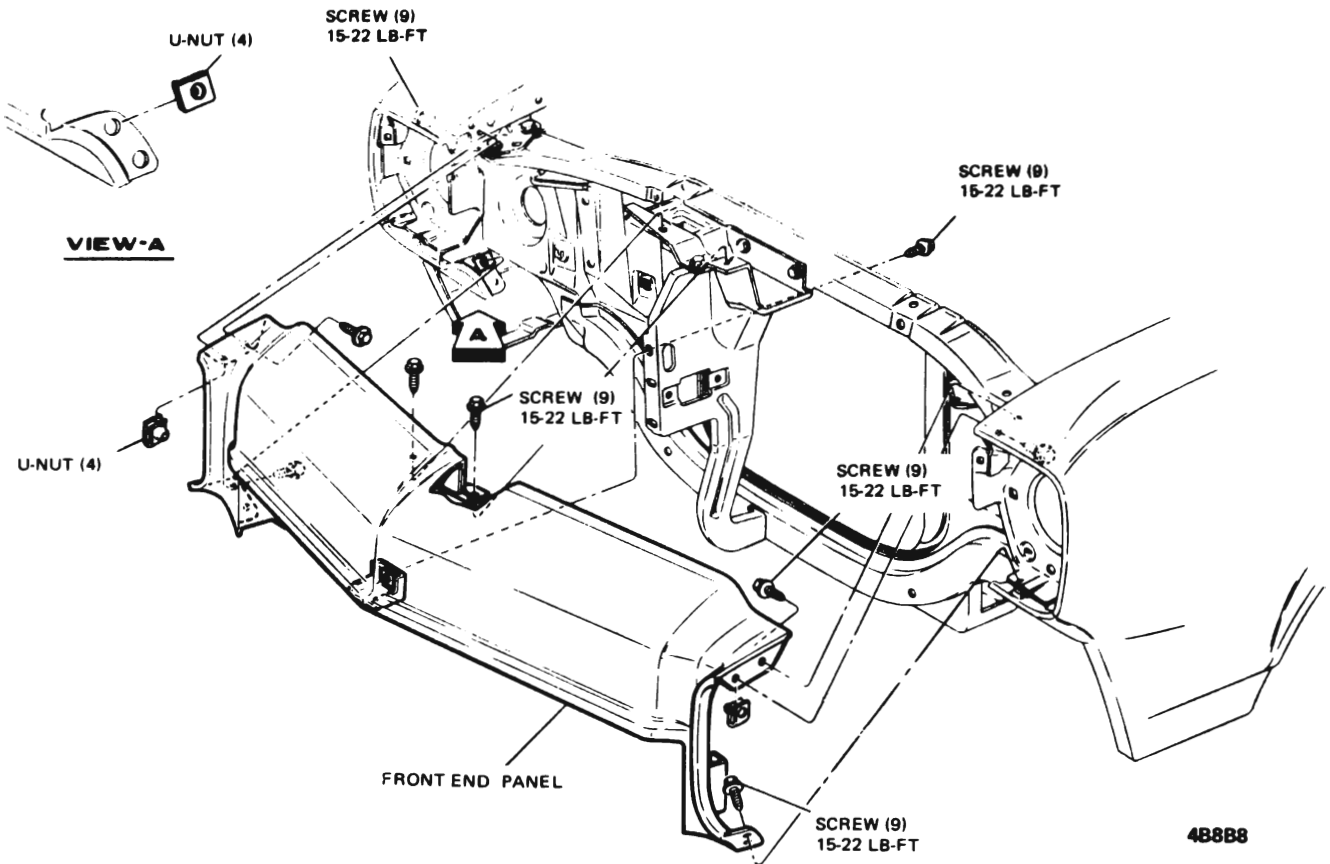

Figure 8D-1 X Series Front End Panel

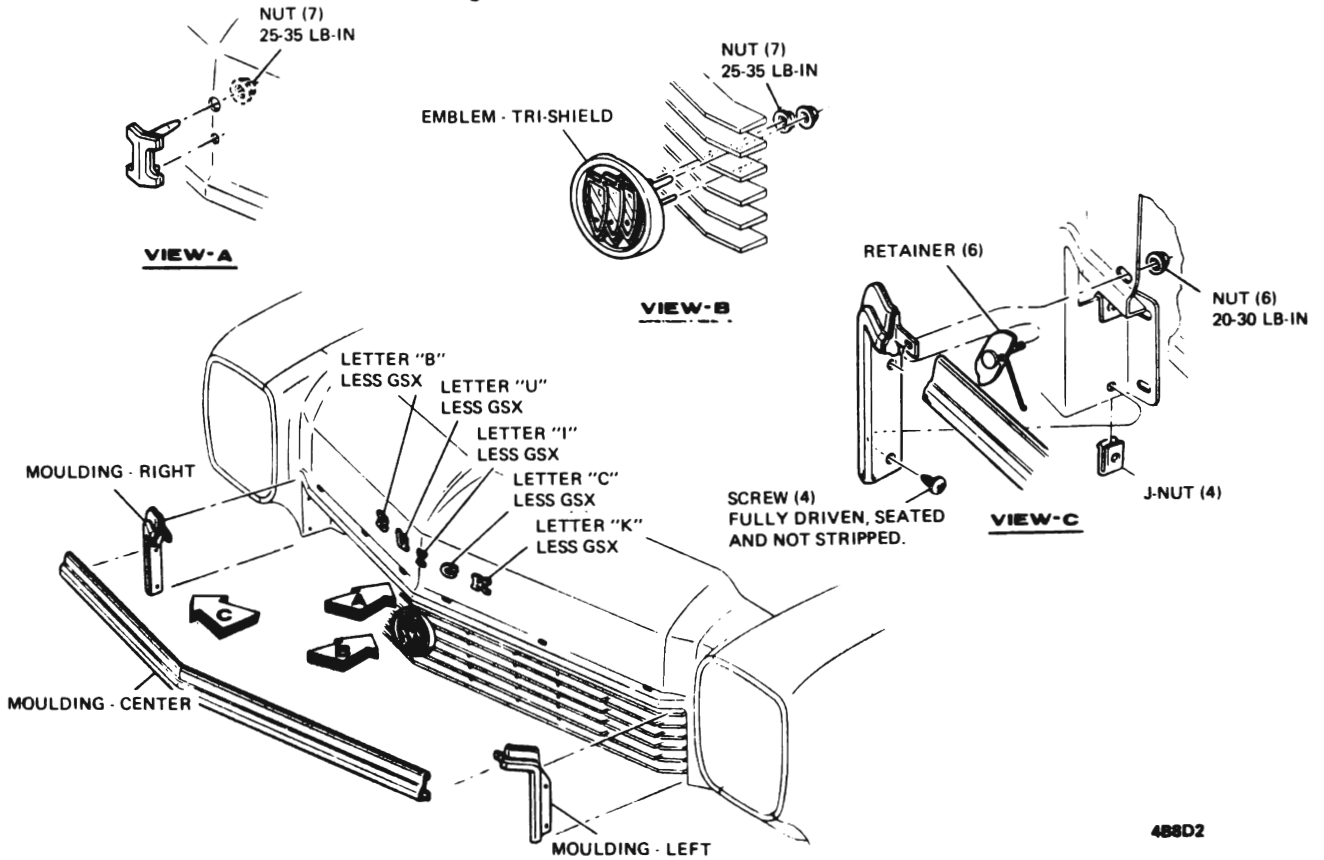

Figure 8D-2 X Series Grille Ornamentation

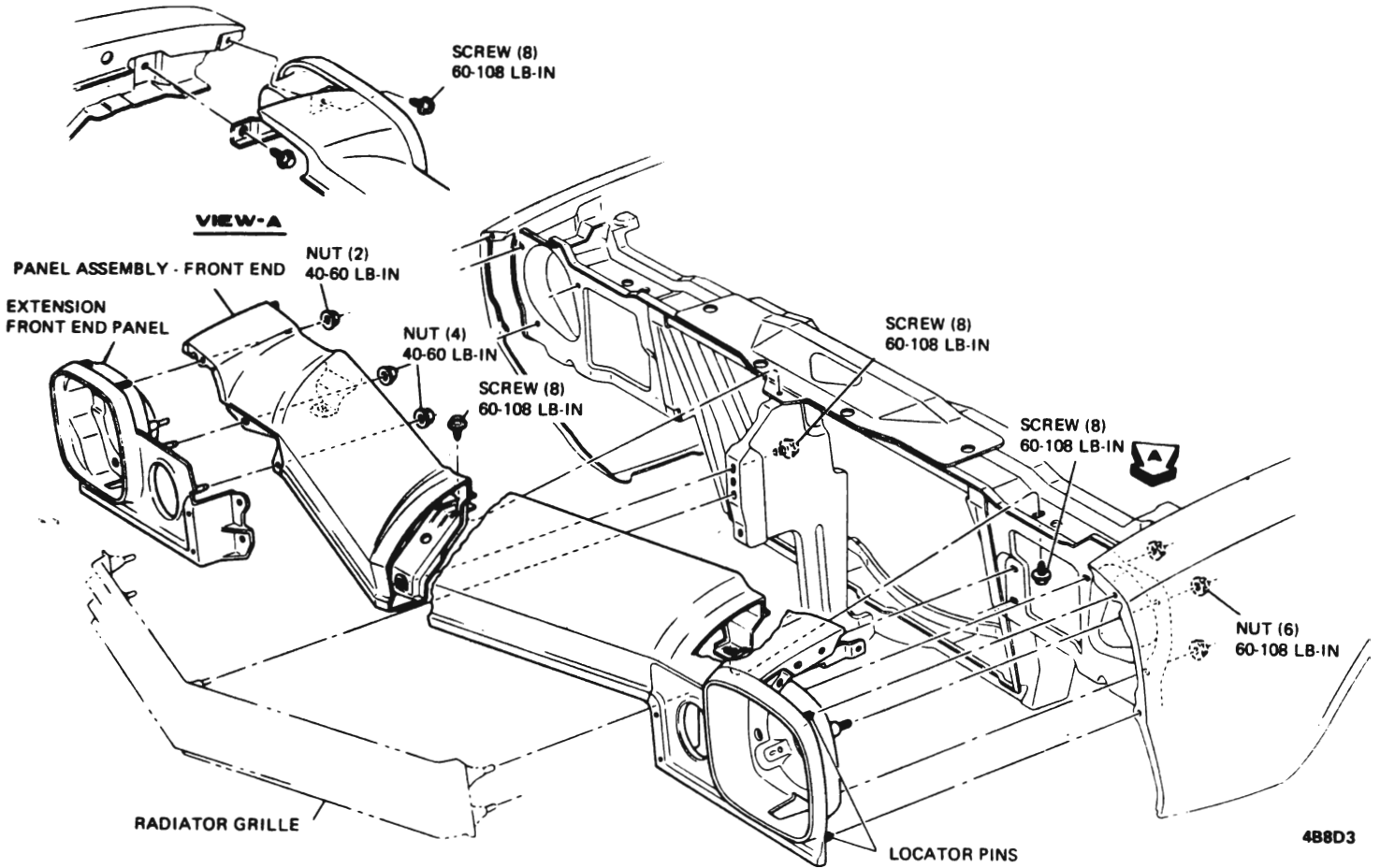

Figure 8D-3 A Series Century Front End Panel Assembly

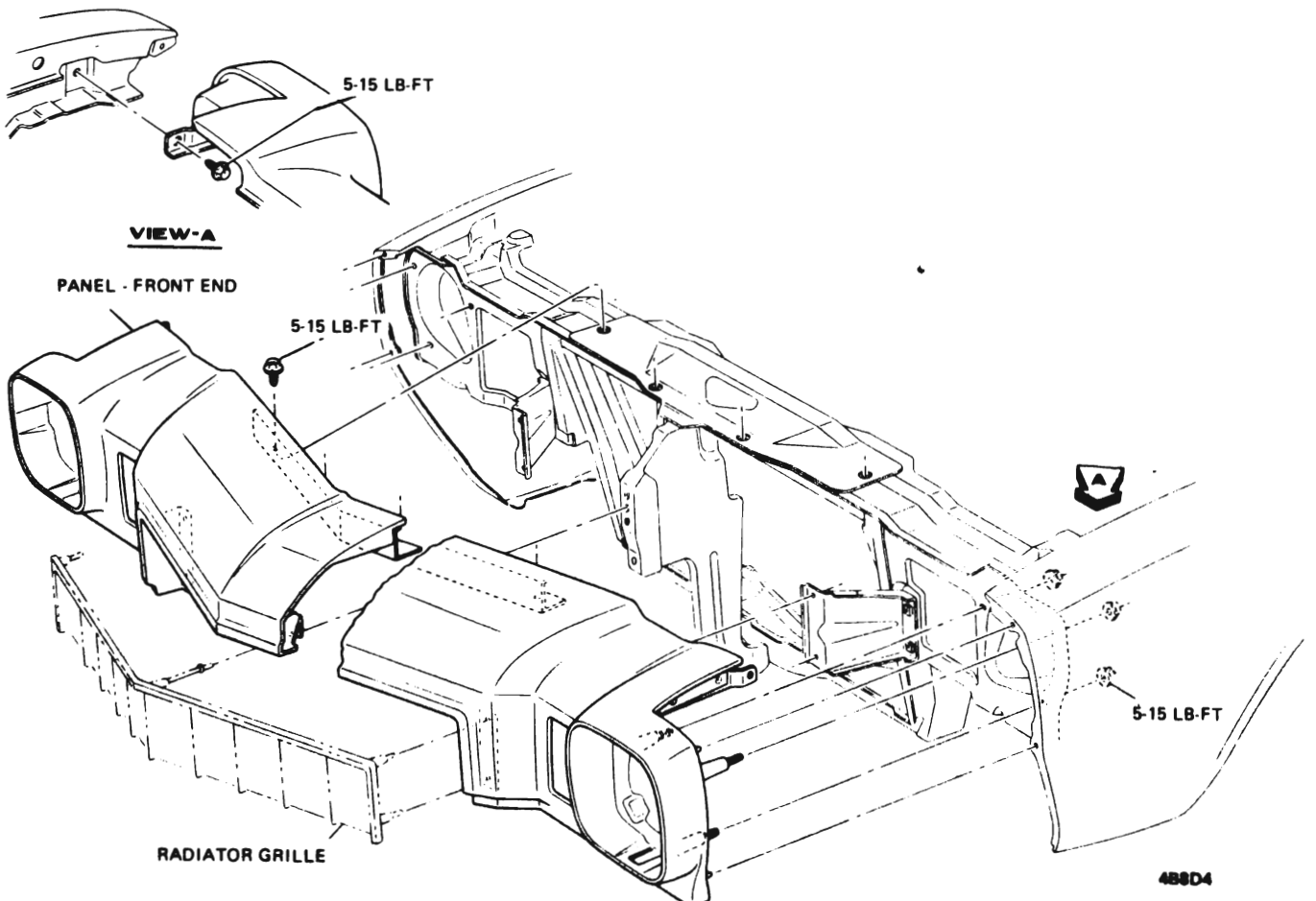

Figure 8D-4 A Series Regal Front End Panel Assembly

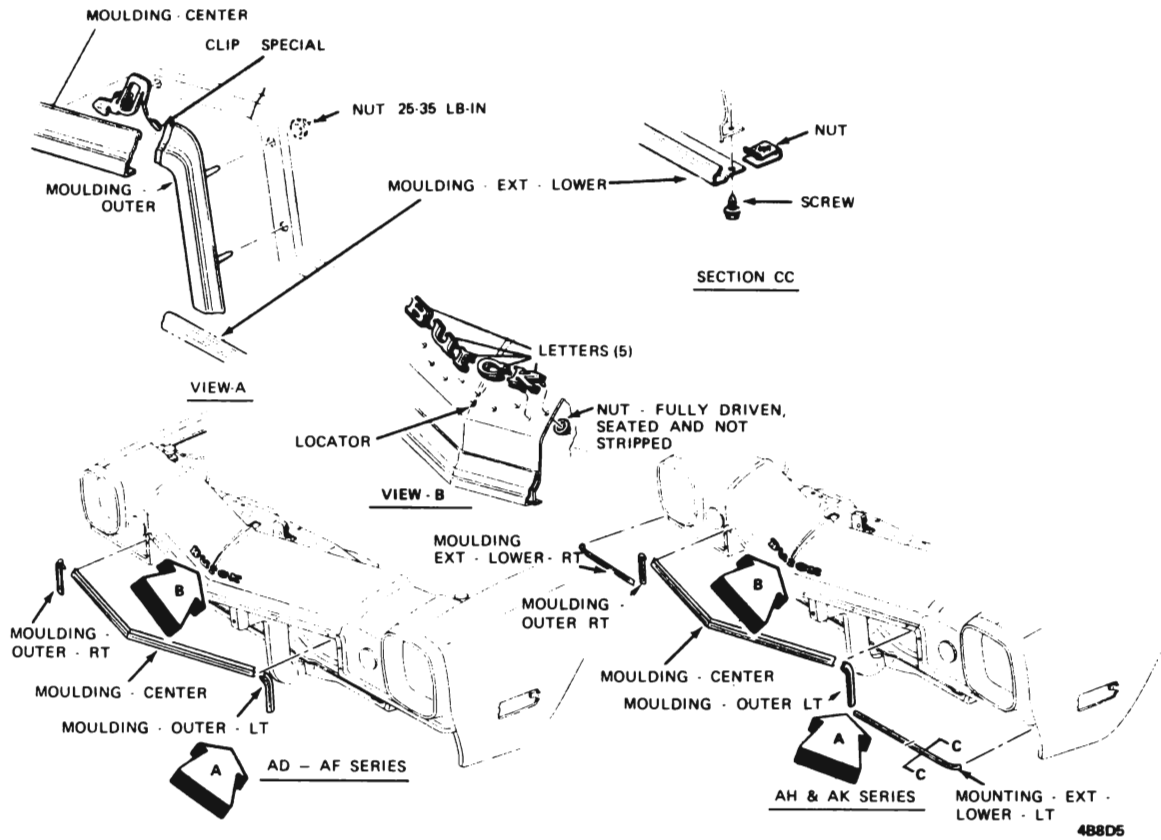

Figure 8D-5 A Series Century Ornamentation

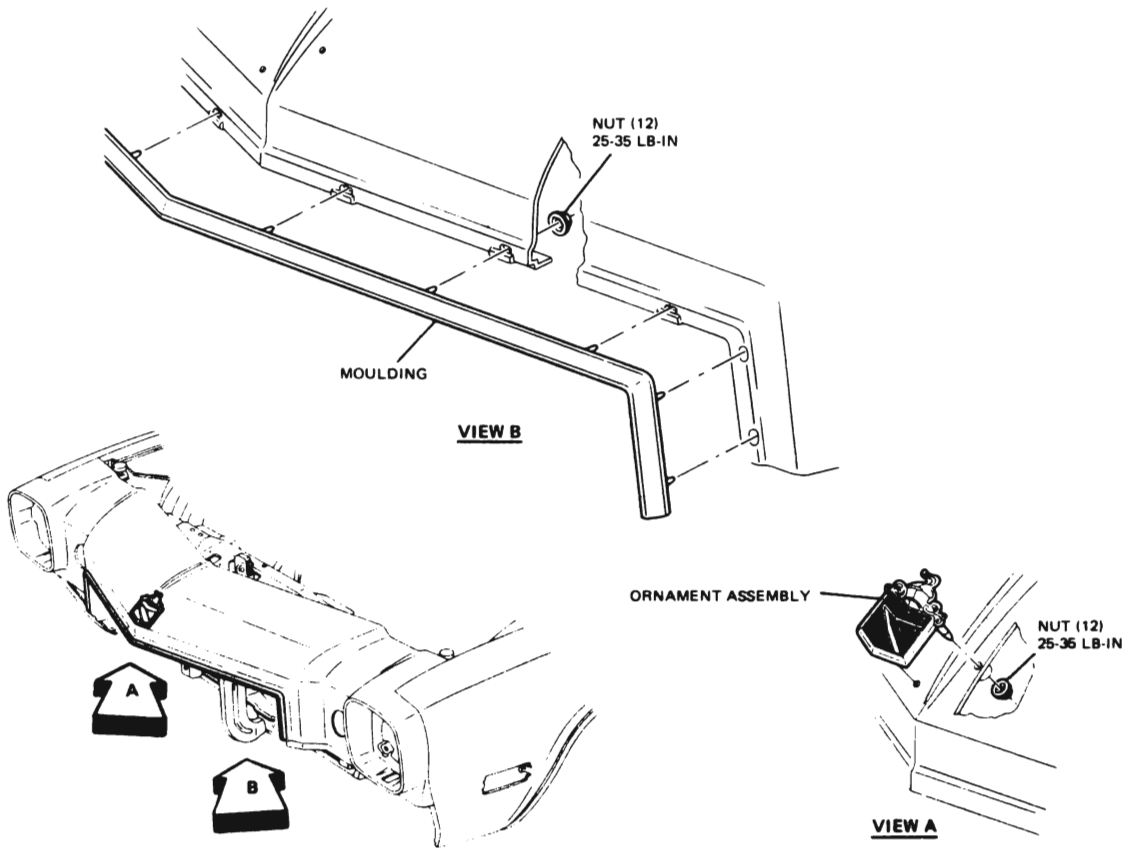

Figure 8D-6 A Series Regal Ornamentation

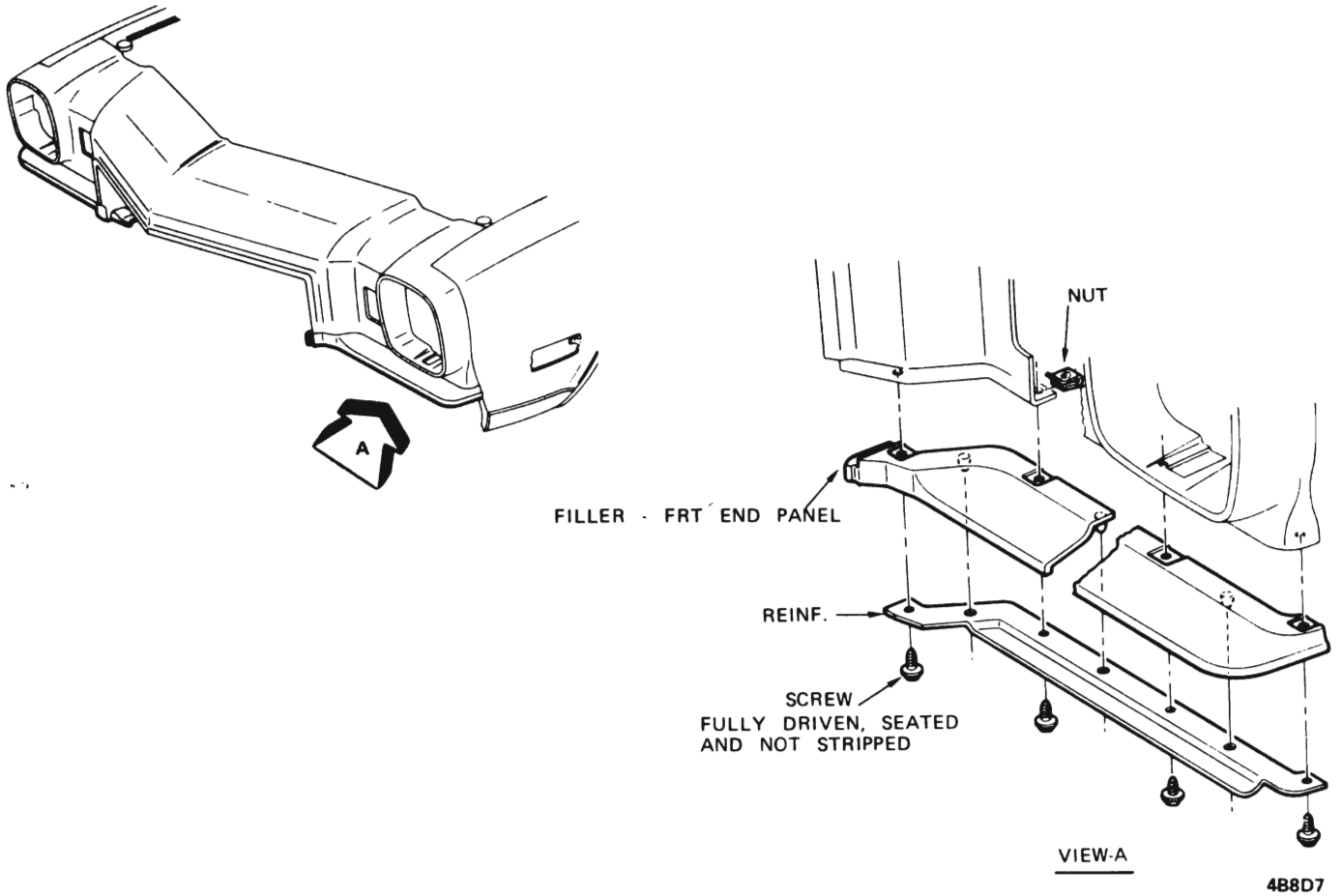

Figure 8D-7 A Series Regal Filler - Front End Panel

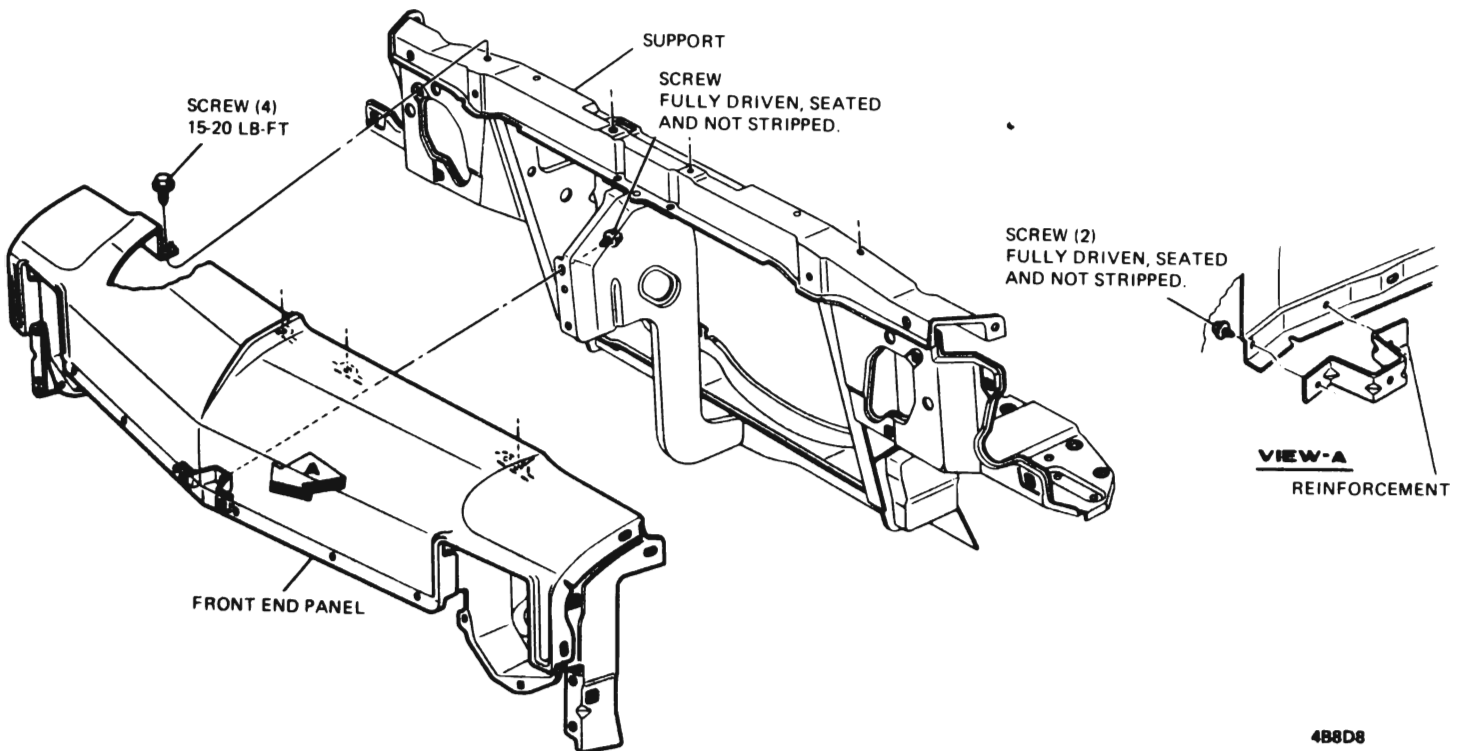

Figure 8D-8 B-C Series Front End Panel to Radiator Support

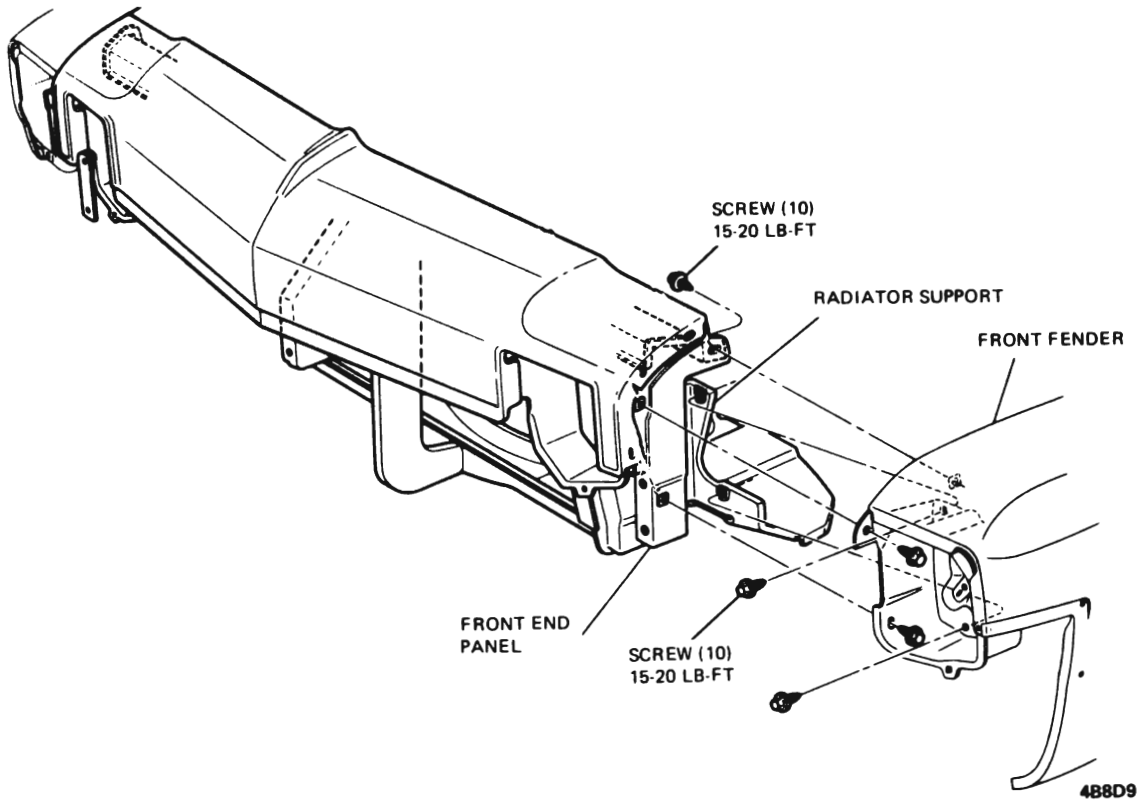

Figure 8D-9 B-C Series Front End Panel to Fender

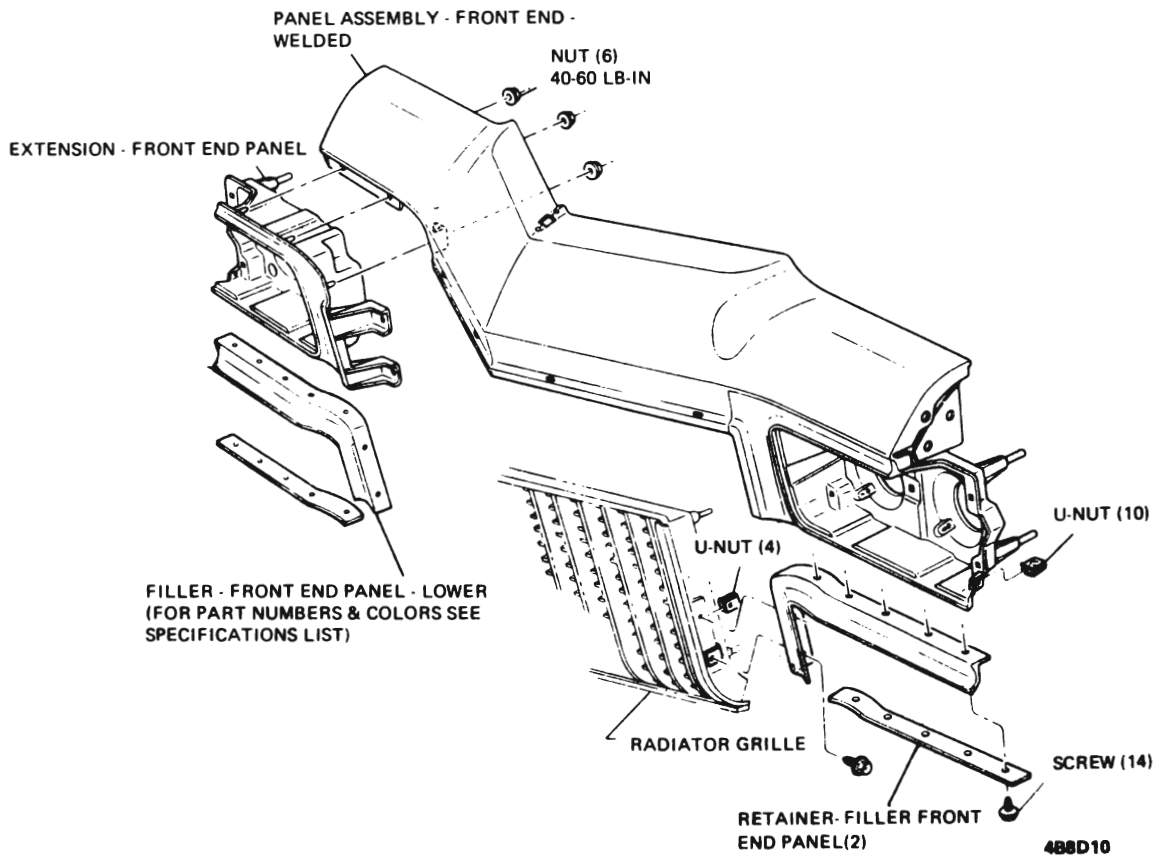

Figure 8D-10 E Series Front End Extension Assembly

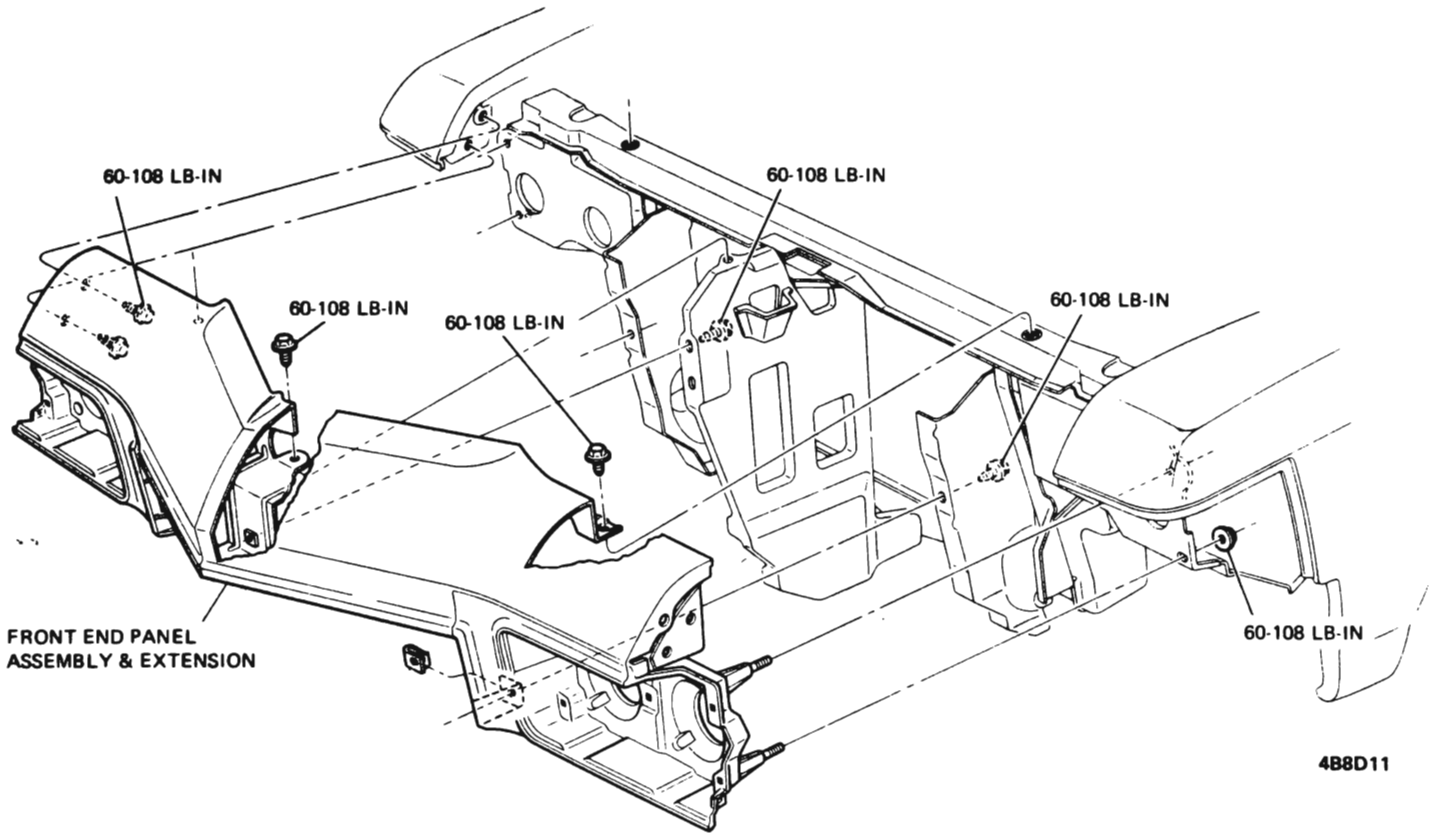

Figure 8D-11 E Series Front End Panel

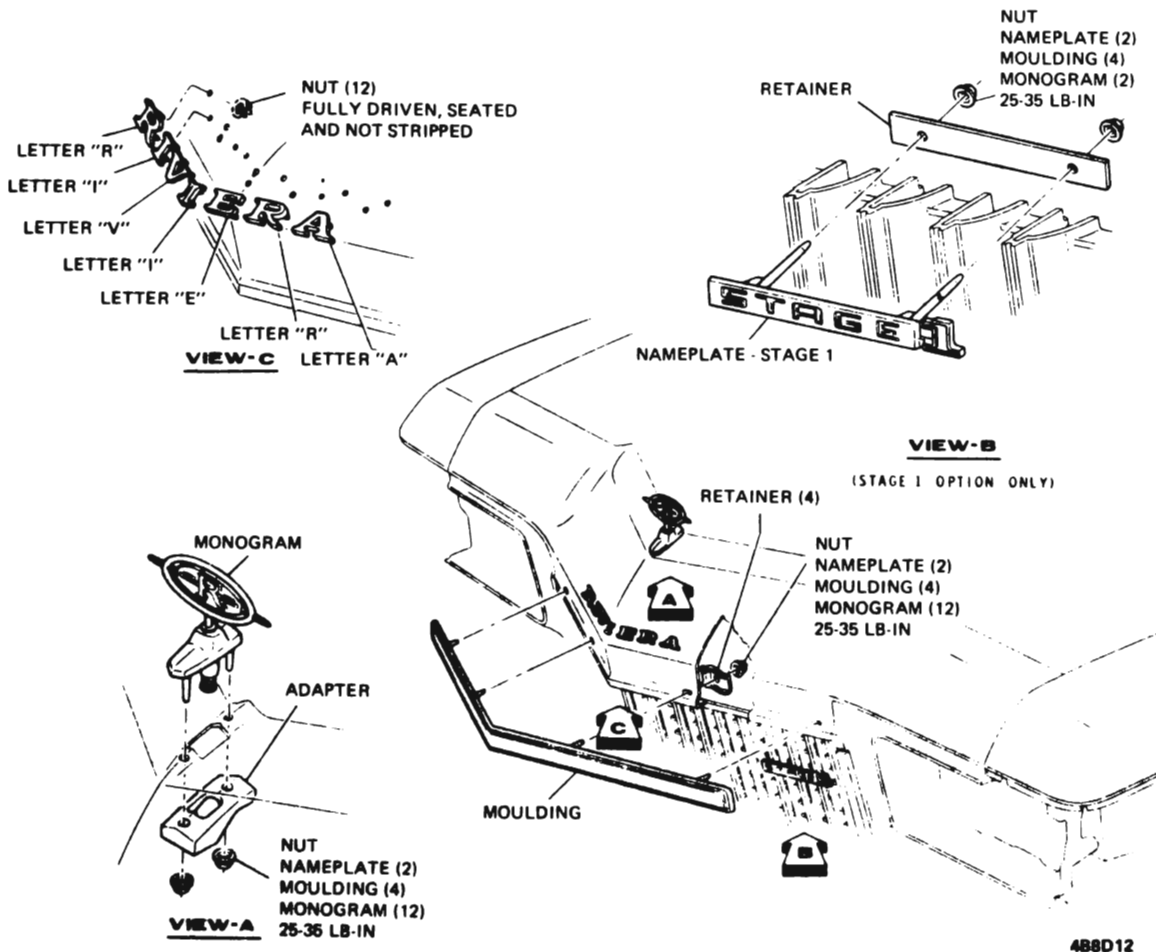

Figure 8D-12 E Series Ornamentation