

SECTION A

SHIFT LINK ADJUSTMENTS ALL SERIES

CONTENTS

Division	Subject	Paragraph
I	SPECIFICATIONS AND ADJUSTMENTS:	
	Turbo Hydra-Matic 350 & 400 Transmission Shift Linkage Adjustment (Console Shift) All Series	73-1
	Turbo Hydra-Matic 350 & 400 Transmission Shift Linkage Adjustment (Column Shift) All Series	73-2
	3 Speed Manual Transmission Shift Linkage Adjustment 43-44000 Series (Column Shift)	73-3
	3 Speed Manual Transmission Shift Linkage Adjustment 45-46000 Series (Column Shift)	73-4
	3 Speed Manual Transmission Shift Linkage Adjustment G.S. & G.S. 455 (Floor Shift Only)	73-5
	4 Speed Manual Transmission Shift Linkage Adjustment G.S. & G.S. 455 (Floor Shift)	73-6

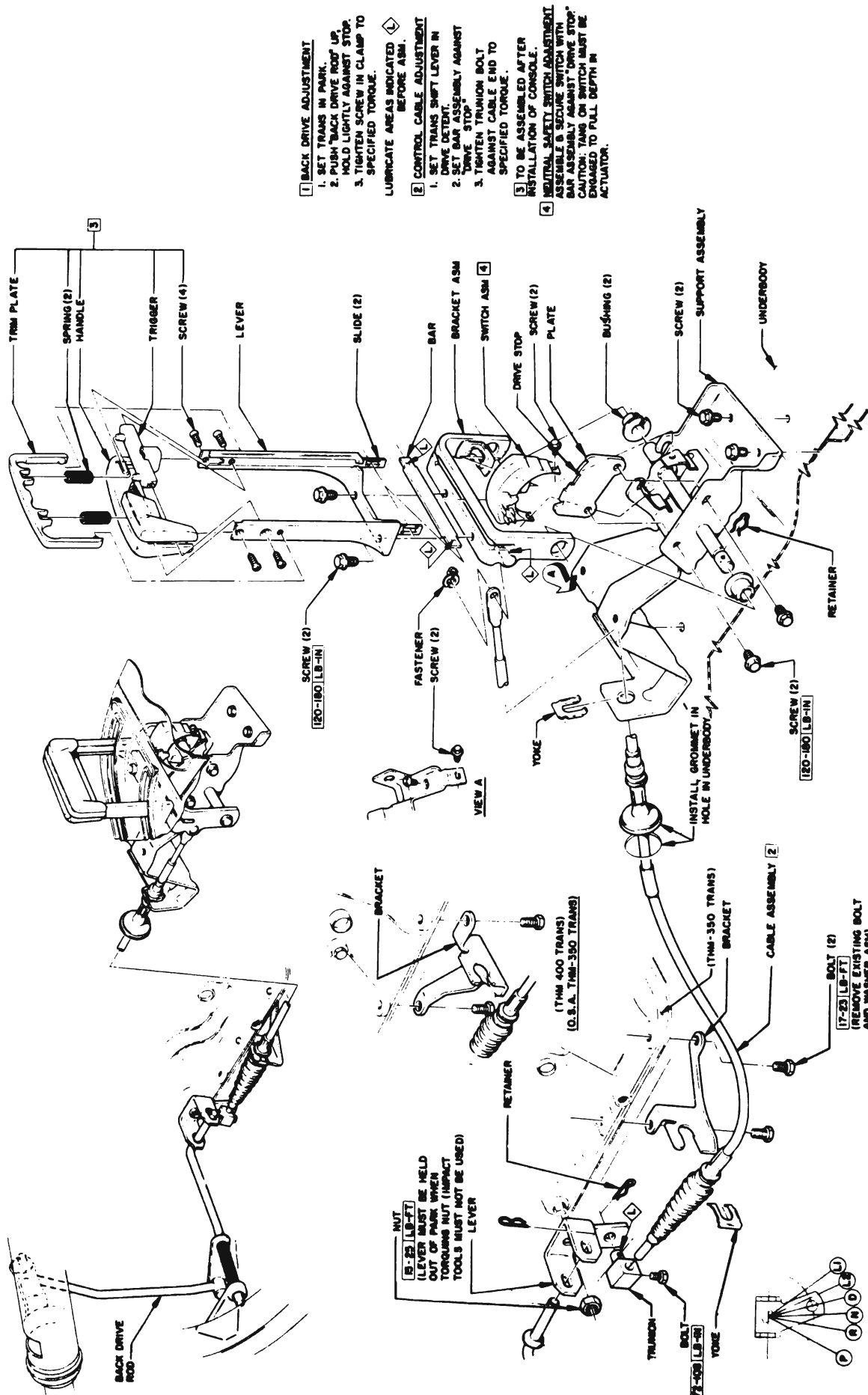

- 1 BACK DRIVE ADJUSTMENT**
1. SET TRANS IN PARK.
 2. PUSH "BACK DRIVE ROD" UP.
 3. HOLD LIGHTLY AGAINST STOP.
 3. TIGHTEN SCREW IN CLAMP TO SPECIFIED TORQUE.
- LUBRICATE AREAS INDICATED BY DIAMOND BEFORE ASM.
- 2 CONTROL CABLE ADJUSTMENT**
1. SET TRANS SHIFT LEVER IN DRIVE DETENT.
 2. SET BAR ASSEMBLY AGAINST "DRIVE STOP".
 3. TIGHTEN TRUNION BOLT AGAINST CABLE END TO SPECIFIED TORQUE.
- 3 TO BE ASSEMBLED AFTER INSTALLATION OF CONSOLE.**
- 4 NEUTRAL SAFETY SWITCH ADJUSTMENT**
- ASSEMBLE & SECURE SWITCH WITH BAR ASSEMBLY AGAINST "DRIVE STOP".
- CAUTION: TANG ON SWITCH MUST BE ENGAGED TO FULL DEPTH IN ACTUATOR.

Figure 73-3 43-44-45 And 46000 Series

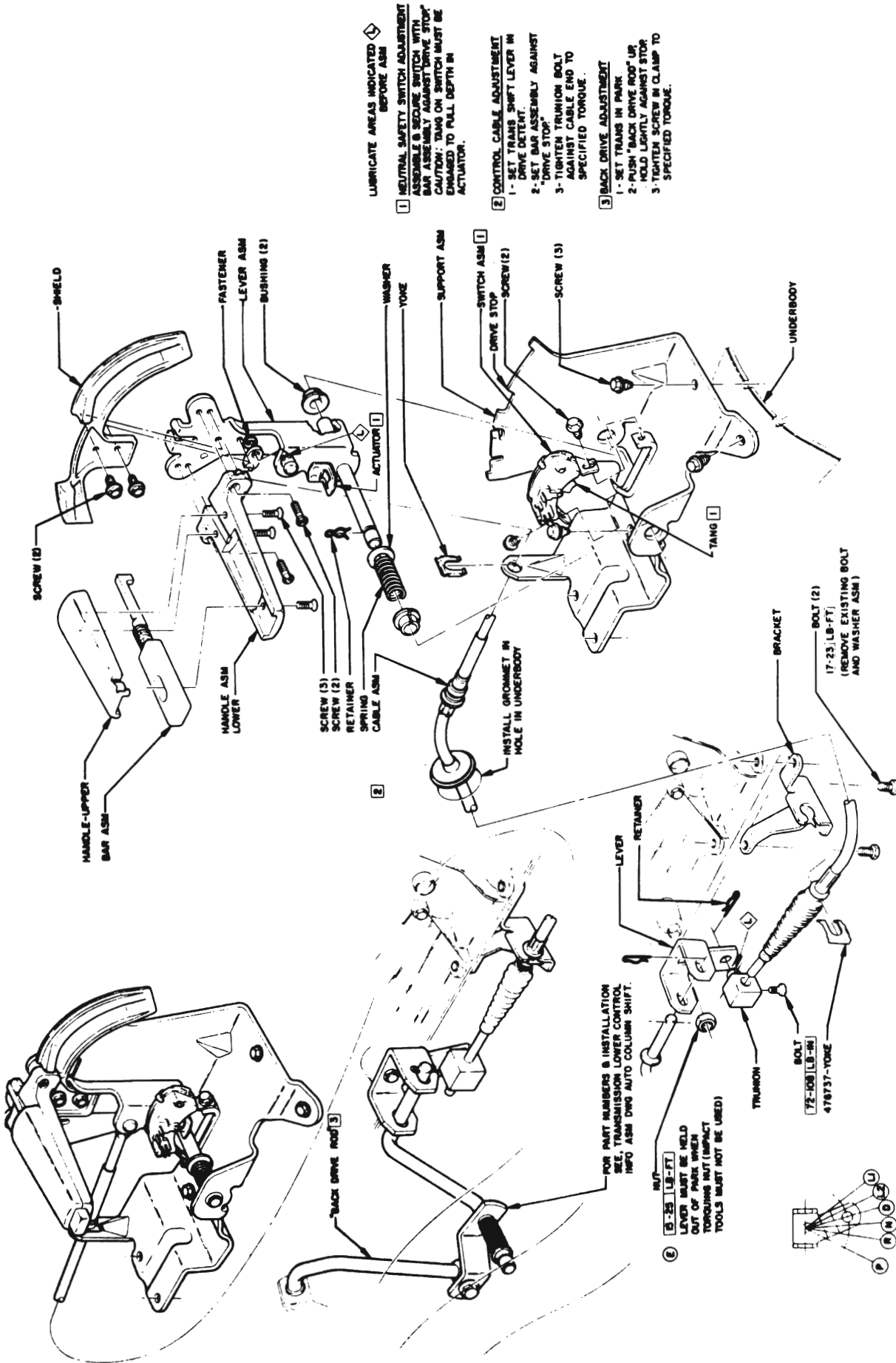

Figure 73-4 49000 Series

73-2 350 AND 400 TURBO HYDRA-MATIC TRANSMISSION LINKAGE ADJUSTMENT (Column Shift) ALL SERIES

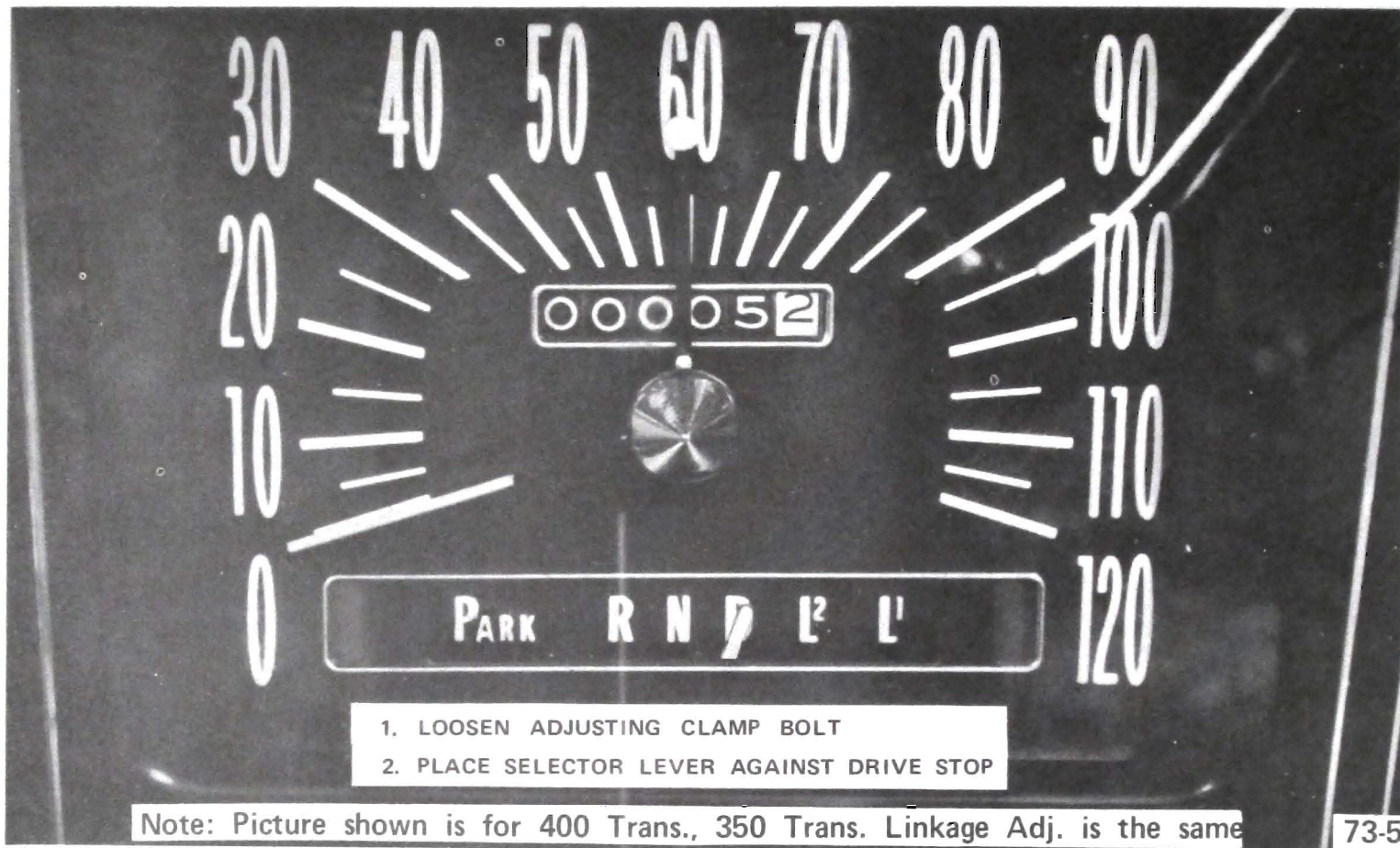

Figure 73-5

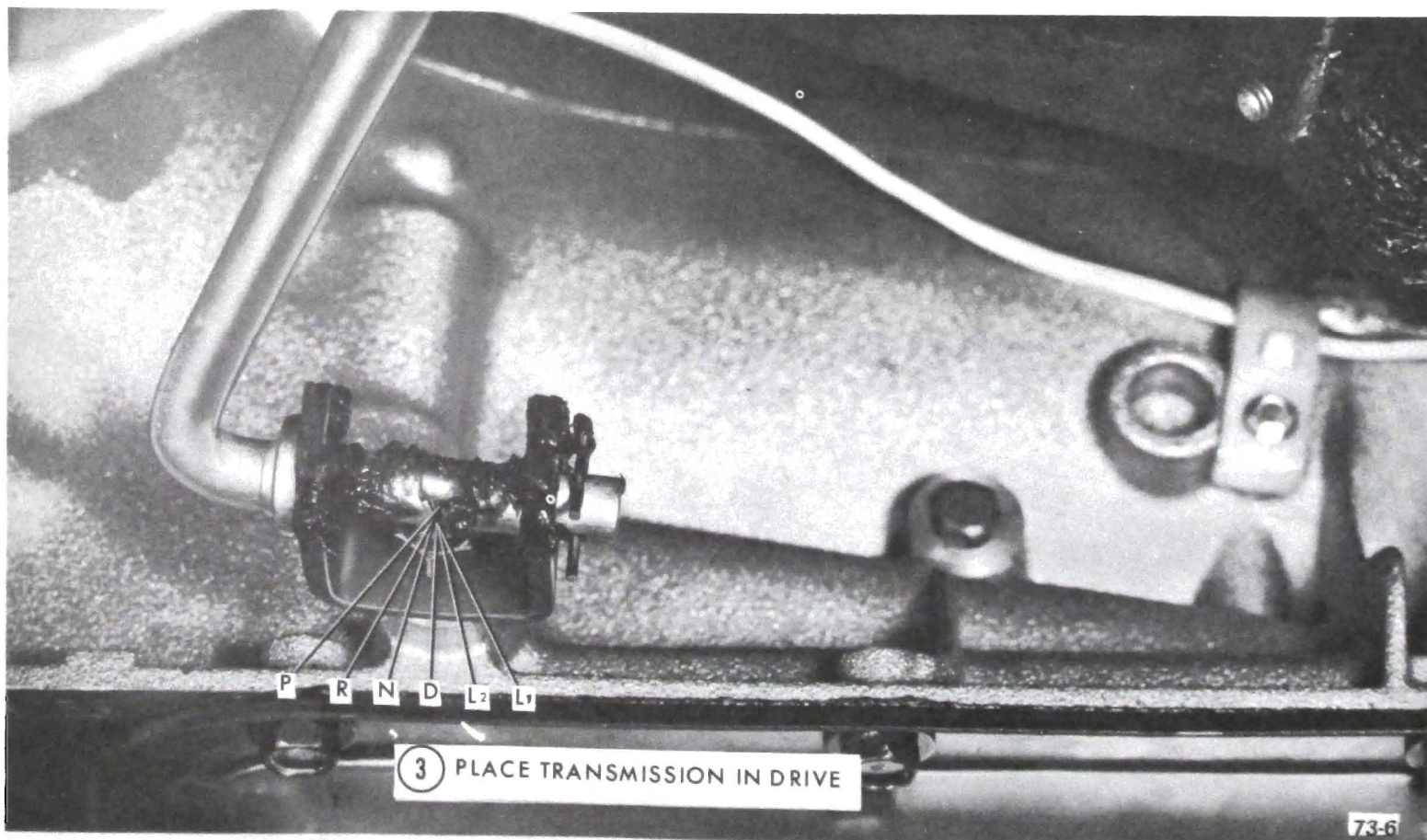

Figure 73-6

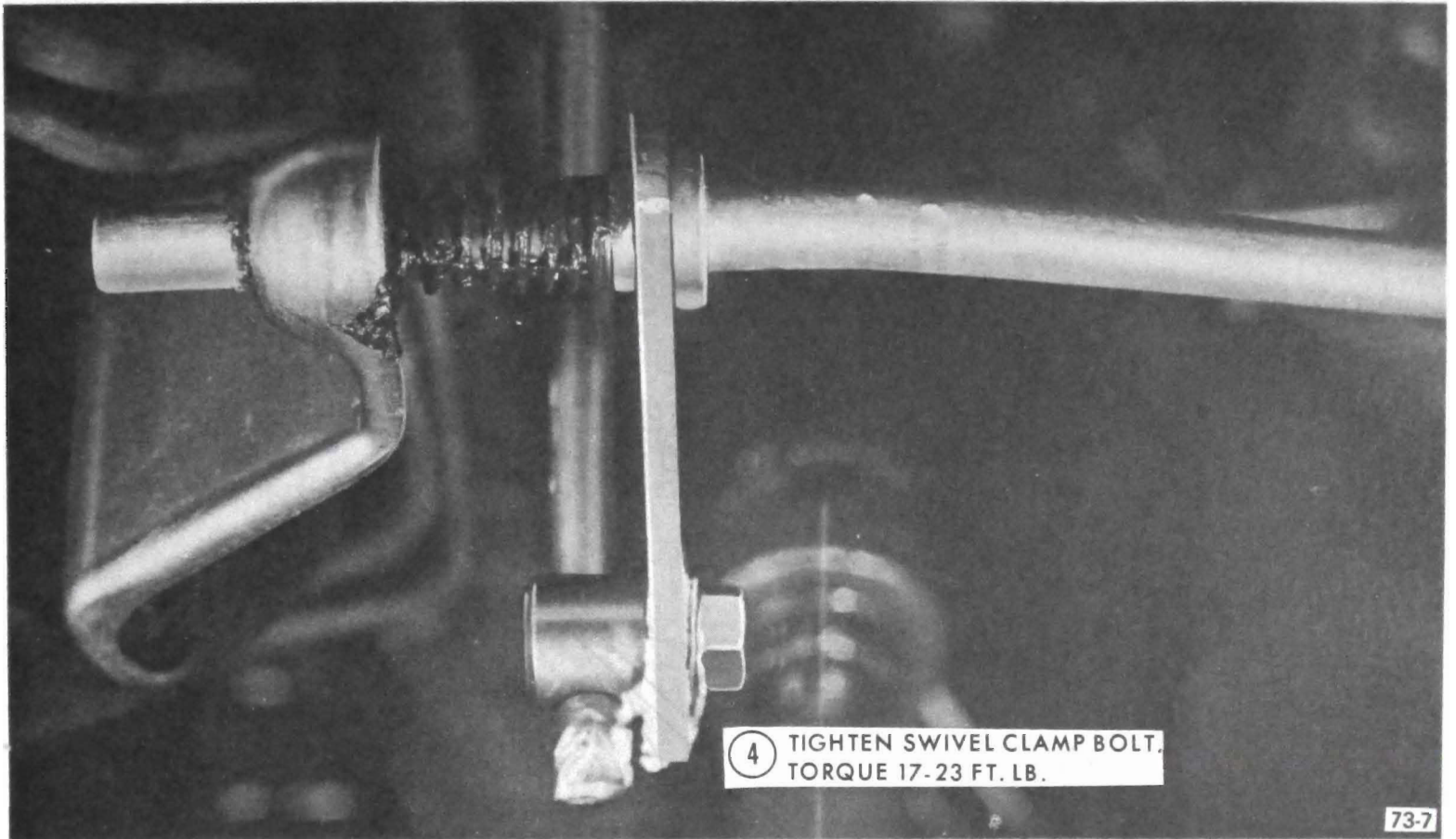
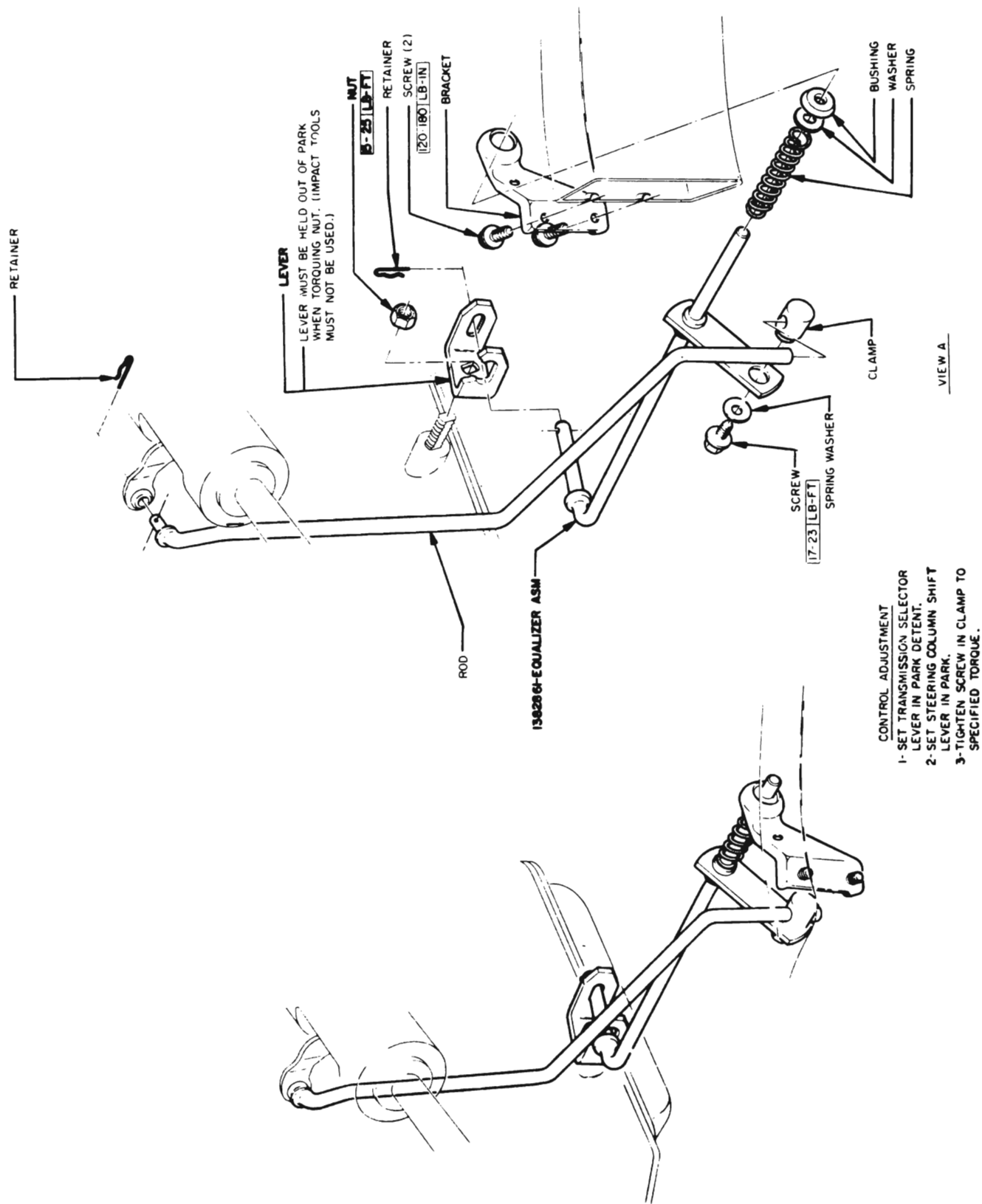
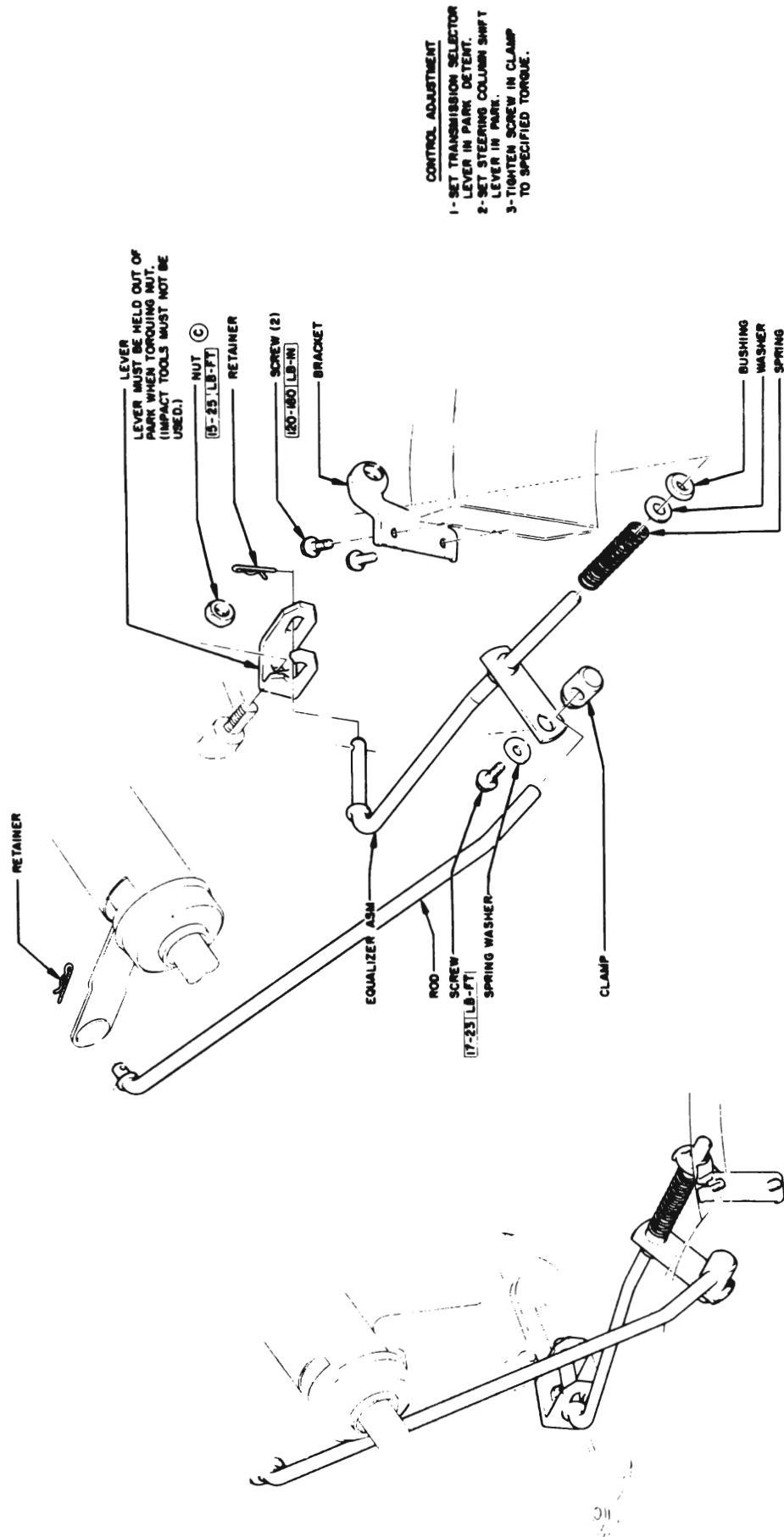

Figure 73-7



73-8

Figure 73-8 43-44000 Series



73-9

Figure 73-9 45-46000 Series

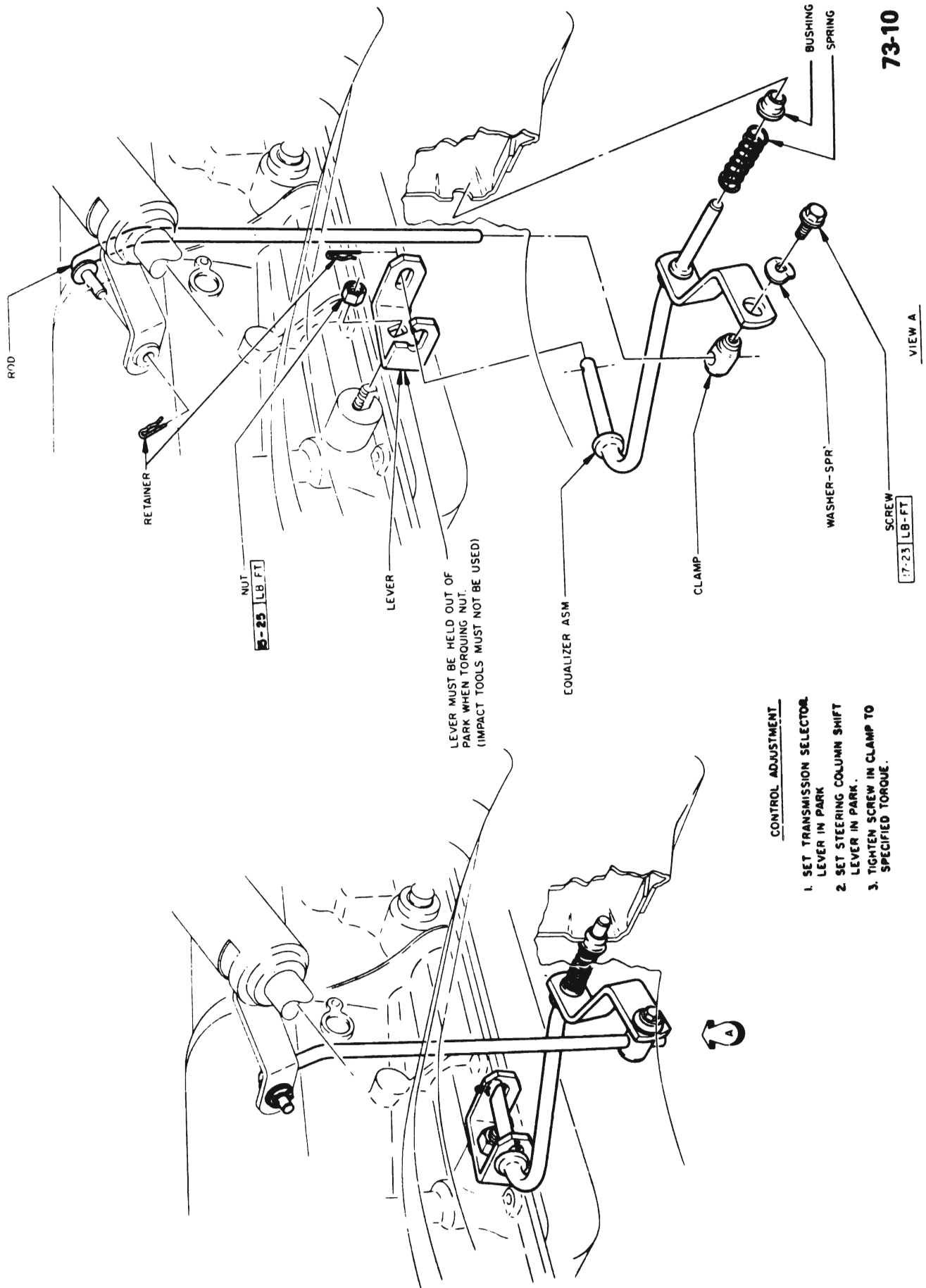

73-10

Figure 73-10 49000 Series

73-3 3-SPEED MANUAL TRANSMISSION LINKAGE ADJUSTMENT 43-44000 SERIES

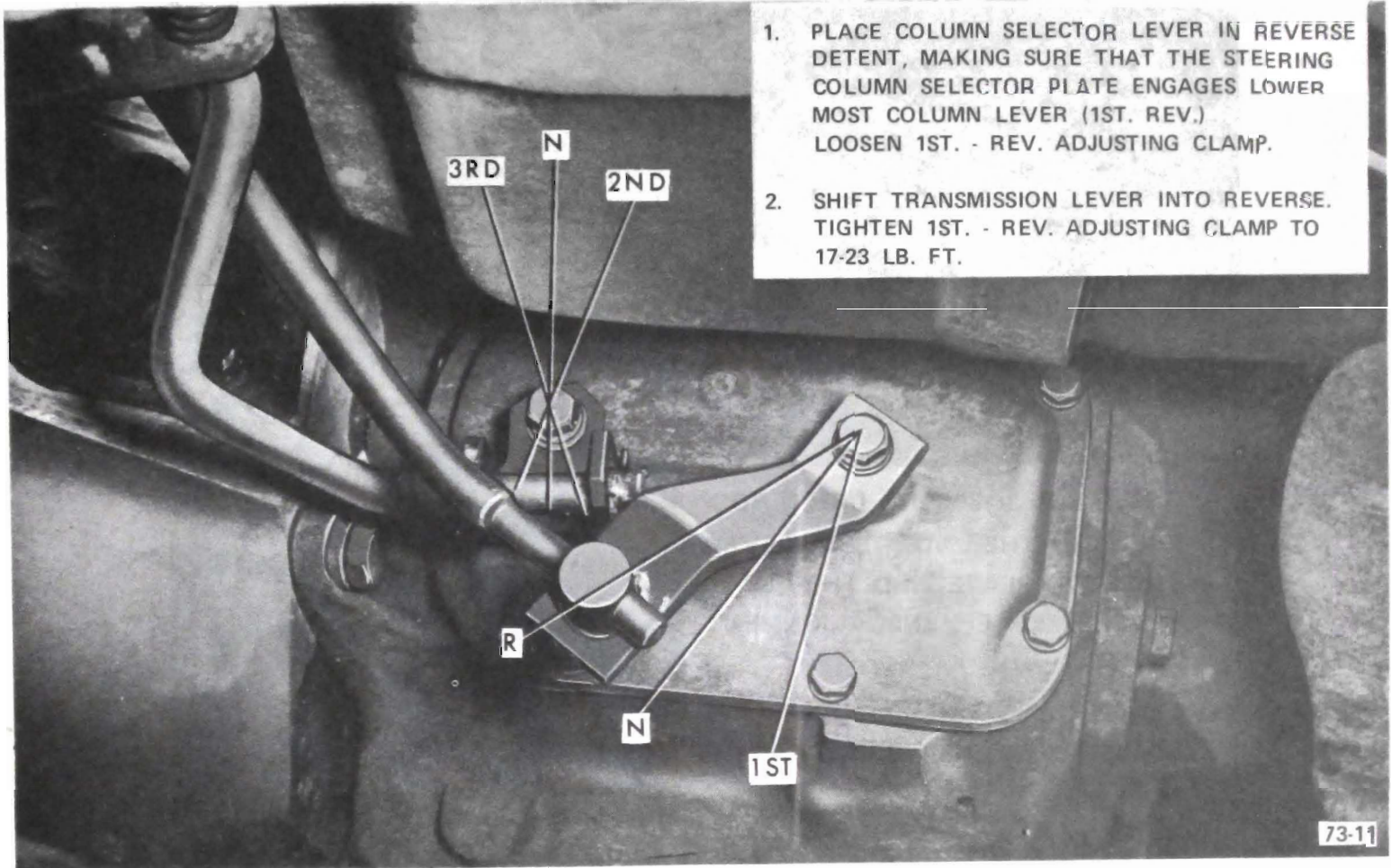

Figure 73-11

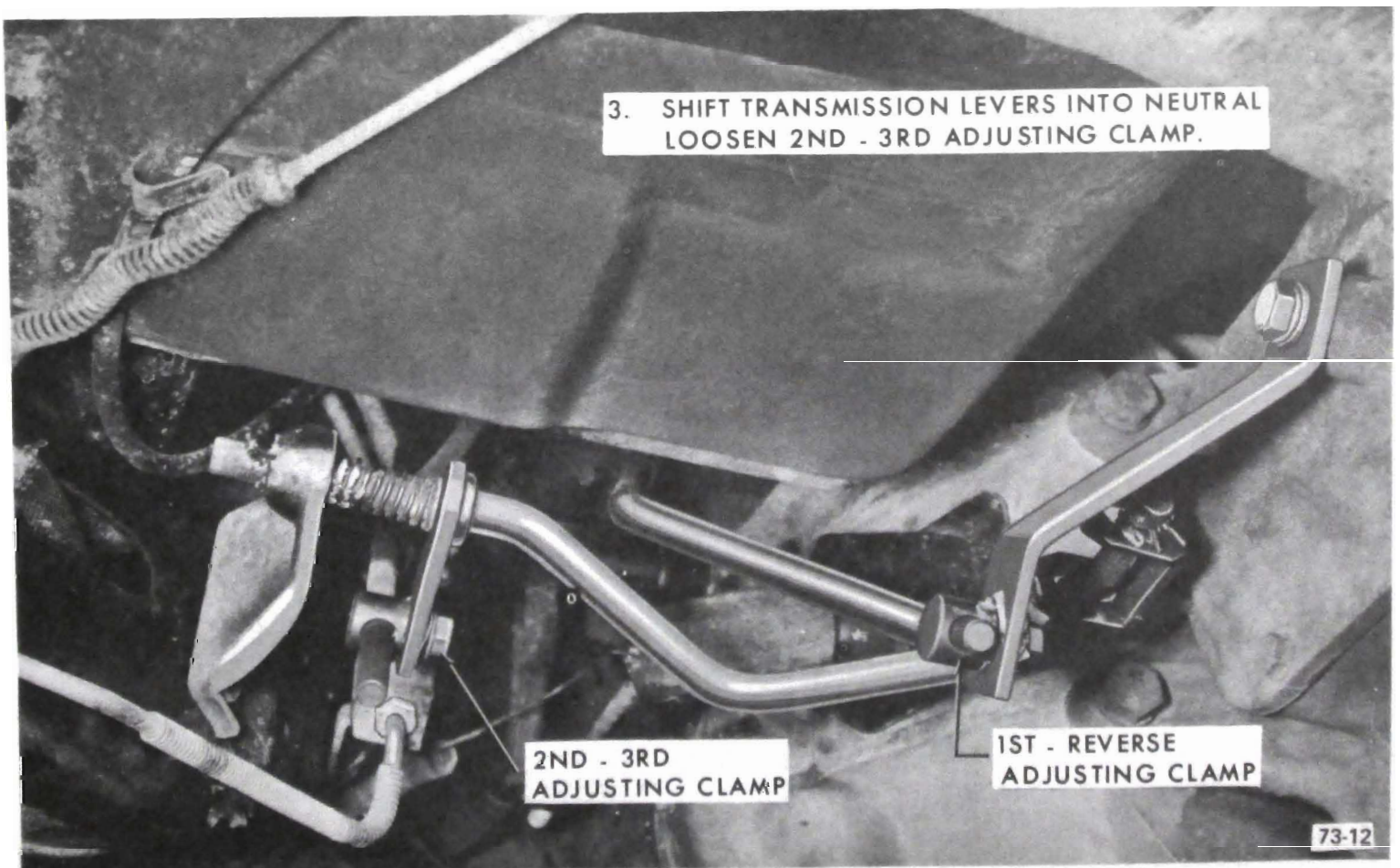

Figure 73-12

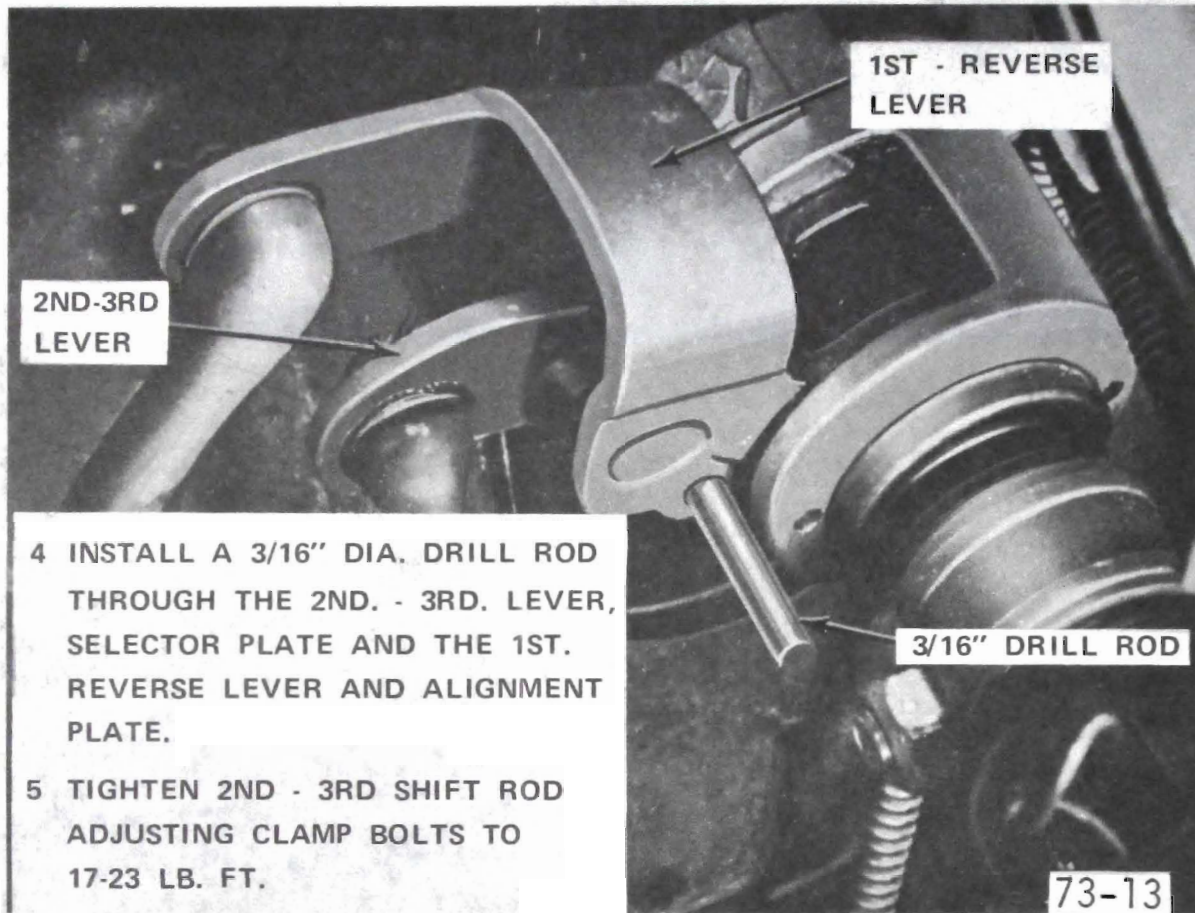
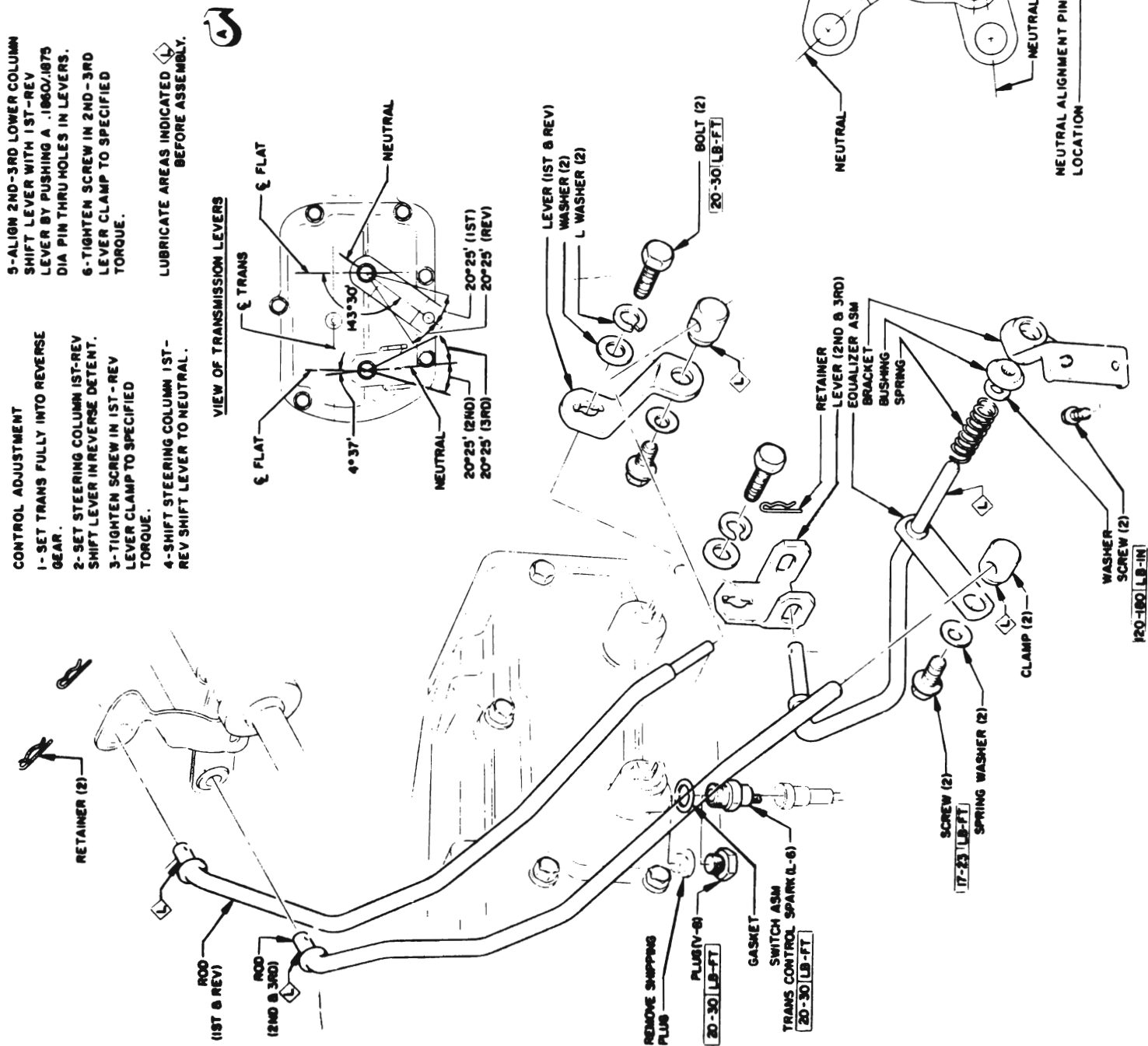

Figure 73-13



73-14

Figure 73-14 43-44000 Series

73-14 SHIFT LINKAGE ADJUSTMENTS - ALL SERIES

73-4 3-SPEED MANUAL TRANSMISSION LINKAGE ADJUSTMENT 45-46000 SERIES

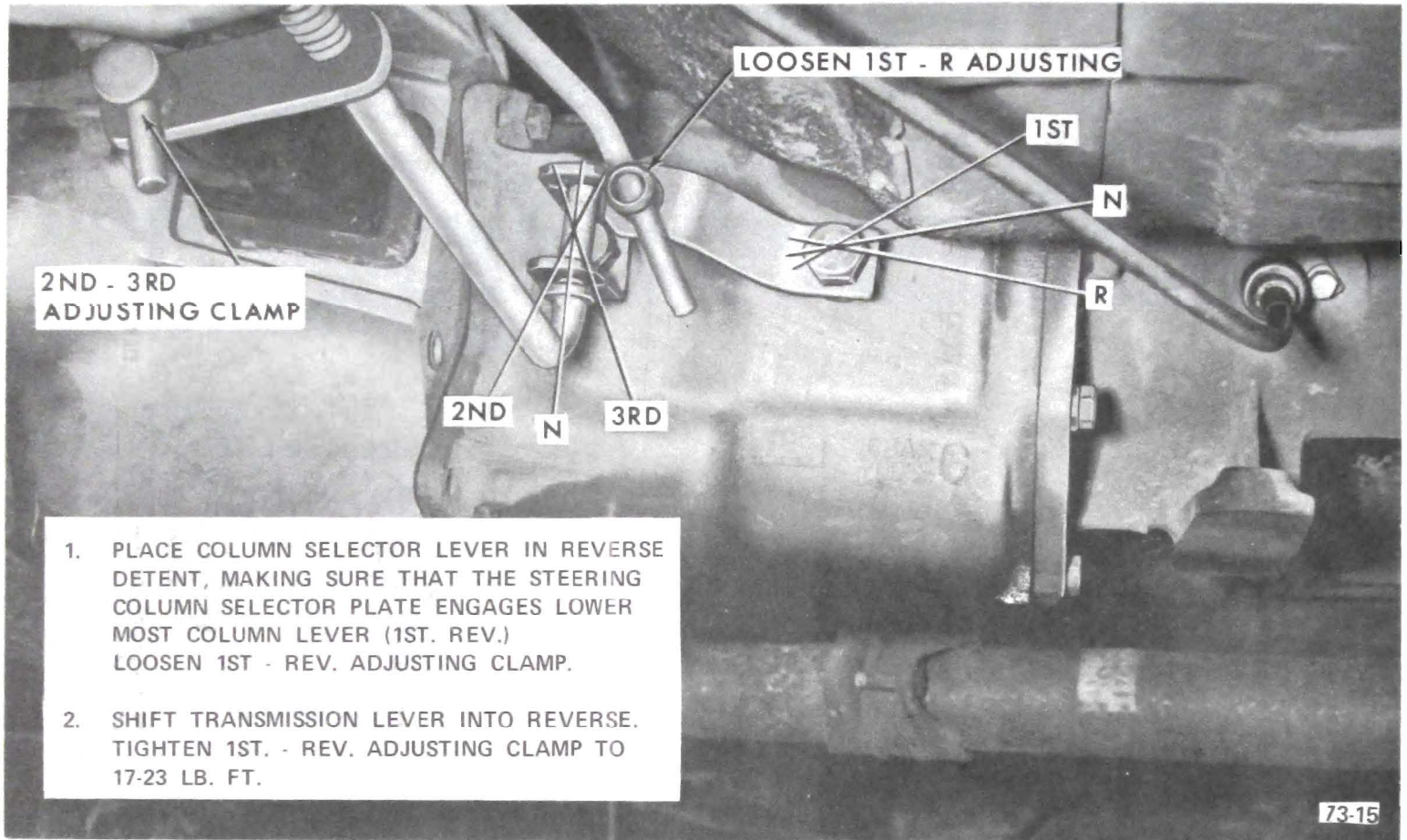

Figure 73-15

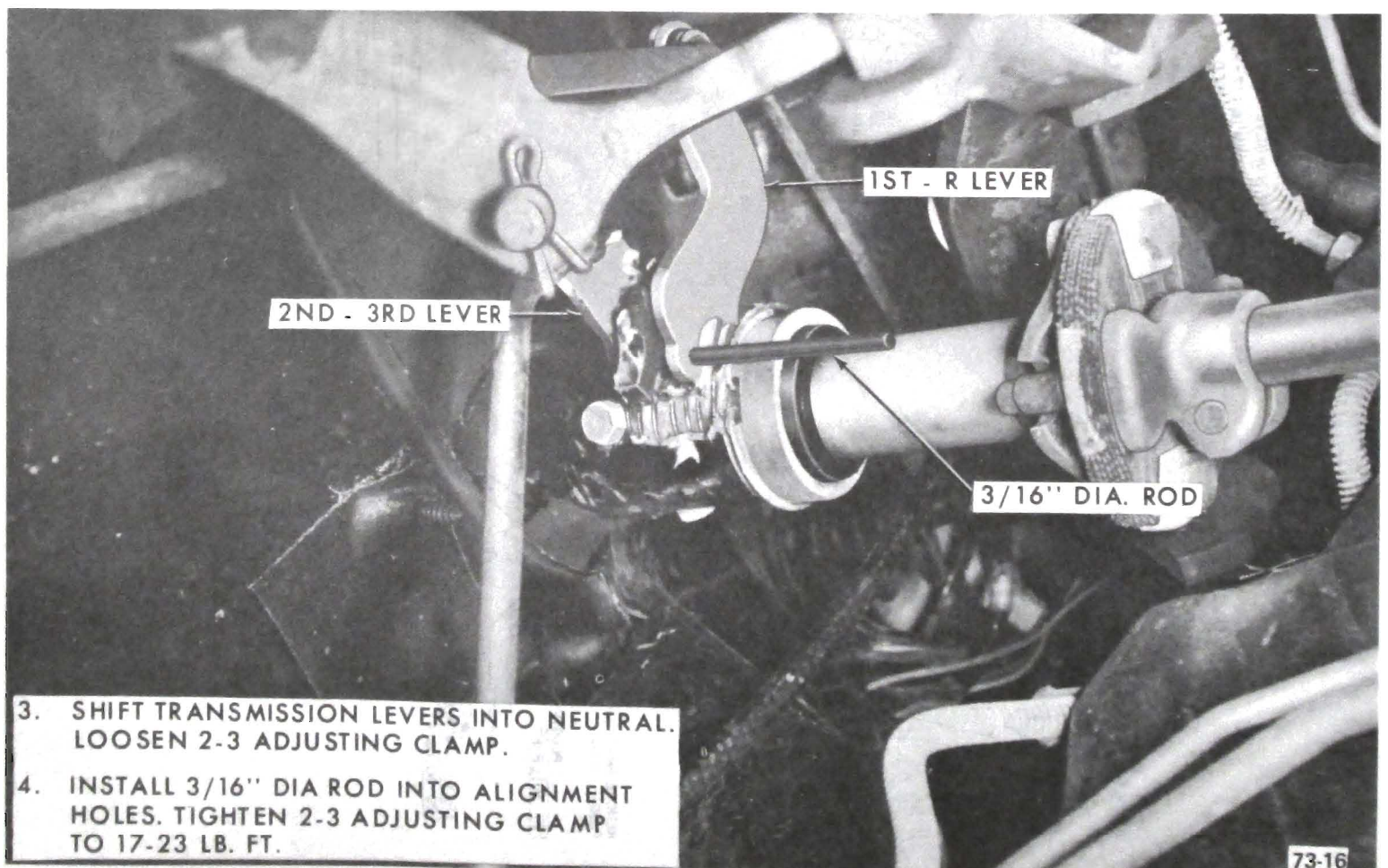
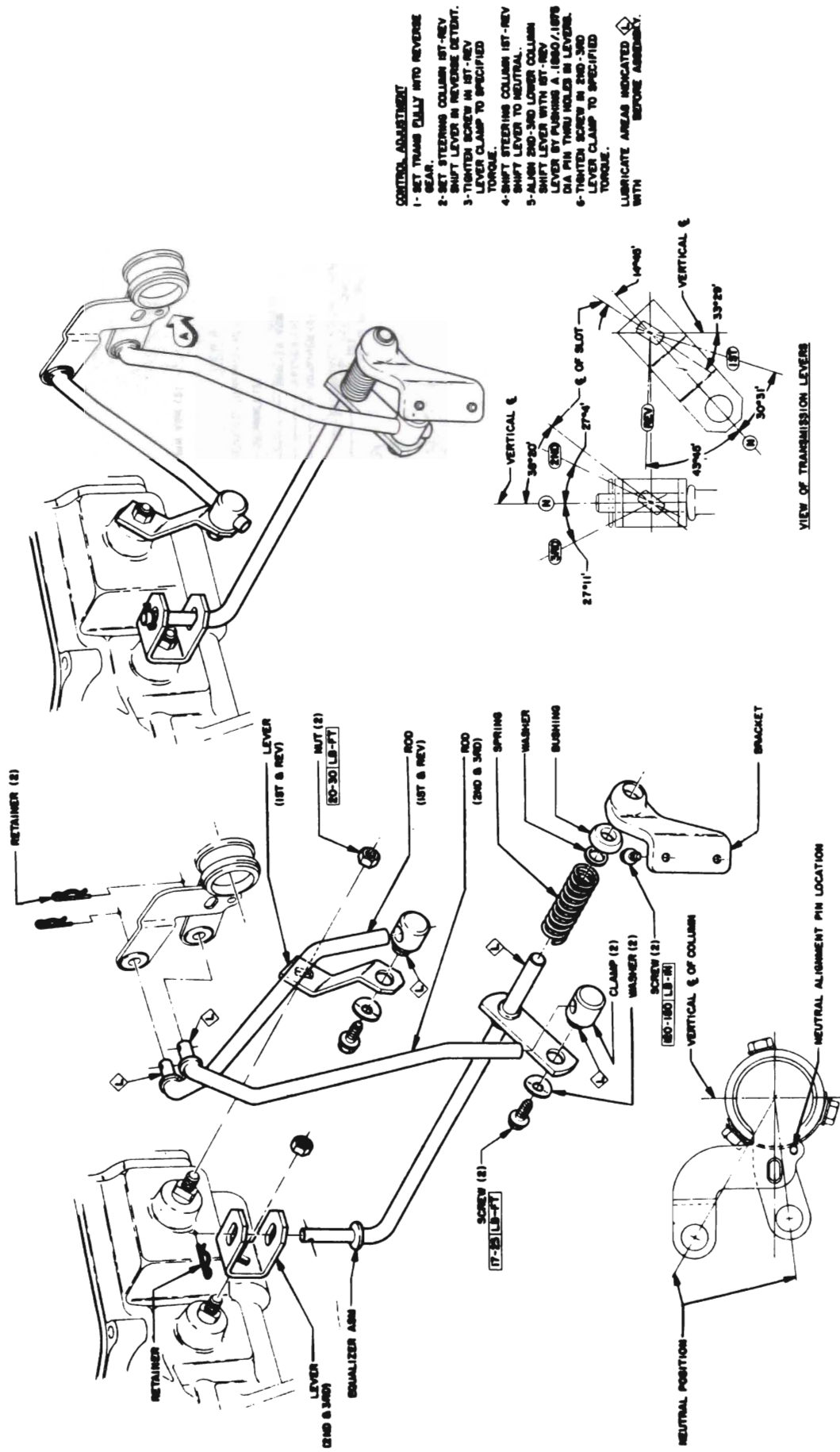

Figure 73-16



- CONTROL ADJUSTMENT**
- 1- SET TRANS FULLY INTO REVERSE GEAR.
 - 2- SET STEERING COLUMN 1ST-REV SHIFT LEVER IN REVERSE DETENT.
 - 3- TIGHTEN SCREW IN 1ST-REV LEVER CLAMP TO SPECIFIED TORQUE.
 - 4- SHIFT STEERING COLUMN 1ST-REV SHIFT LEVER TO NEUTRAL.
 - 5- ALIGN 2ND-3RD LOWER COLUMN SHIFT LEVER WITH 1ST-REV LEVER BY TURNING A 1/8RD/LIGHT DIA PIN THRU HOLE IN LEVER.
 - 6- TIGHTEN SCREW IN 2ND-3RD LEVER CLAMP TO SPECIFIED TORQUE.
- LUBRICATE AREAS INDICATED WITH BEFORE ASSEMBLY.

73-17

VIEW OF TRANSMISSION LEVERS

VIEW A

Figure 73-17 45-46000 Series

73-16 SHIFT LINKAGE ADJUSTMENTS - ALL SERIES

73-5 3-SPEED MANUAL TRANSMISSION LINKAGE ADJUSTMENT G.S. AND G.S. 455 (Floor Shift)

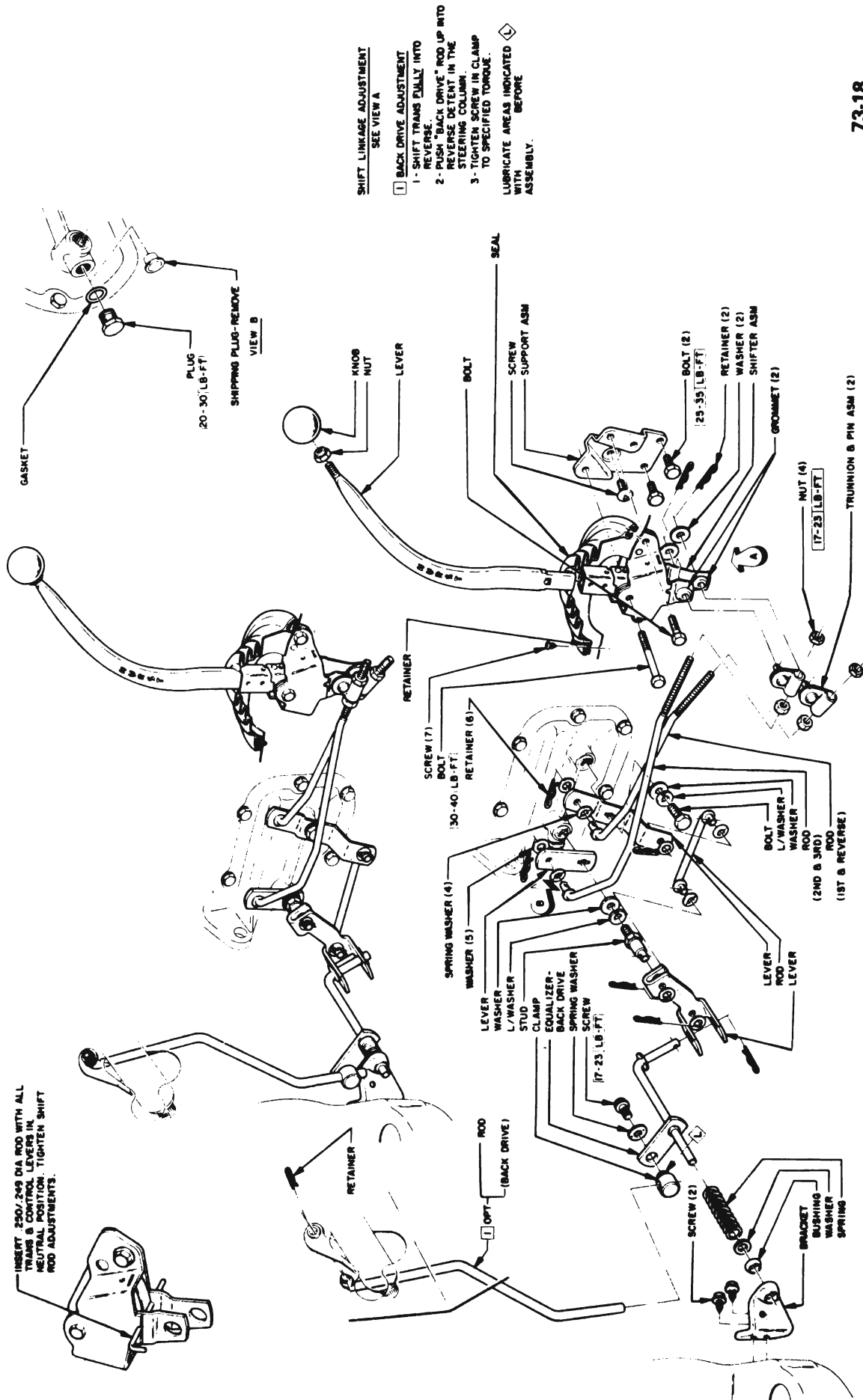

INSERT .250/249 DIA ROD WITH ALL TRANS & CONTROL LEVERS IN NEUTRAL POSITION. TIGHTEN SHIFT ROD ADJUSTMENTS.

- SHIFT LINKAGE ADJUSTMENT**
SEE VIEW A
- **BACK DRIVE ADJUSTMENT**
 - 1- SHIFT TRANS FULLY INTO REVERSE
 - 2- PUSH "BACK DRIVE" ROD UP INTO REVERSE DETENT IN THE STEERING COLUMN
 - 3- TIGHTEN SCREW IN CLAMP TO SPECIFIED TORQUE.
- ◊ LUBRICATE AREAS INDICATED BEFORE ASSEMBLY.

73-18

Figure 73-18 43-44000 Series

