

SECTION C

49000 RADIATOR AND GRILLE

CONTENTS

Division	Subject	Paragraph
I	SPECIFICATIONS AND ADJUSTMENTS: Radiator Mounting	130-3
II	DESCRIPTION AND OPERATION:	
III	SERVICE PROCEDURES: Removal and Installation Obvious Upon Inspection. See Illustrations.	
IV	TROUBLE DIAGNOSIS:	

DIVISION I SPECIFICATIONS AND ADJUSTMENTS

130-3 RADIATOR MOUNTING

The radiator mounting is a four-point system using rubber inserts on "U" shaped brackets (for the lower mounting). The upper brackets are part of the upper radiator mounting panel. The lower brackets mount on the lower portion of the radiator mounting panel.

INDEX OF ILLUSTRATIONS

Figure Number	Description	Page
130-9.....	49000 Radiator, Fan Shroud	130-13
130-10.....	49000 Radiator Supports, Overflow Reservoir, and Tubes	130-14
130-11.....	49000 Headlamp Door, Capsule, Aiming Screw, and Brace Assembly	130-15
130-12.....	49000 Hood Latch and Support, Radiator Mounts	130-16
130-13.....	49000 Grille	130-17

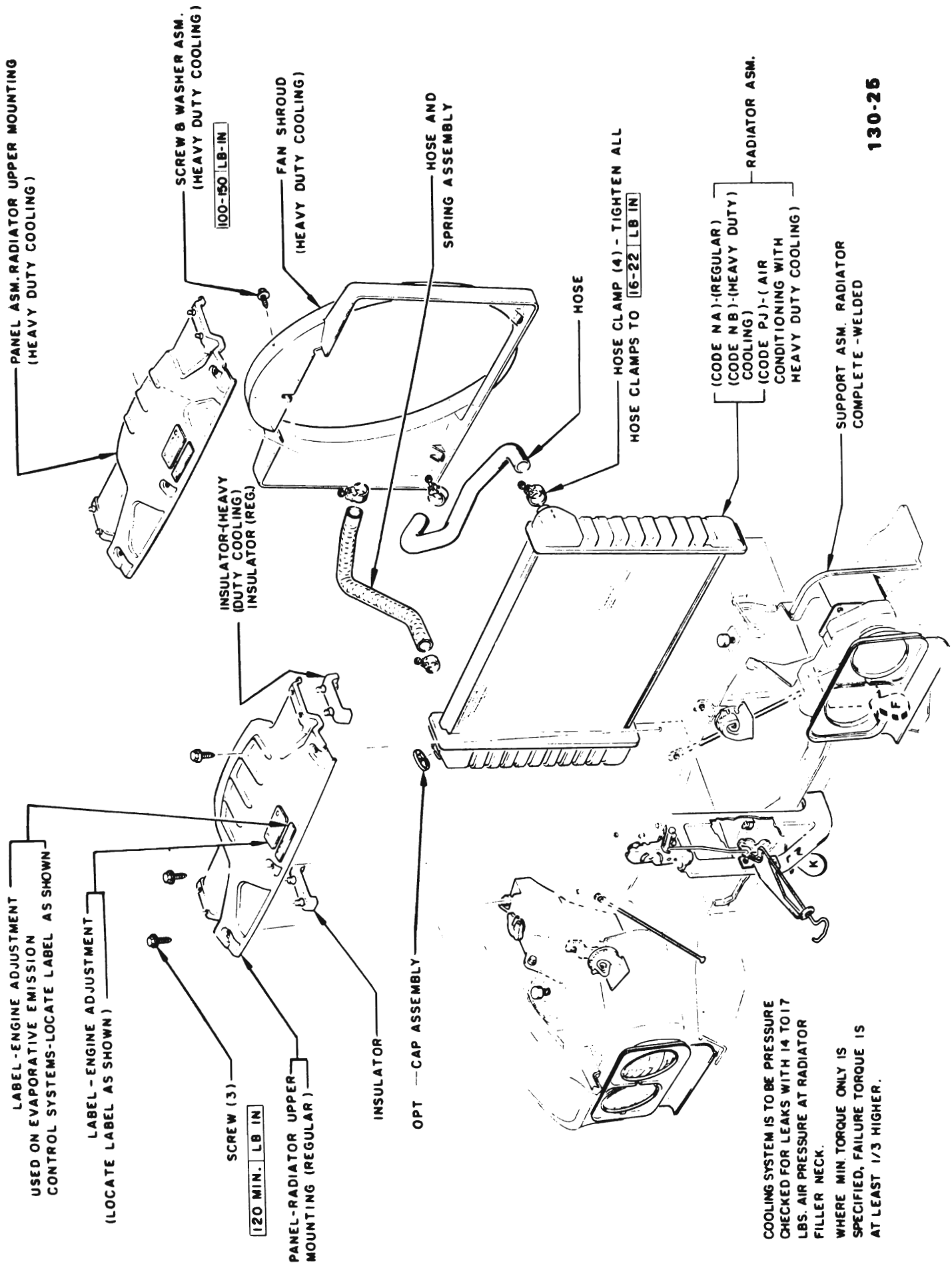
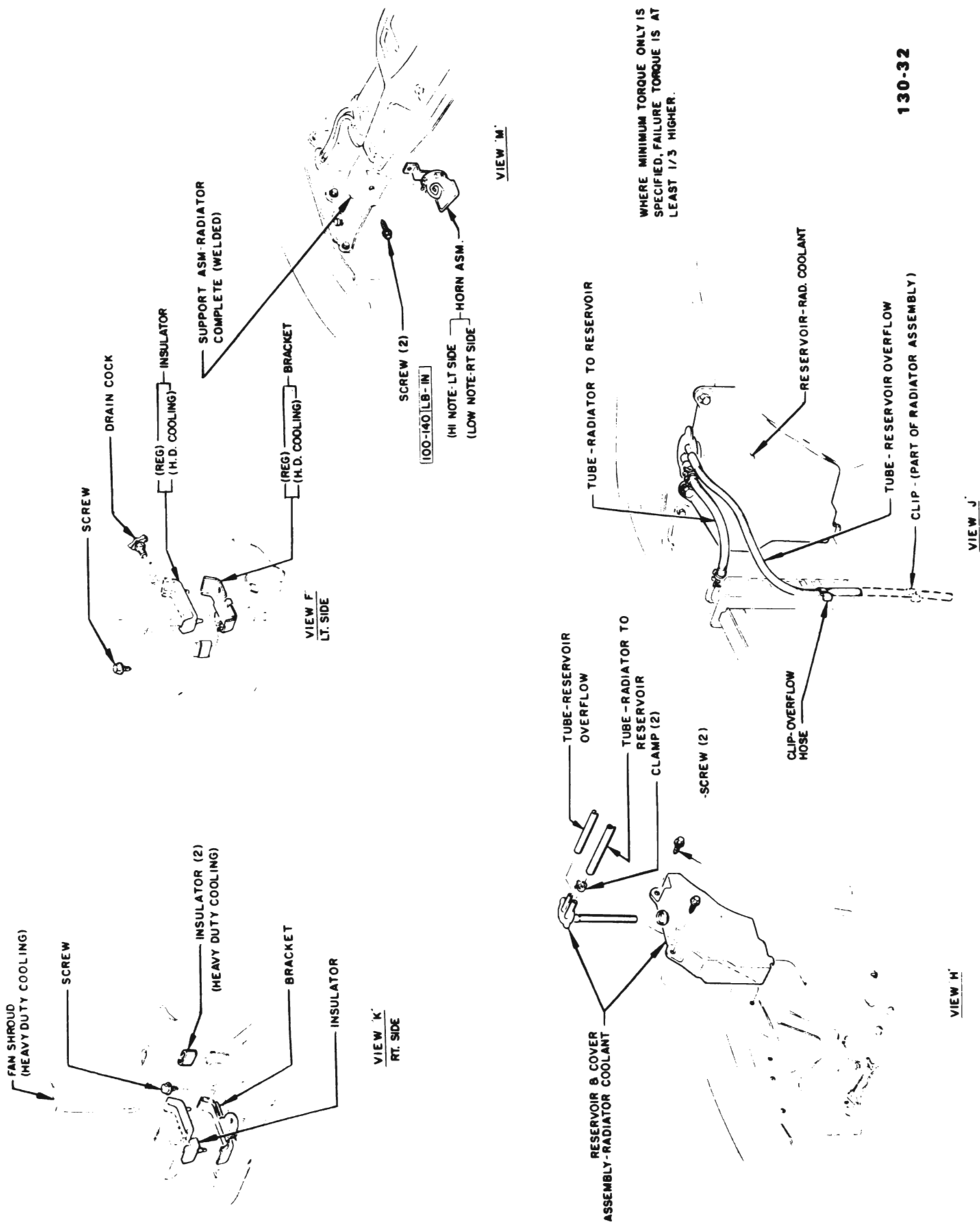

Figure 130-9 - 49000 Radiator, Fan Shroud

130-14 RADIATORS AND GRILLES



130-32

WHERE MINIMUM TORQUE ONLY IS SPECIFIED, FAILURE TORQUE IS AT LEAST 1/3 HIGHER.

Figure 130-10 - 49000 Radiator Supports, Overflow Reservoir, and Tubes

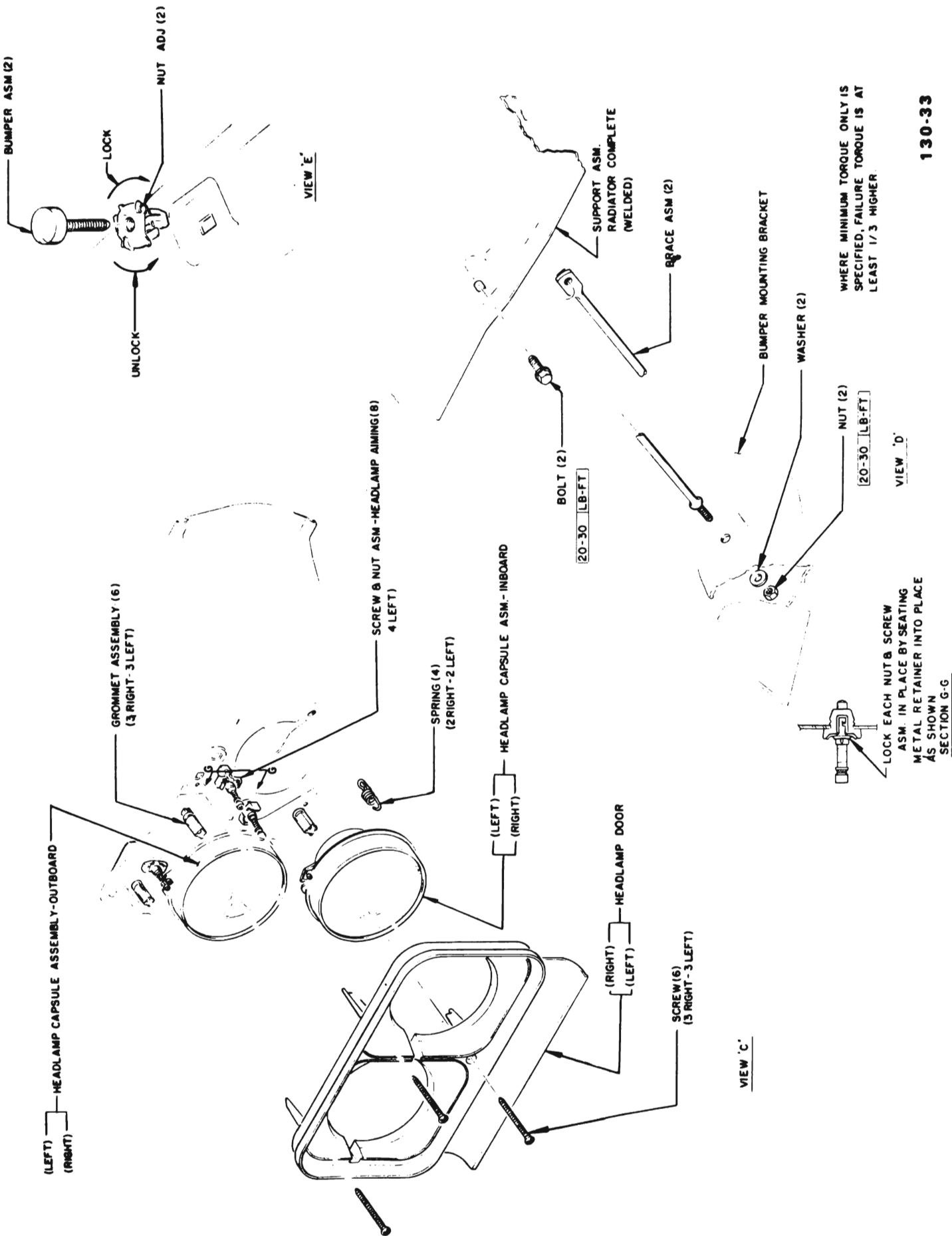

Figure 130-11 - 49000 Headlamp Door, Capsule, Aiming Screw, and Brace Assembly

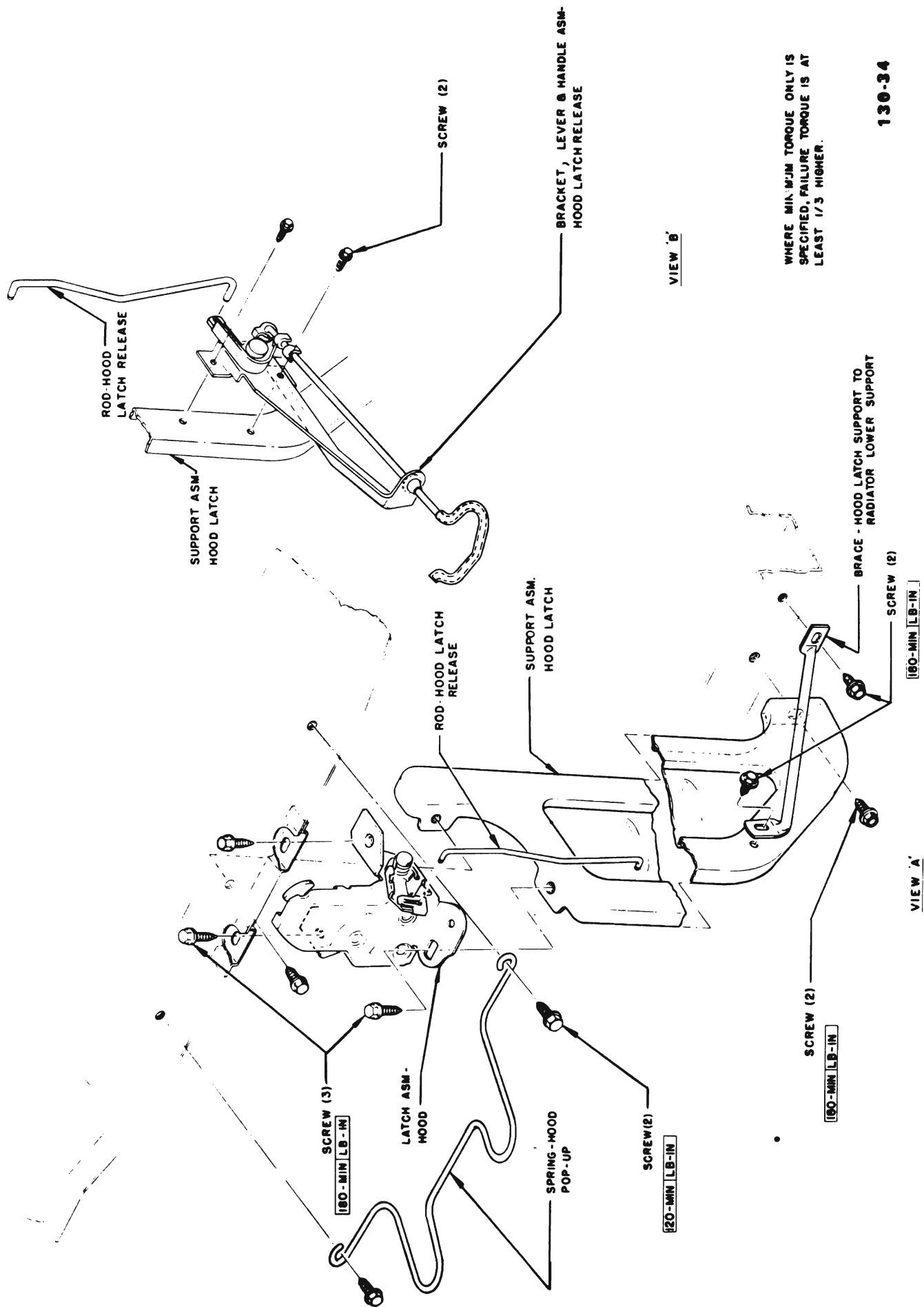
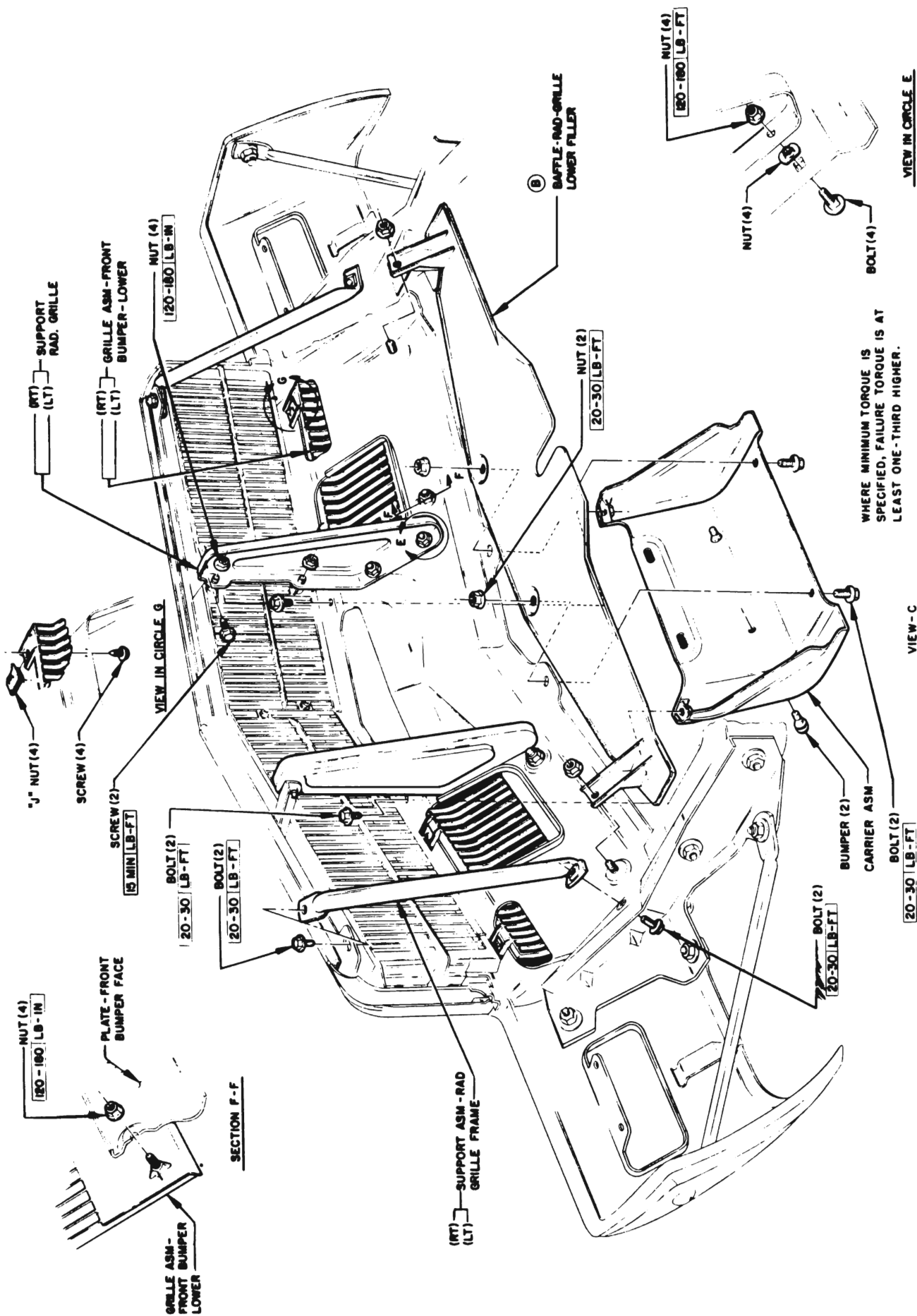

Figure 130-12 - 49000 Hood Latch and Support



130-35

GRILLE BODY REMOVAL AND INSTALLATION -

1. Remove license carrier.
2. Remove two center radiator grille supports.
3. Remove two bolts at each end of grille body.
4. Move grille body downward and rearward, then to one end. Raise other end upward to remove.
5. Install grille body in reverse sequence.

Figure 130-13 - 49000 Grille