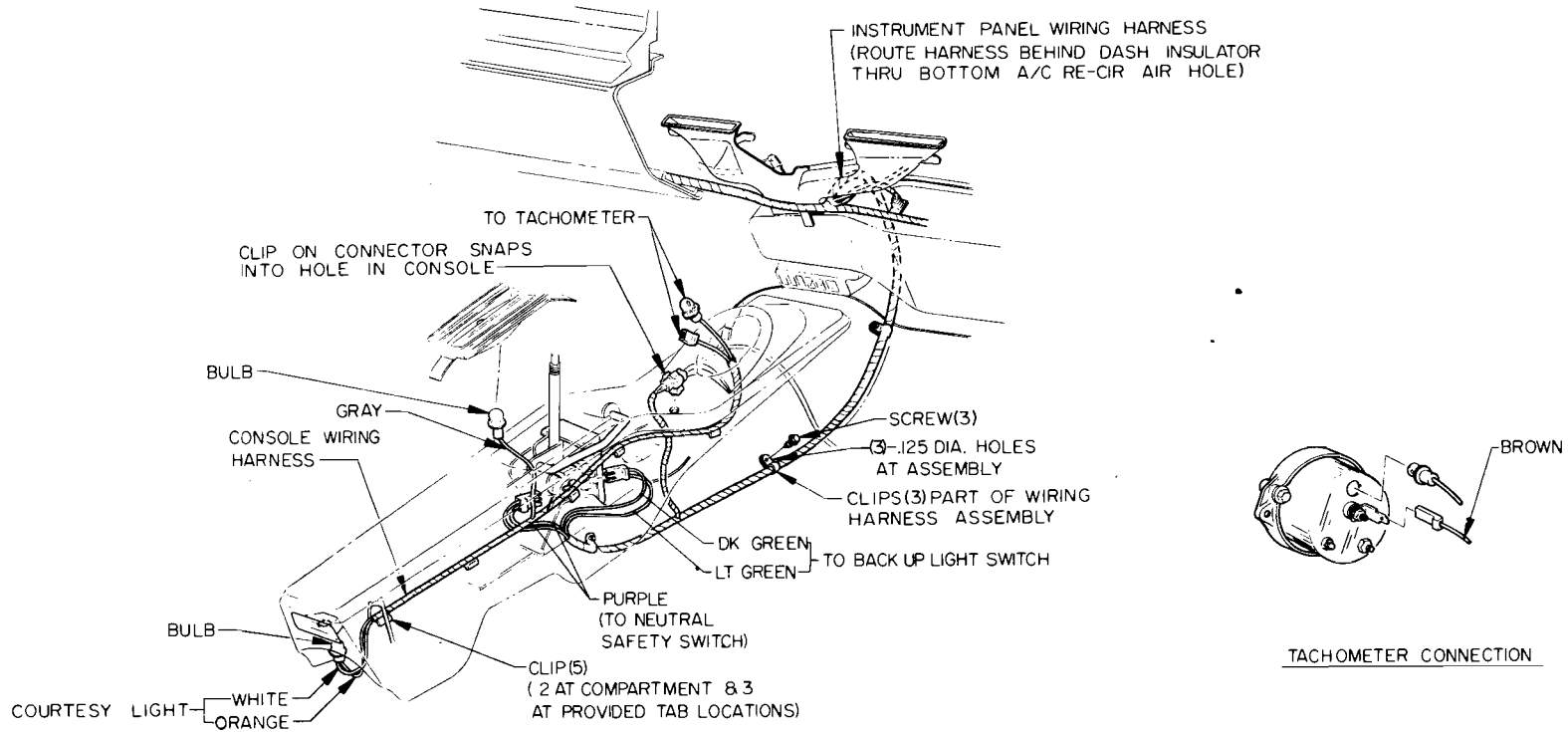
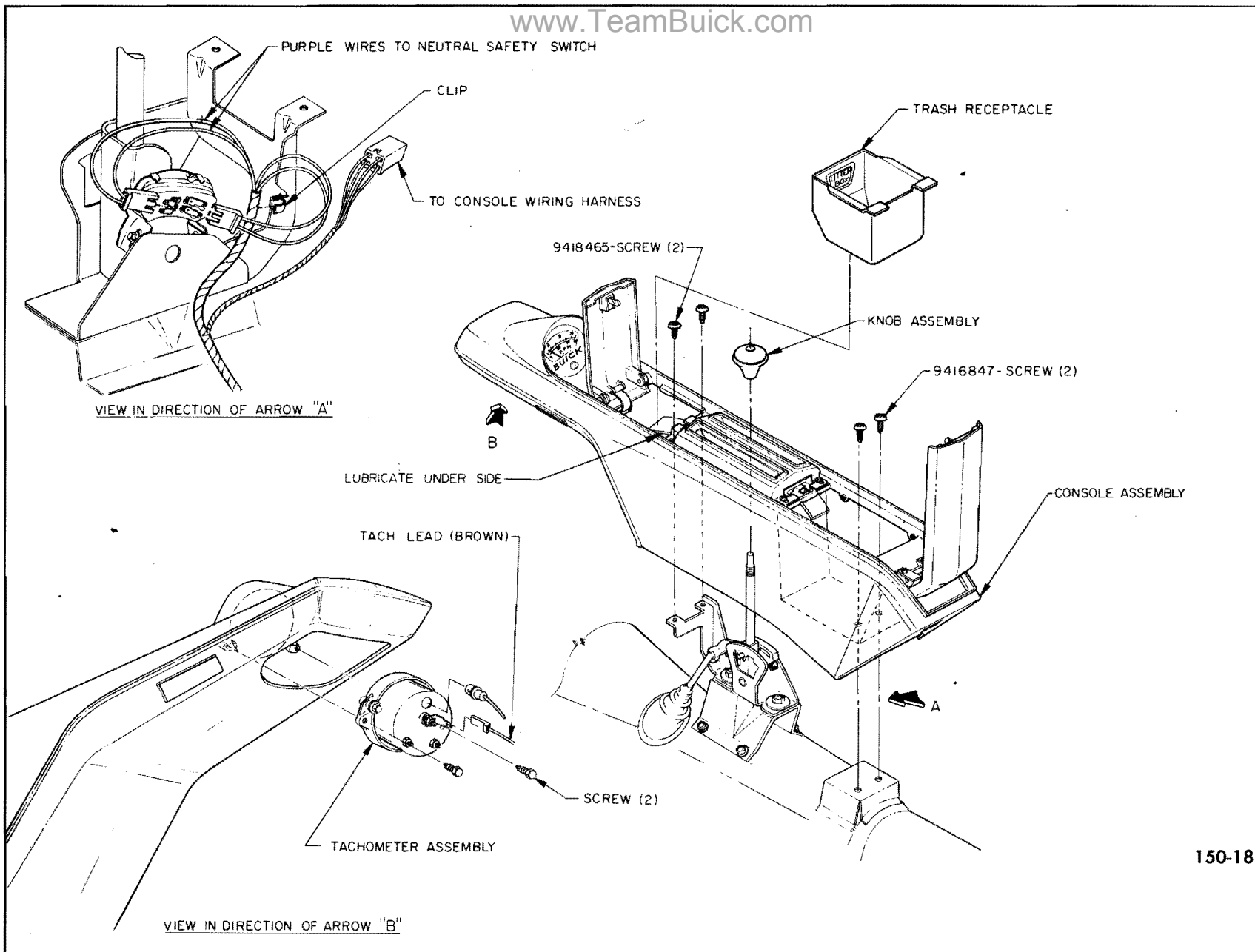

Figure 150-16—Tachometer Installation Skylark Gran Sport 3 or 4 Speed with Consolette



150-17

Figure 150-17—Tachometer Installation Skylark and Skylark Gran Sport Automatic with Console Shift



150-18

Figure 150-18—Tachometer Installation Upper Series Automatic with Console Shift

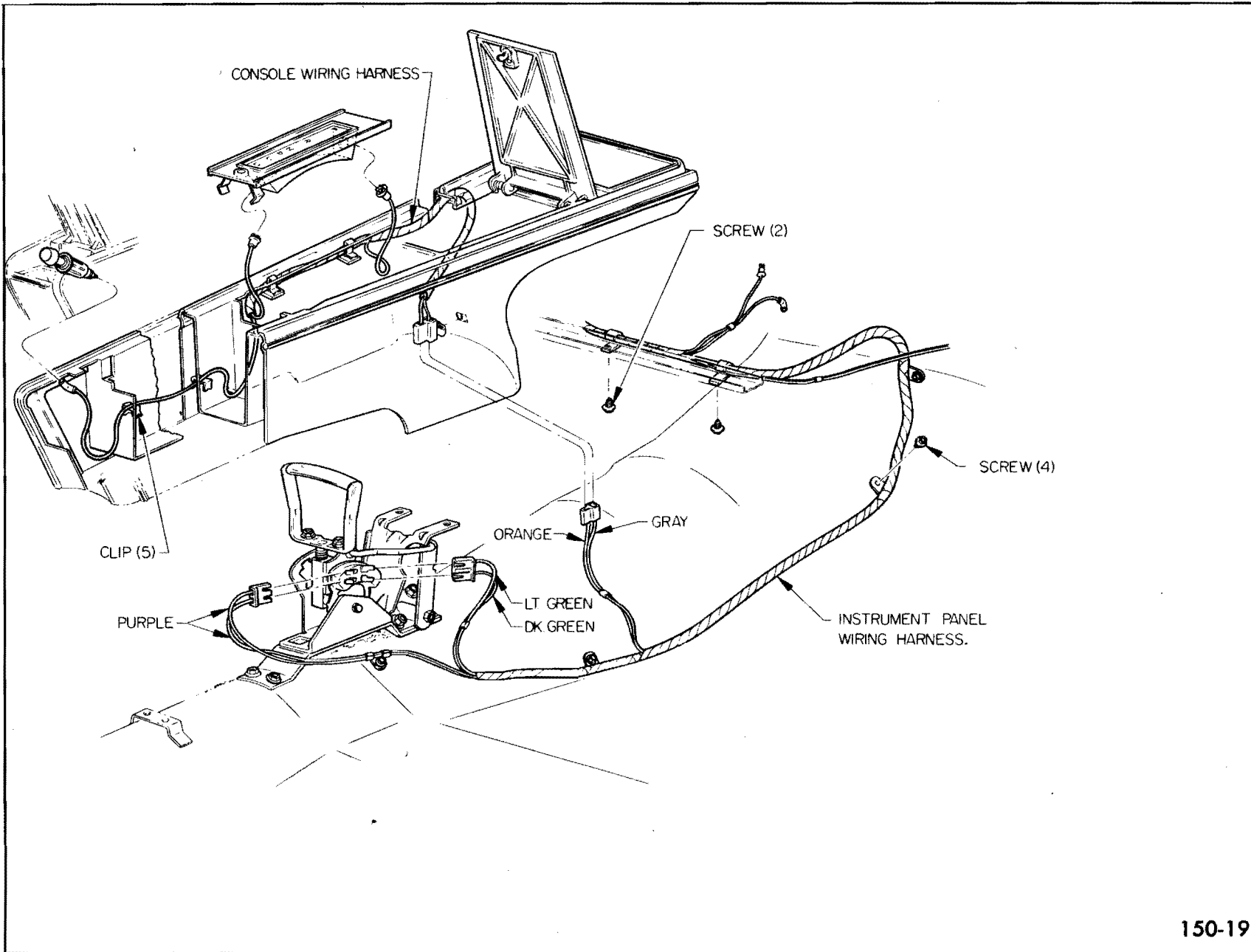

150-19

Figure 150-19—Console Information - 49000 Series