

SECTION 10-J

WIRING CIRCUIT DIAGRAMS

CONTENTS OF SECTION 10-J

| Paragraph | Subject | Page |
|-----------|---|--------|
| 10-63 | Circuit Diagrams and Fuse Block | 10-112 |

10-63 CIRCUIT DIAGRAMS AND FUSE BLOCK

This section contains schematic wiring circuit diagrams for complete car. For more detailed body wiring diagrams showing the routing of the wires and the location of the switches, connectors and retaining clips - see the Buick Body Service Manual. Wiring diagrams of the power window and power seat circuits are also in that section.

A few of the most important wiring terminals are connected with screws. However, most of the terminals have a flat push-pull type connector, the terminal on

the wire requires a straight hard push to seat it in the socket. A hard steady pull on the terminal is required to detach it from the socket.

A central fuse block is mounted under the left side of the instrument panel. This fuse block serves as a convenient junction point for a number of circuits, provides a mounting for the direction signal flasher, and contains most of the fuses. The fuse block is held in its bracket by a spring clip and may be easily slipped out to check the fuses on one side or to check the connections on the other side. See Figure 10-137 or 149.

To simplify replacement of the wiring, the circuits to the rear of the cowl are grouped in one harness and the circuits forward of the cowl are grouped in another. The instrument panel wiring harness ends in a multiple connector which is held in the cowl. The engine compartment wiring harness plugs into this connector at the cowl. This type of connector aids in tracing down electrical troubles. See Figure 10-138 or 150.

Figure 10-135 may be used as an index for the Series 4400-4600-4800 electrical figures; Figure 10-147 may be used as an index for the Riviera electrical figures.

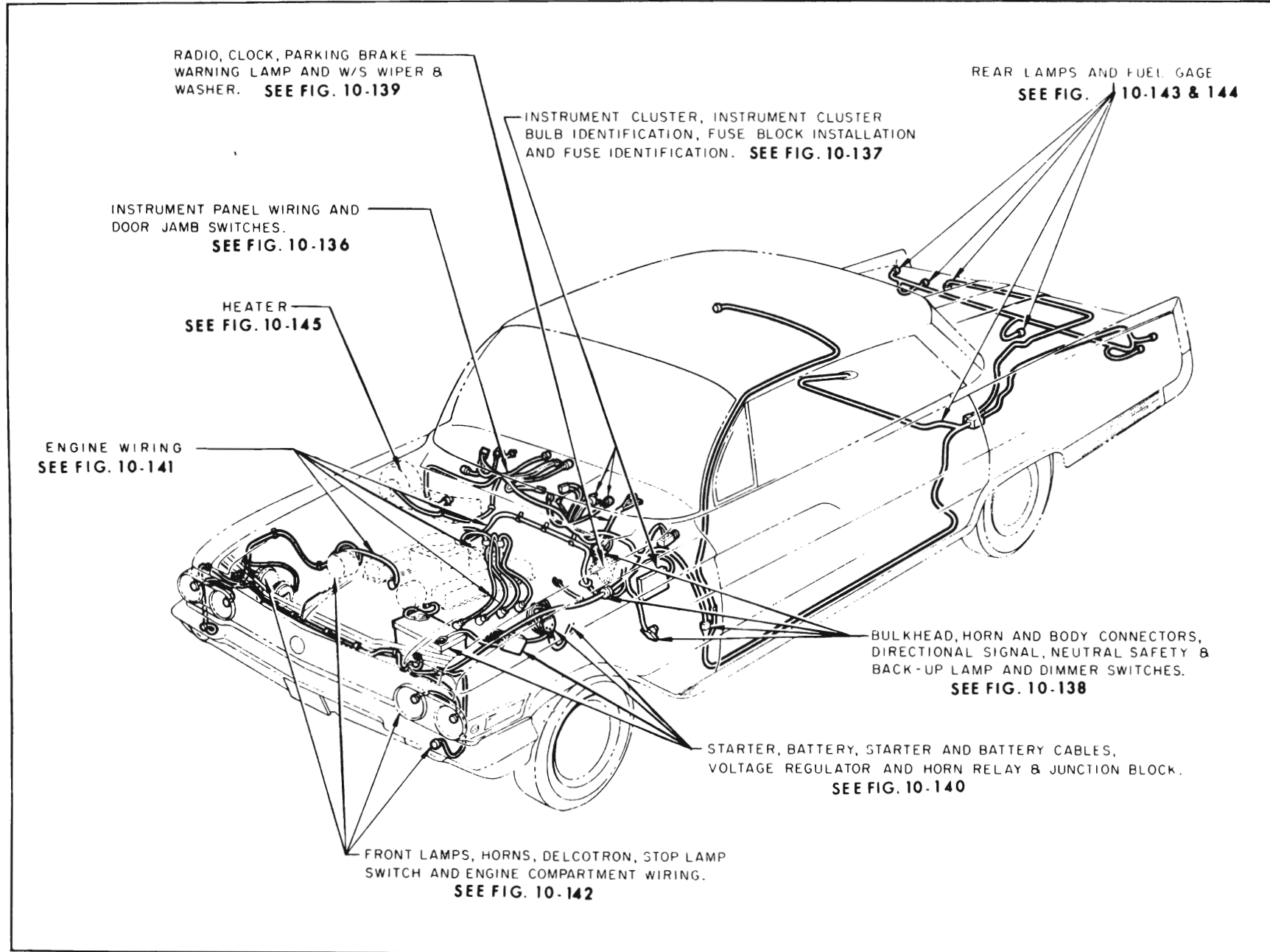

Figure 10-135—Index—Electrical Information

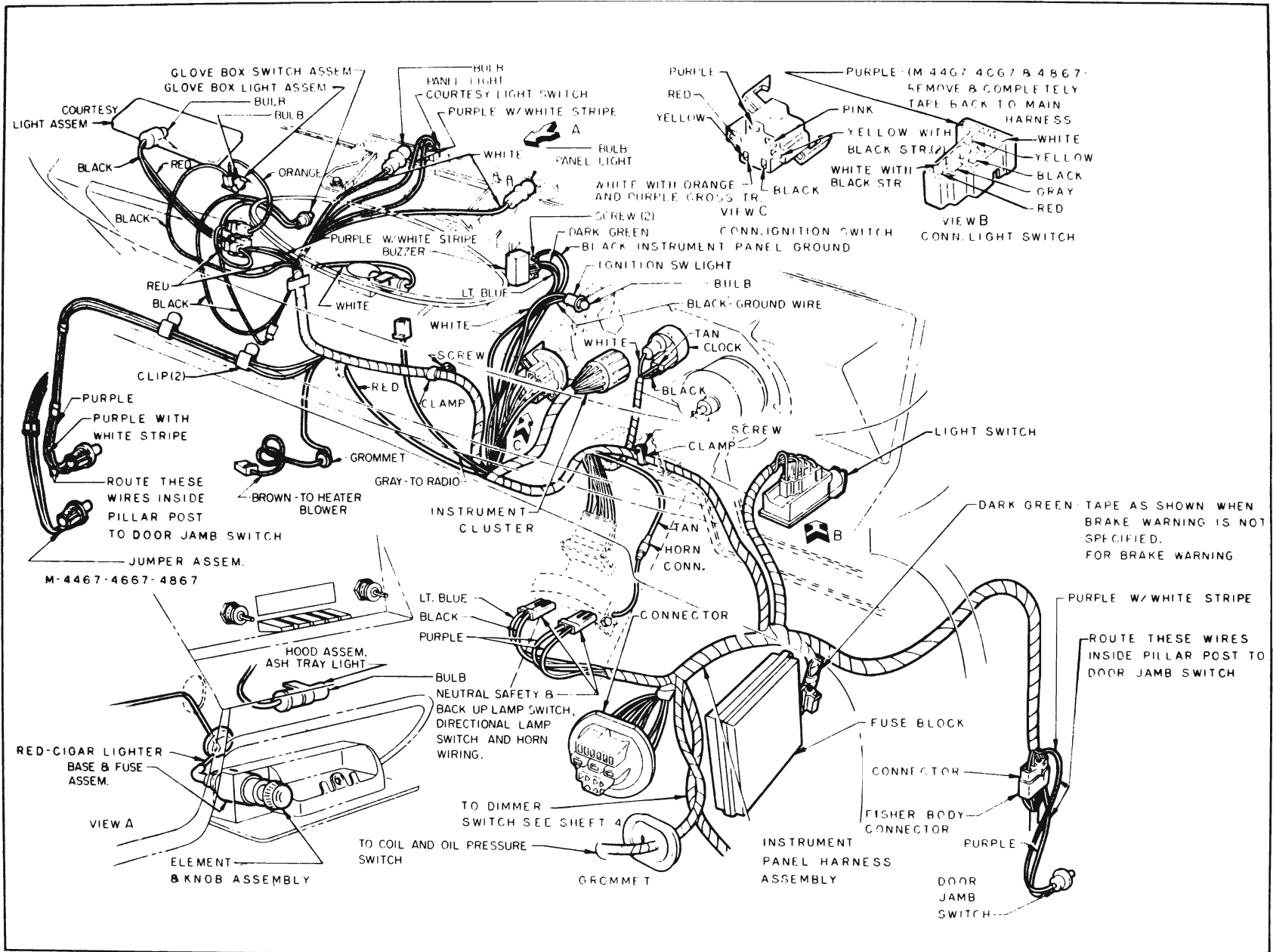

Figure 10-136—Instrument Panel Wiring

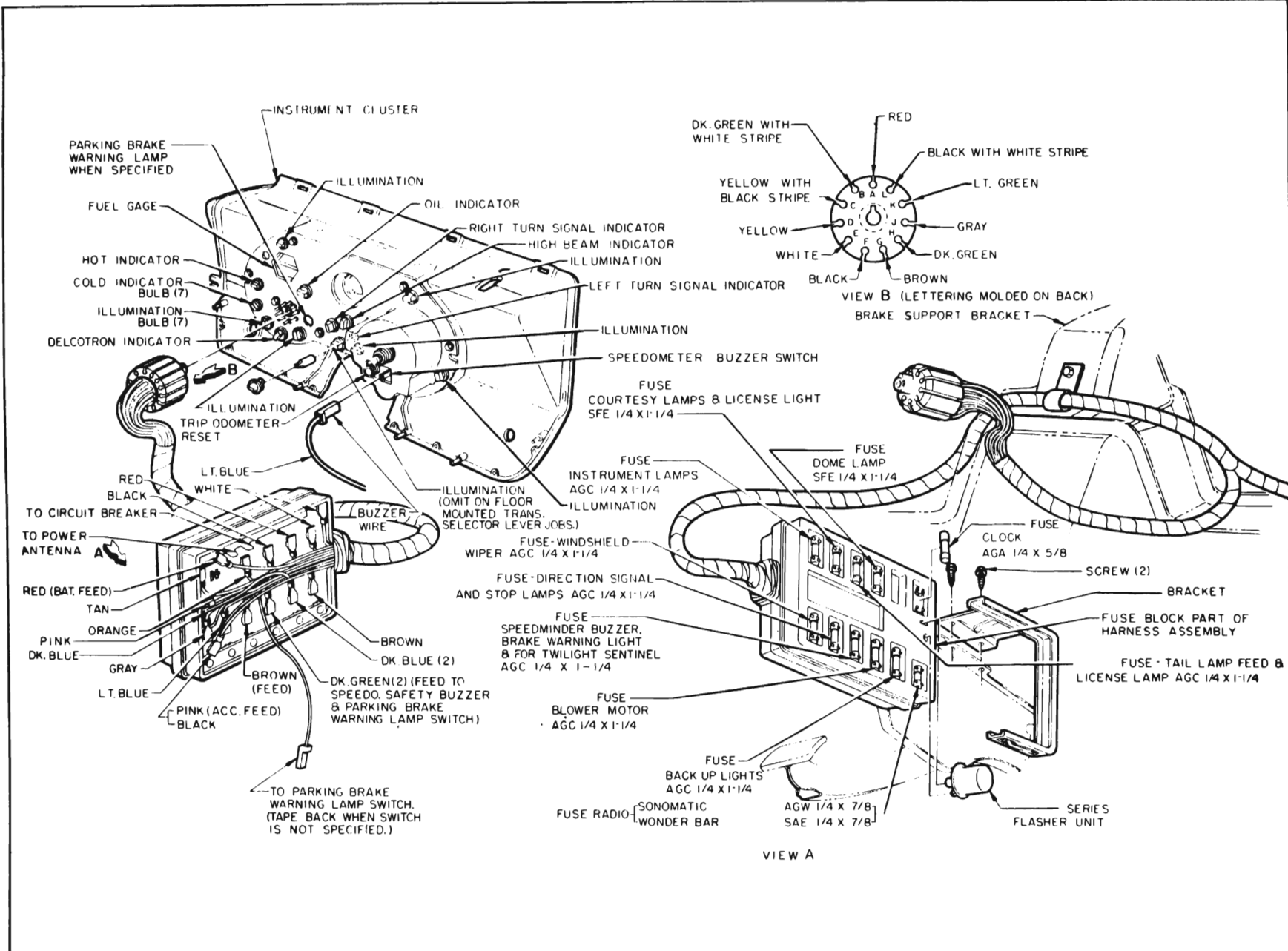

Figure 10-137—Instrument Cluster and Bulbs, Fuse Block and Fuses

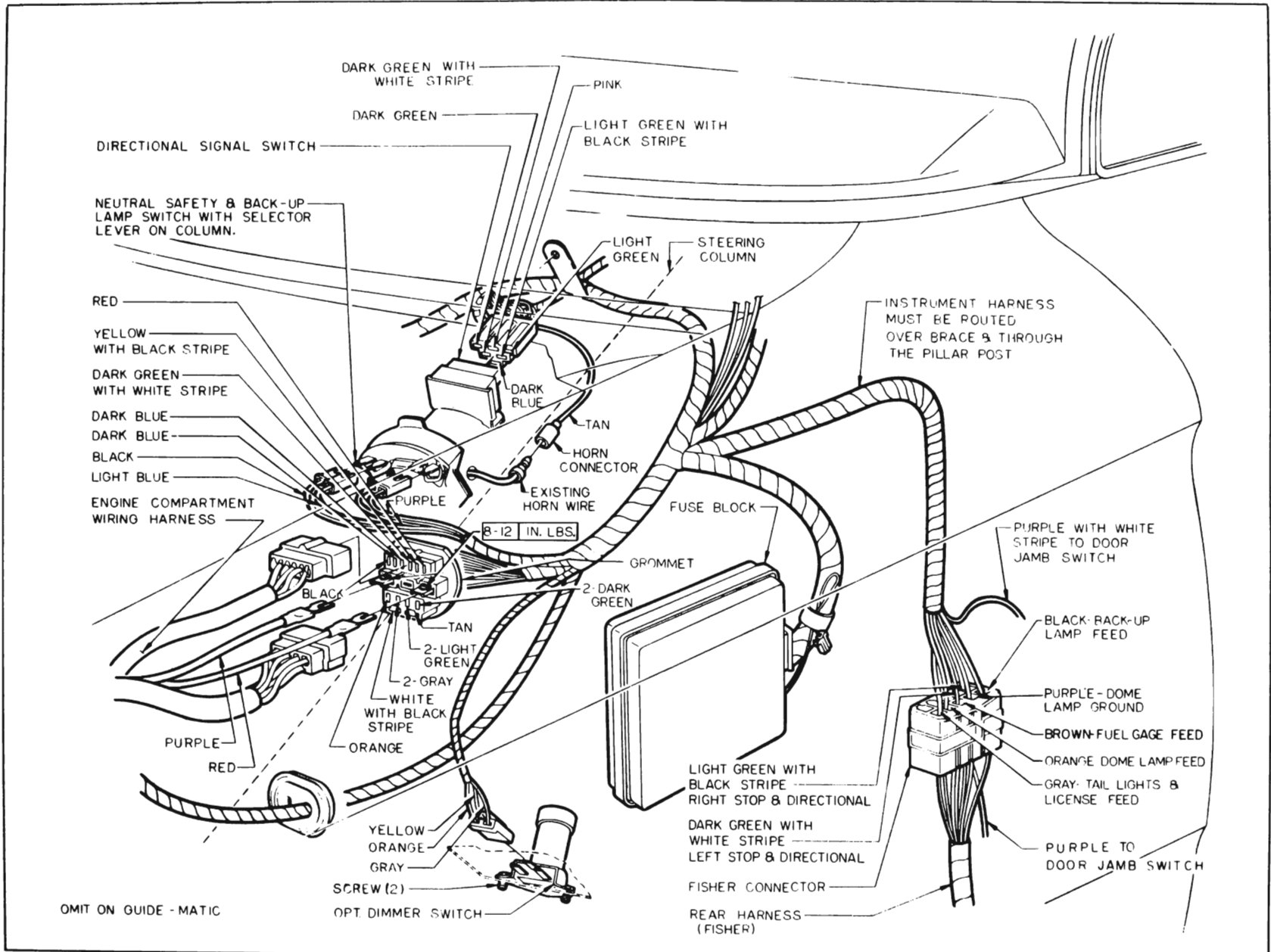

Figure 10-138—Bulkhead and Body Connectors, Turn Signal, Neutral Safety and Dimmer Switches

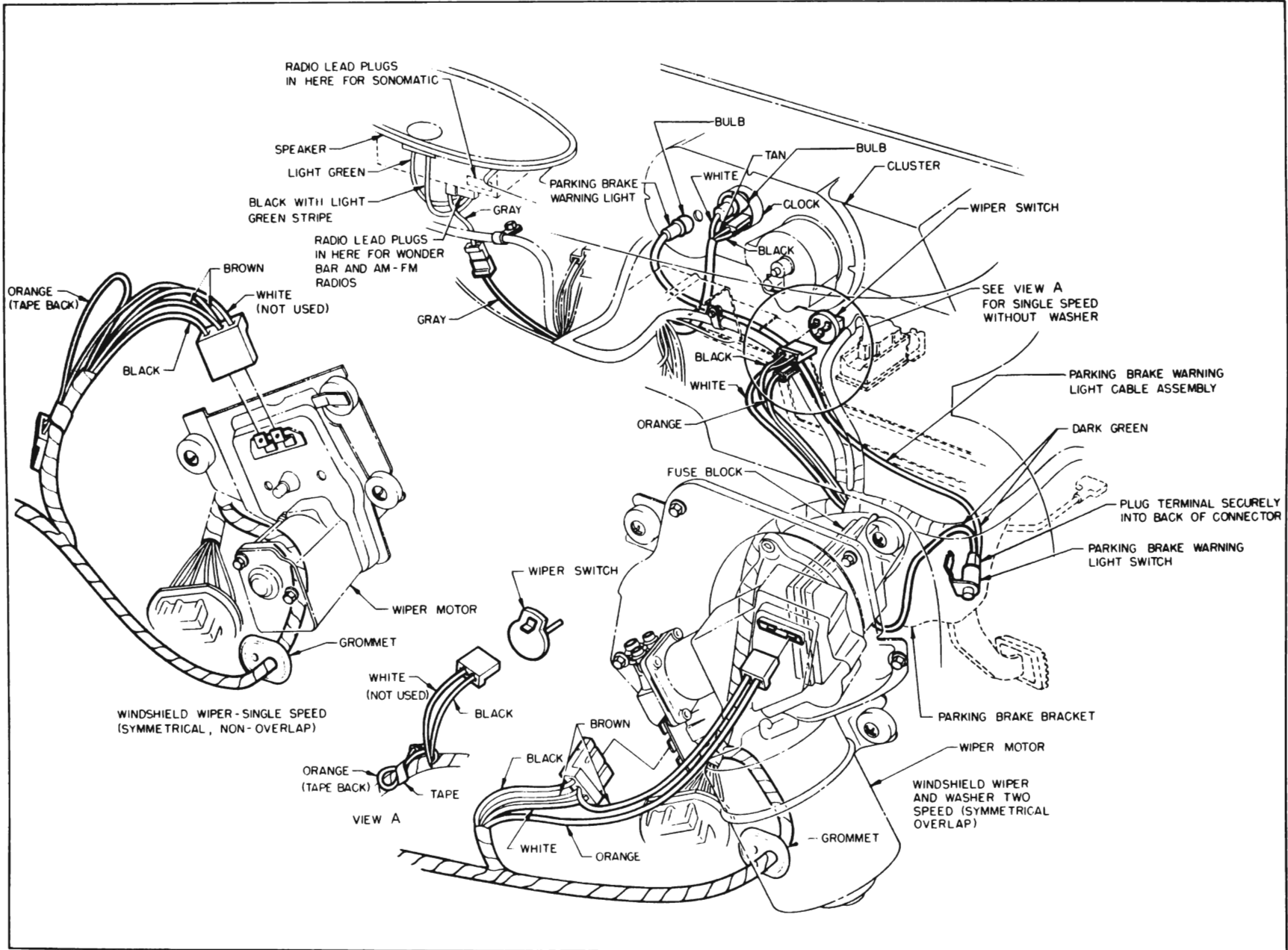

Figure 10-139—Radio, Clock, Parking Brake Warning Light and Wiper Connections

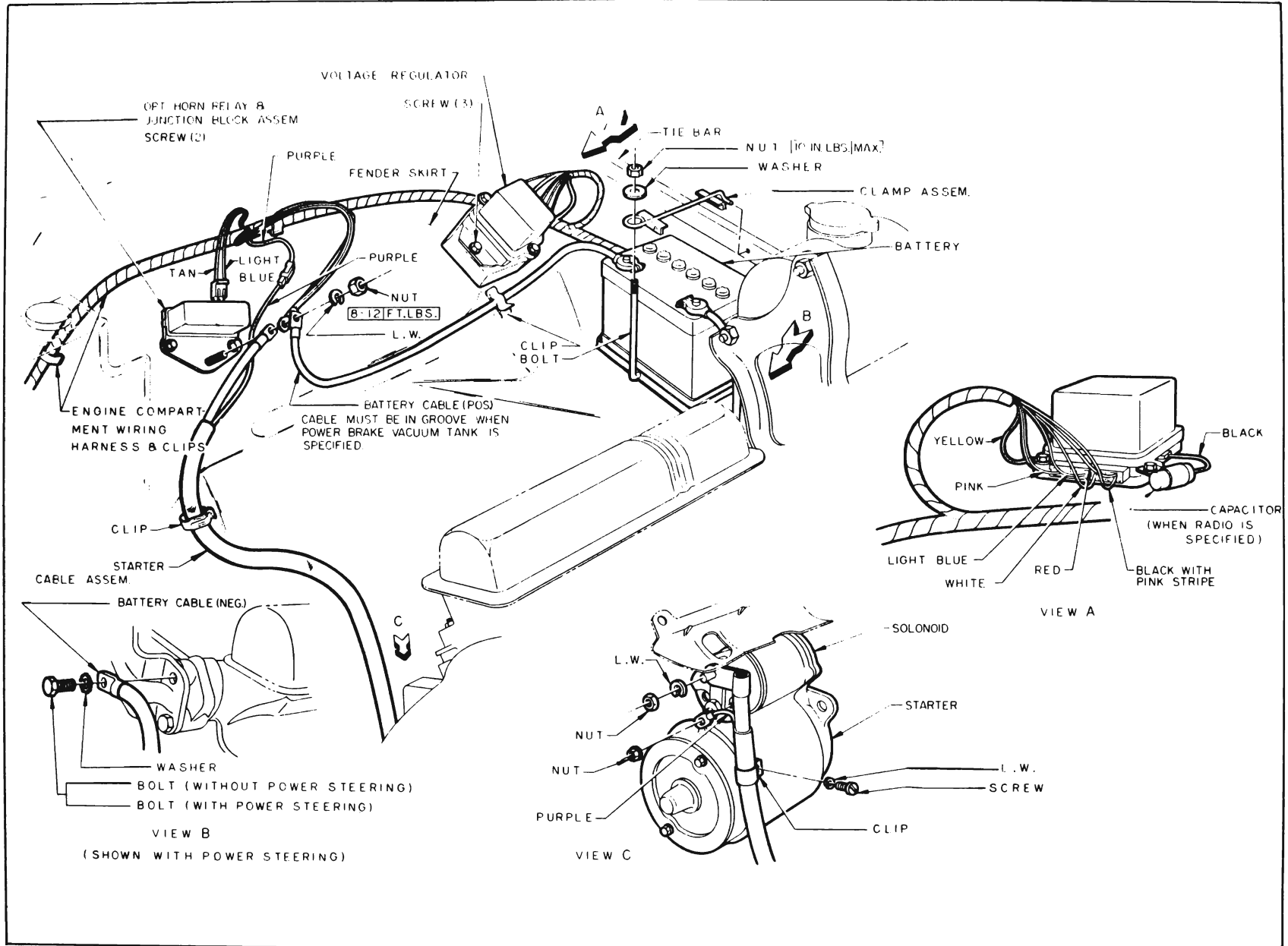

Figure 10-140—Starter, Battery, Voltage Regulator, Horn Relay and Junction Block

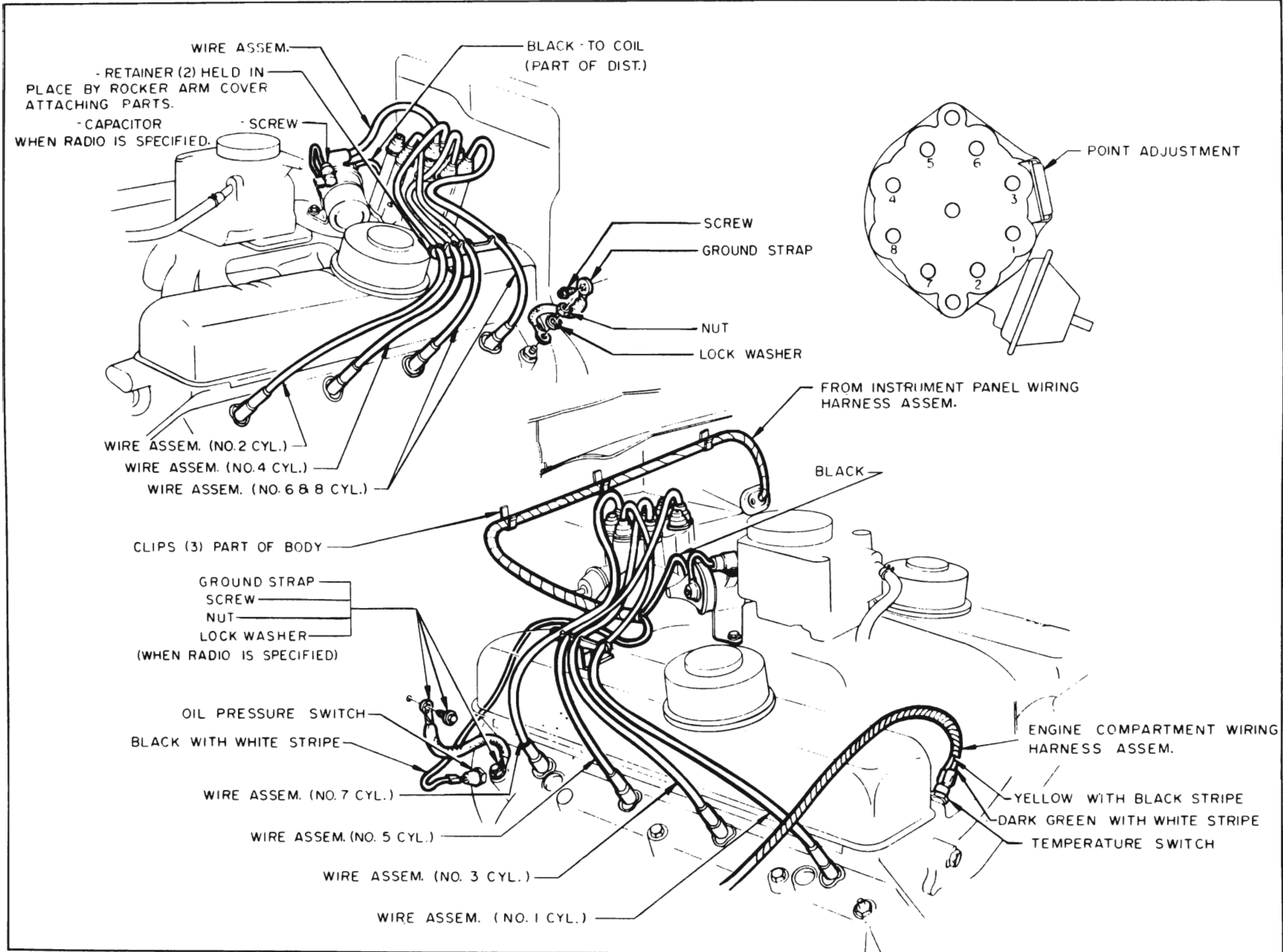

Figure 10-141—Engine Wiring

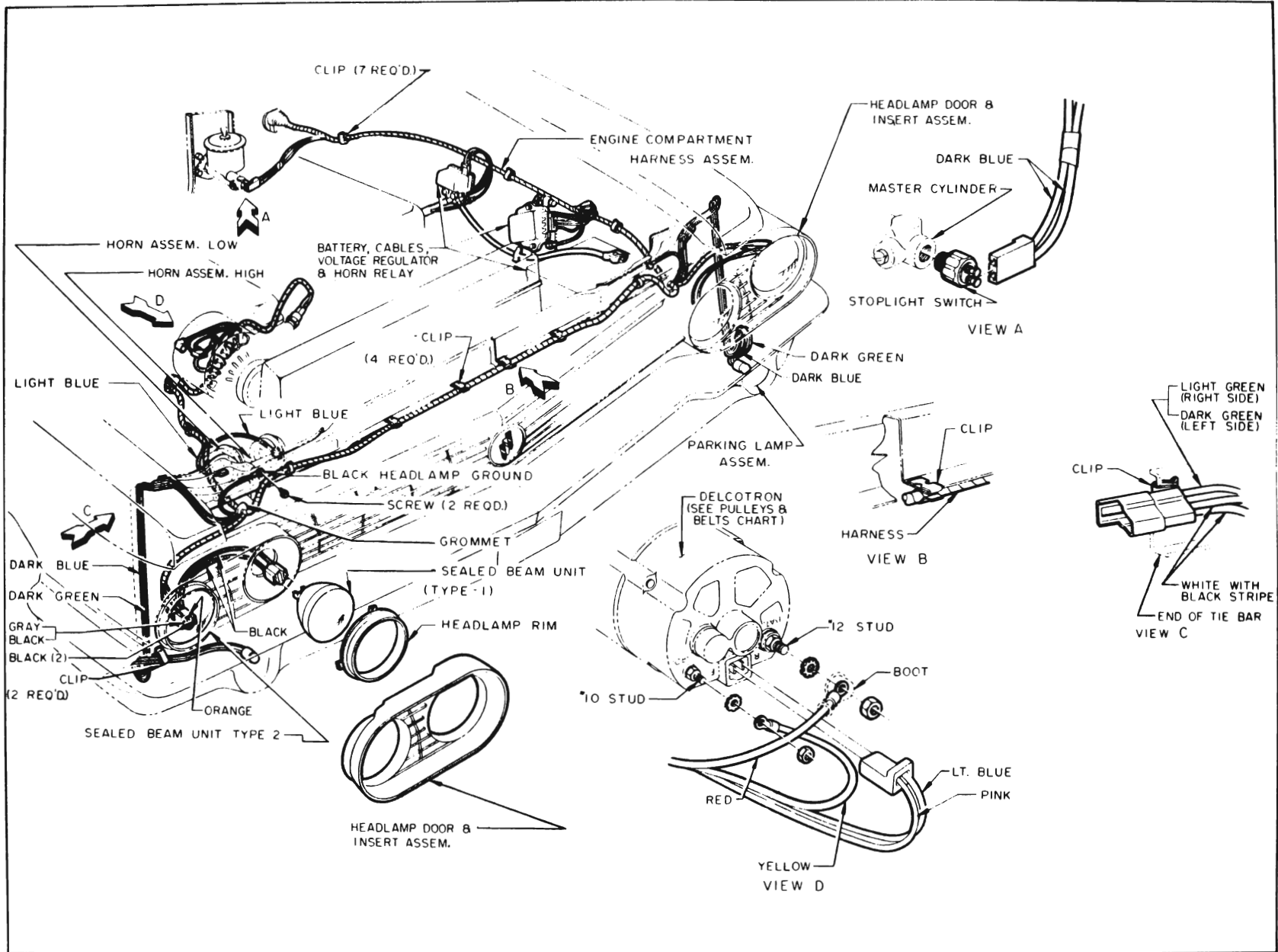

Figure 10-142—Front Lamp and Engine Compartment Wiring

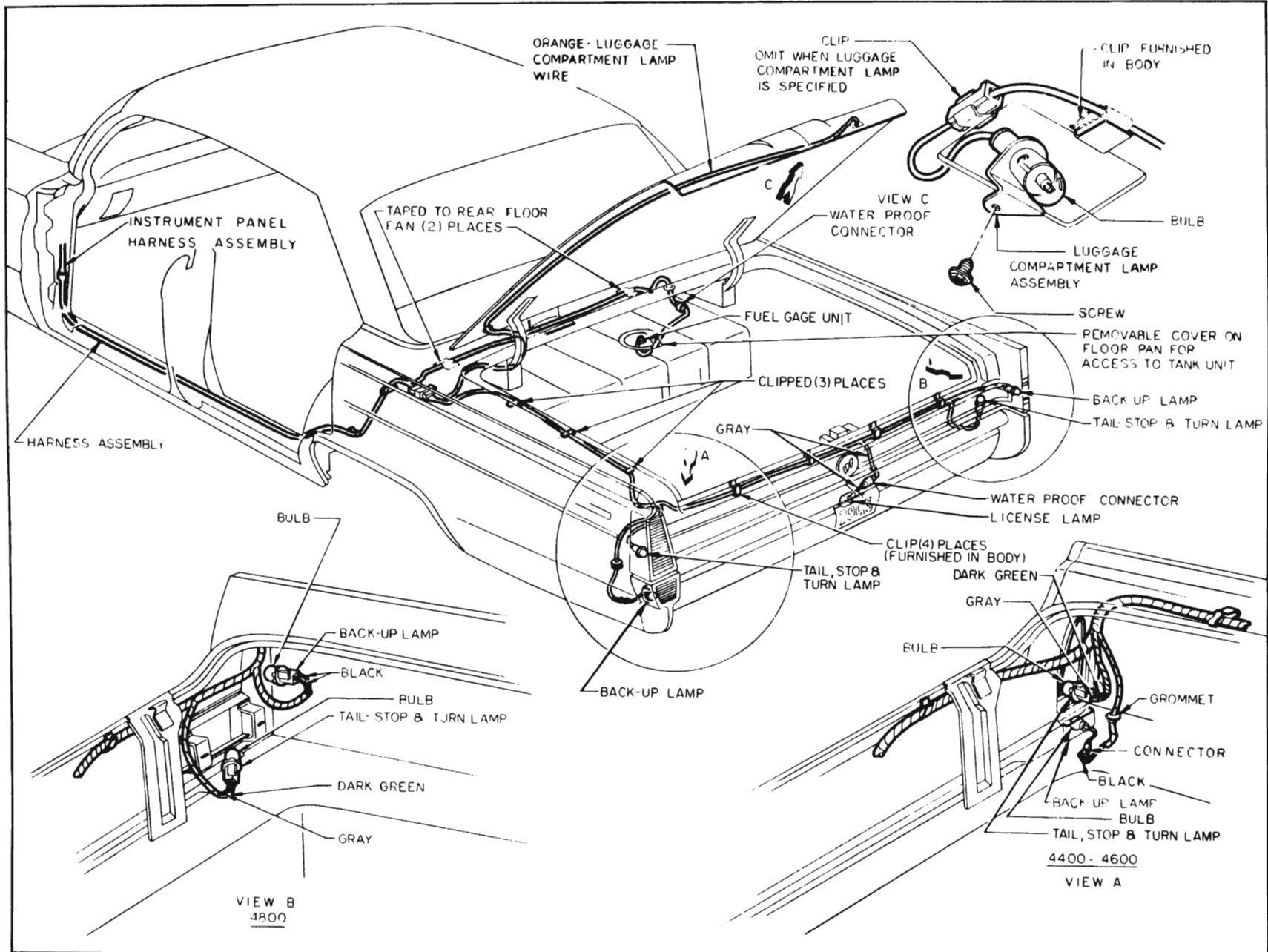

Figure 10-143—Rear Lamps and Fuel Gauge

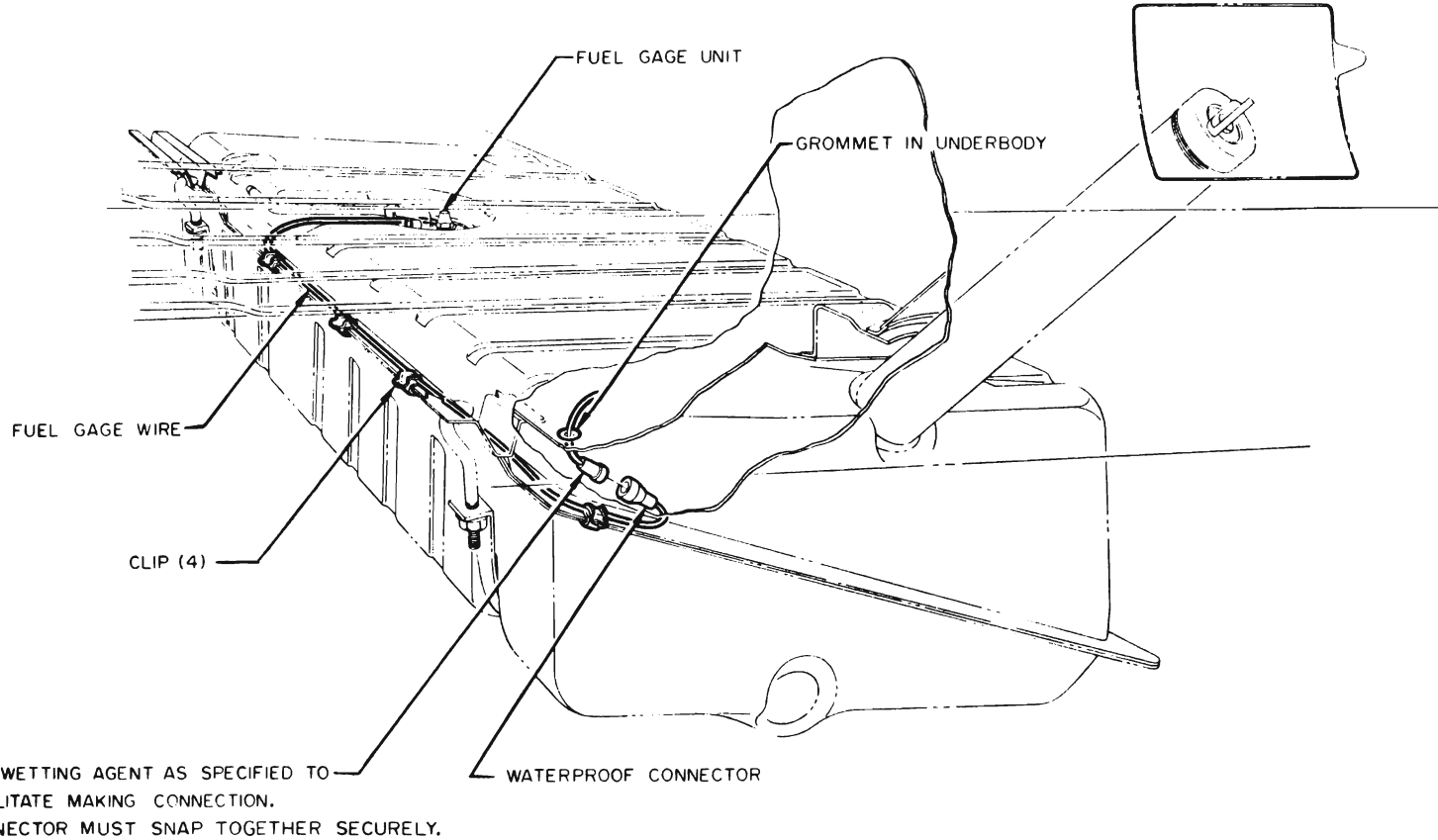

Figure 10-144—Estate Wagon—Fuel Gauge

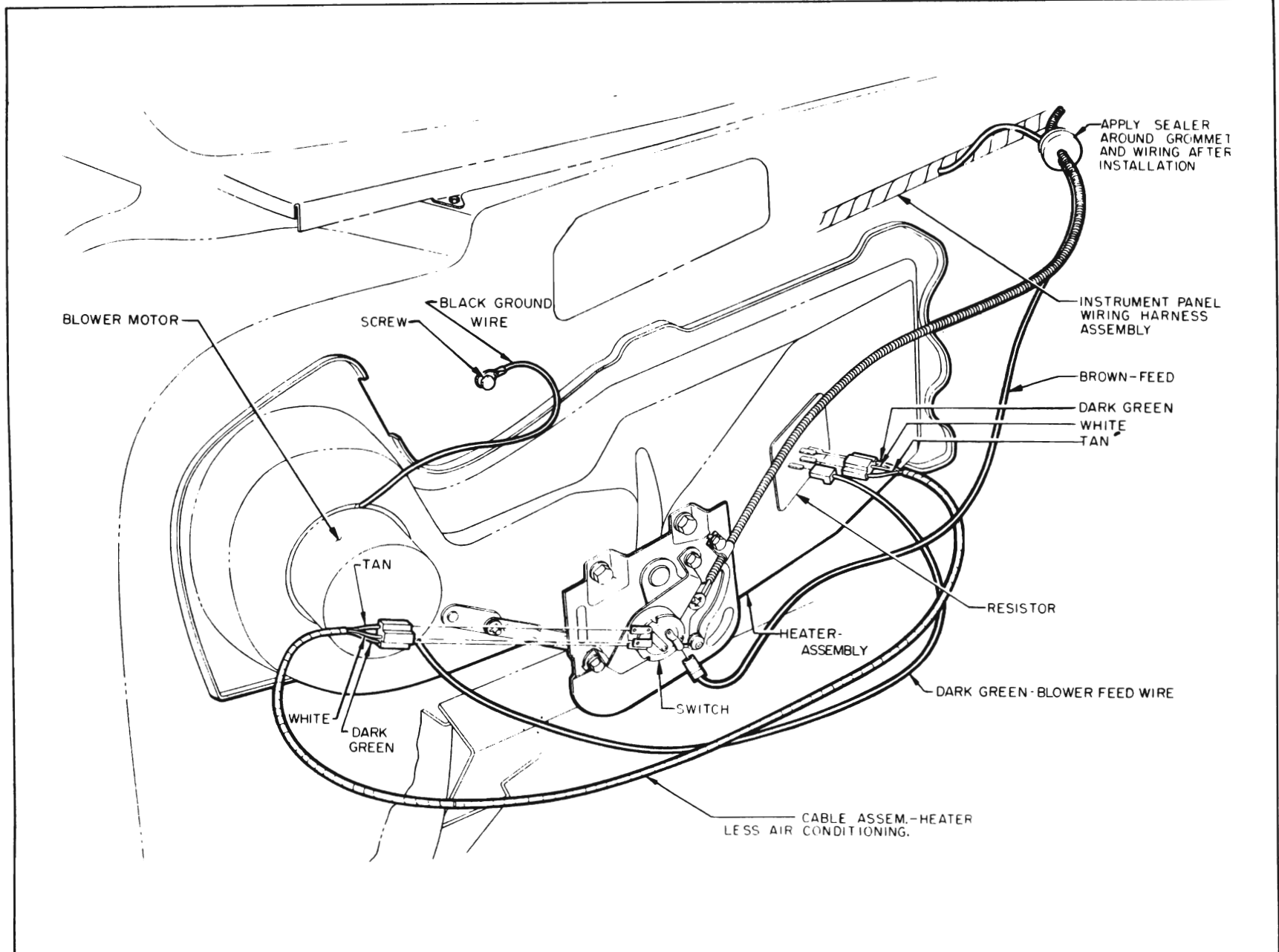

Figure 10-145—Heater

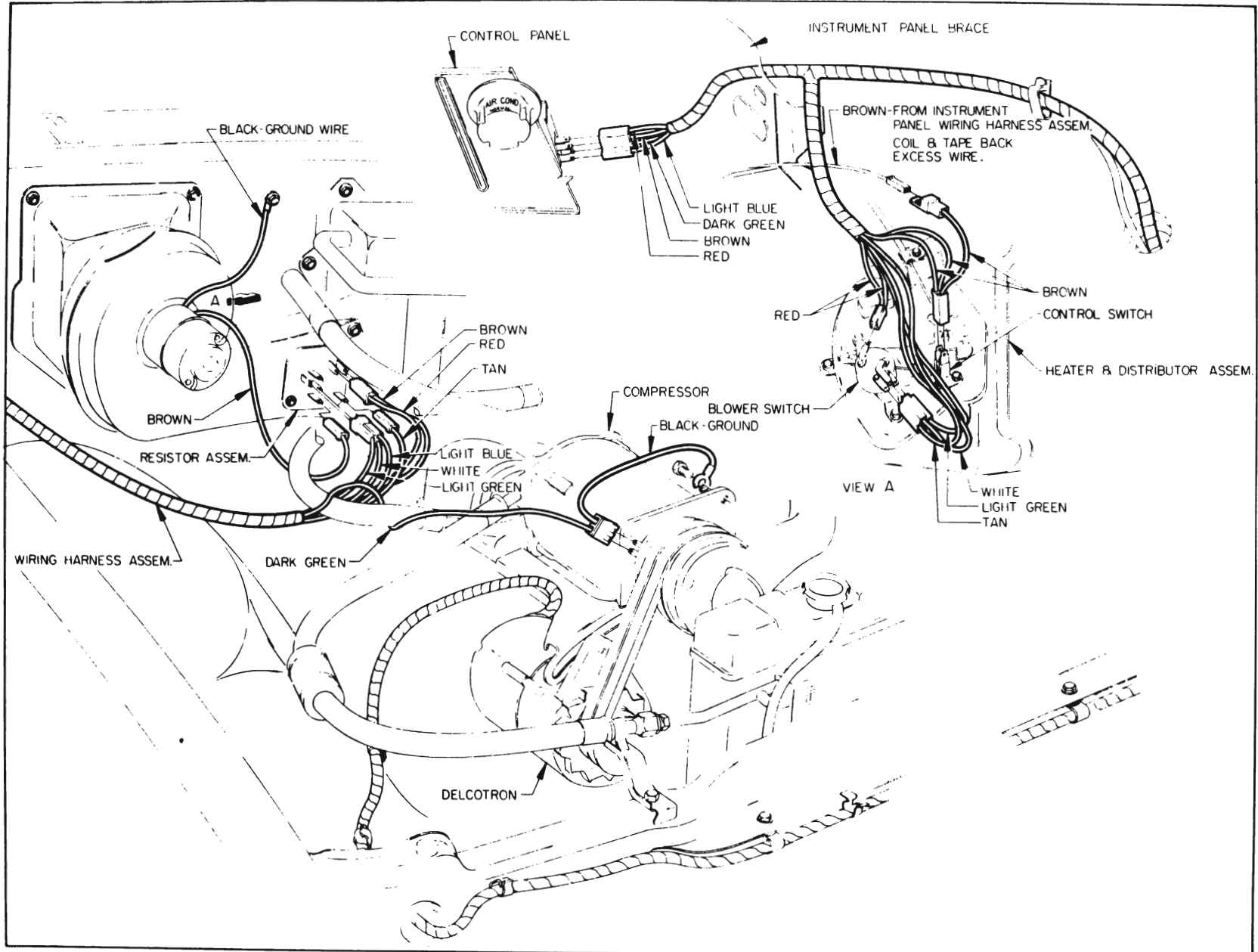

Figure 10-146—Air Conditioning Wiring

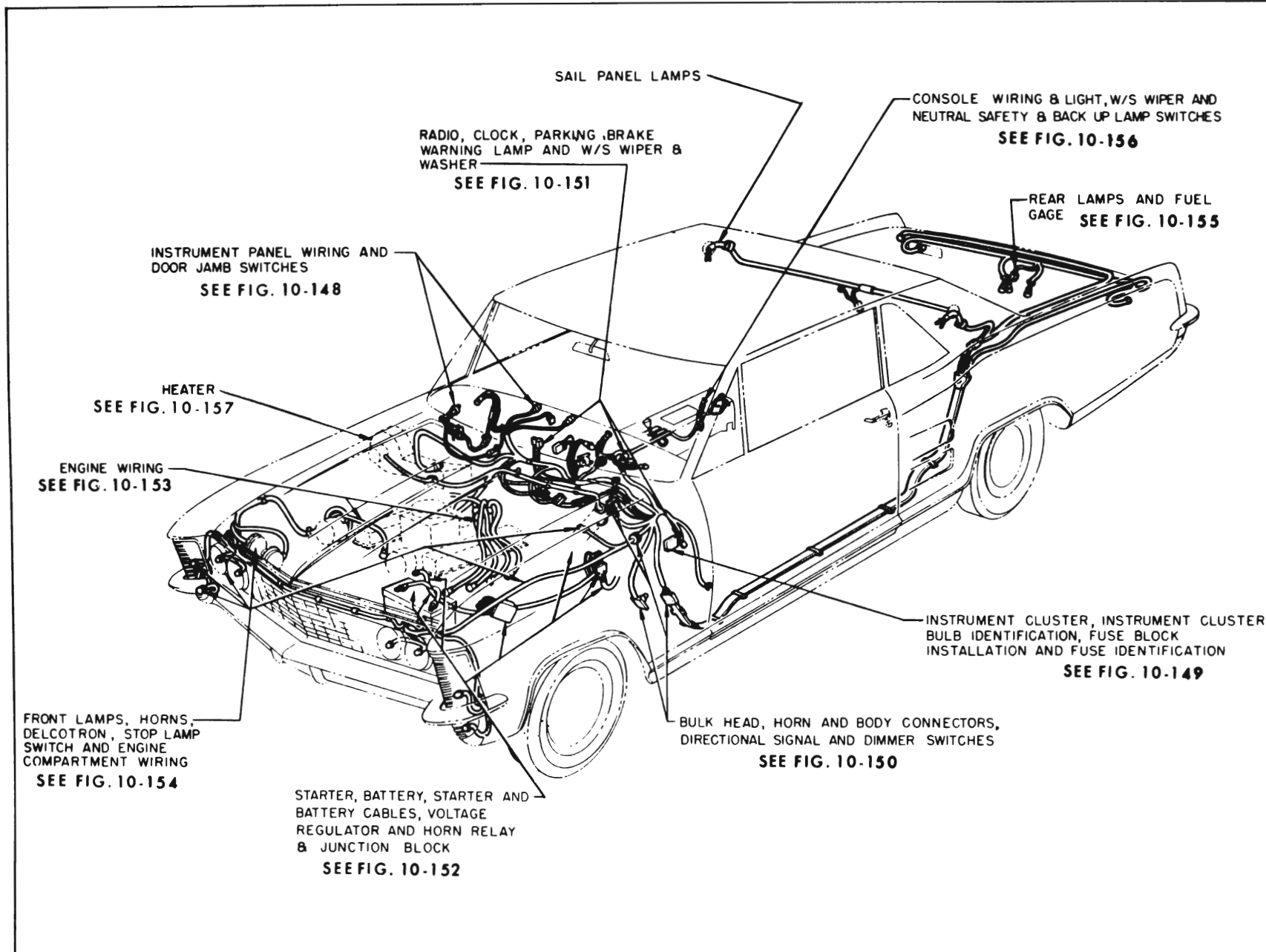

Figure 10-147—Index—Electrical Information—Riviera

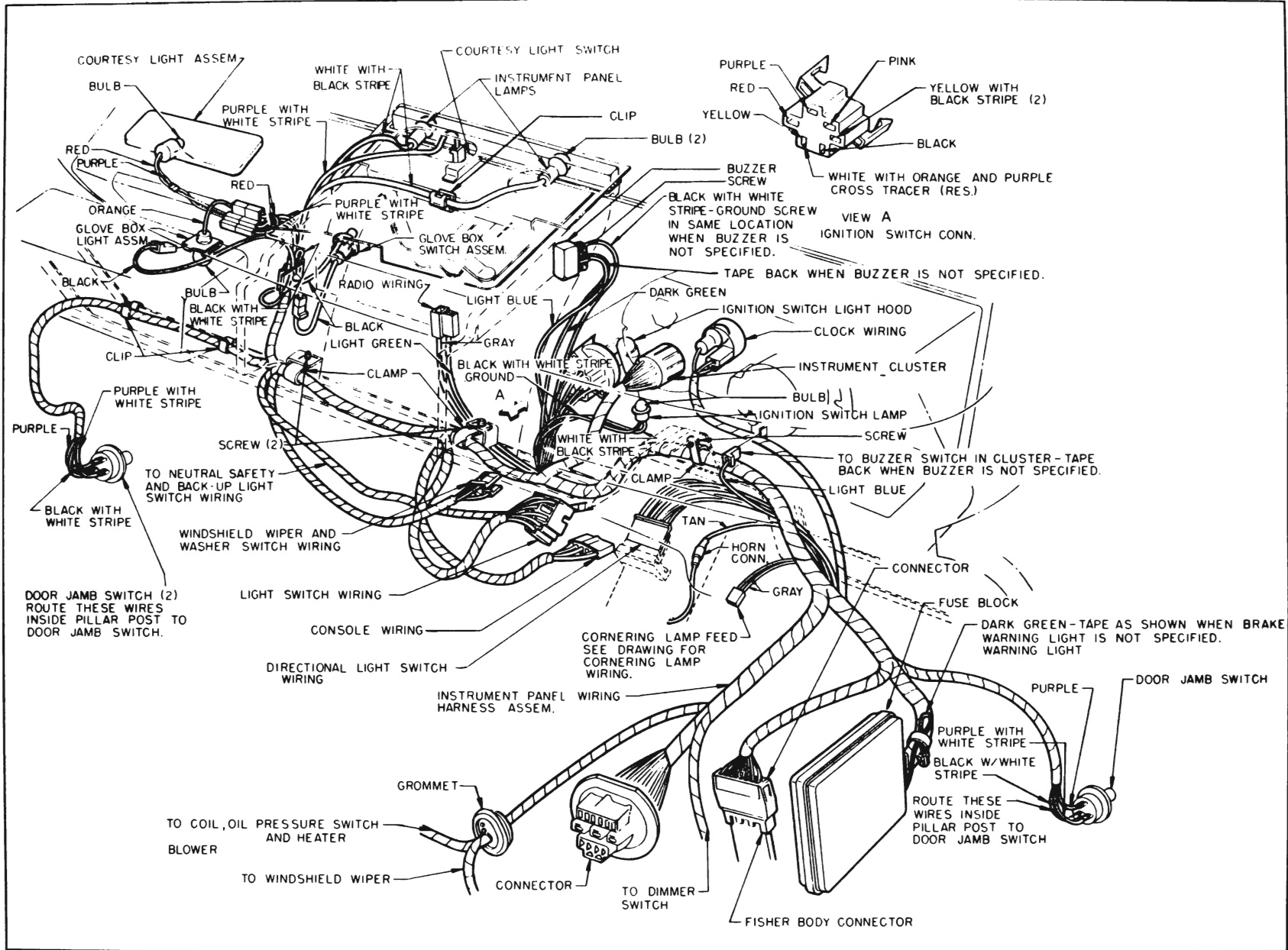

Figure 10-148—Instrument Panel Wiring—Riviera

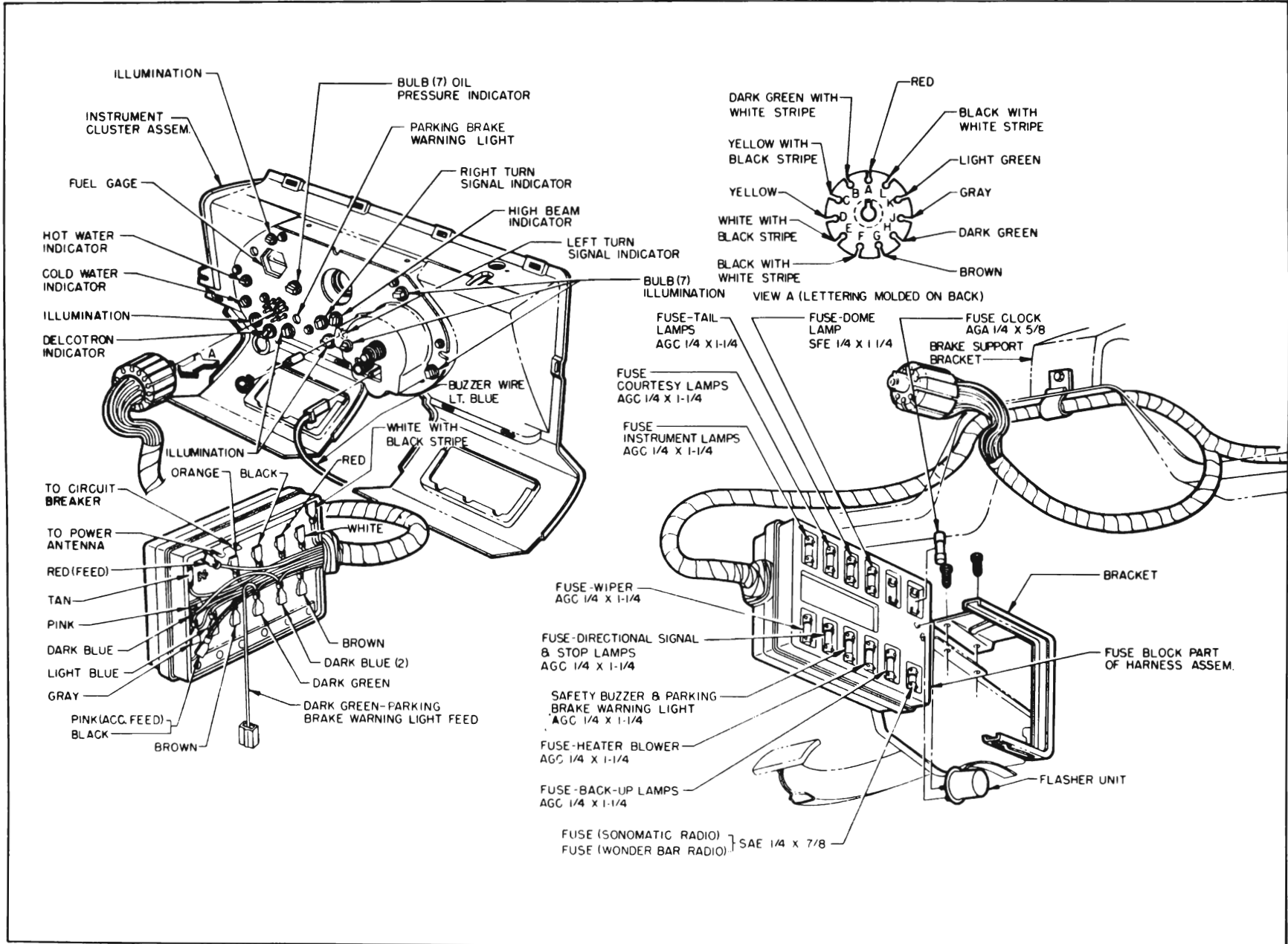

Figure 10-149—Instrument Cluster and Bulbs, Fuse Block and Fuses—Riviera

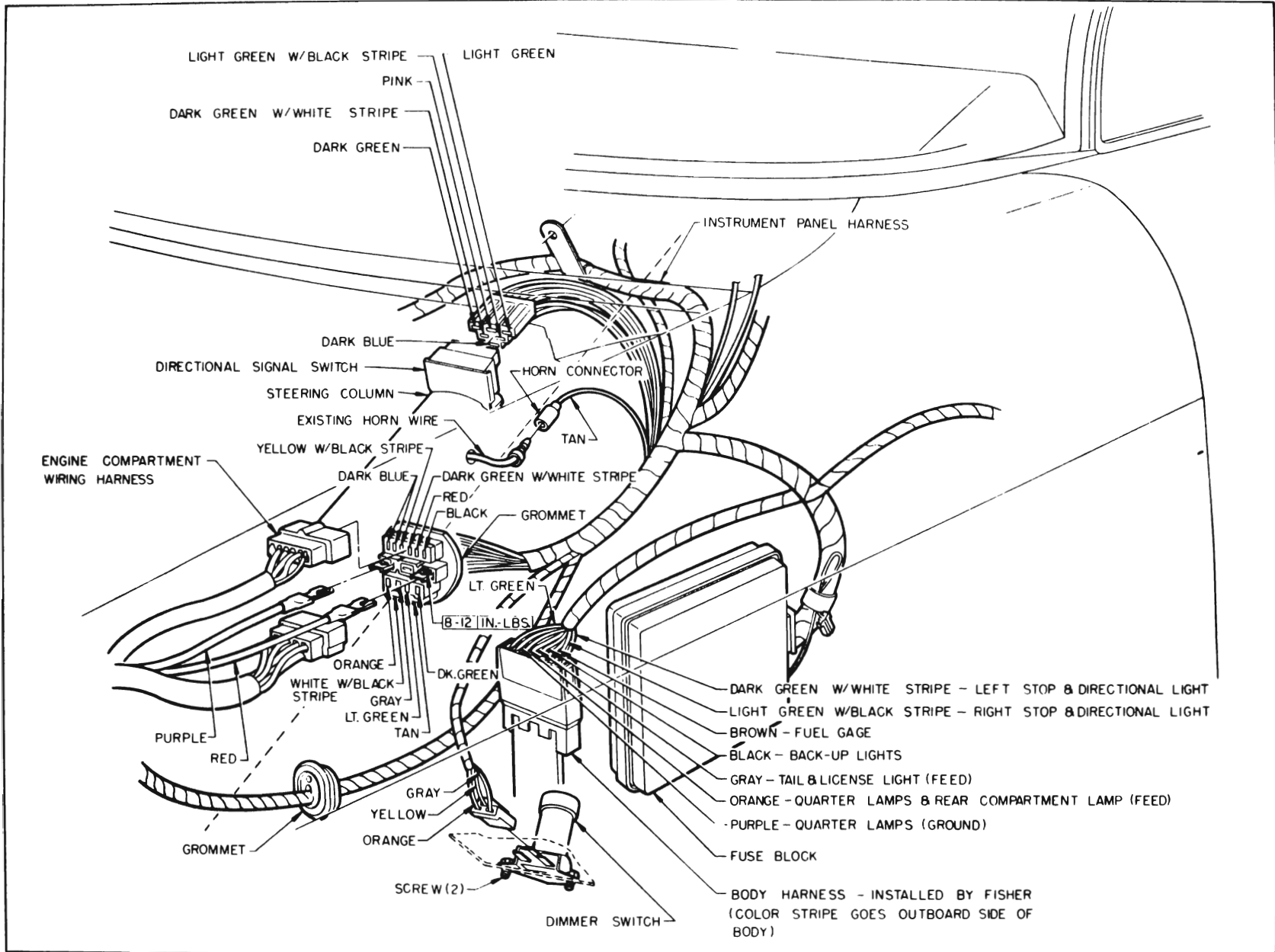

Figure 10-150—Bulkhead and Body Connectors, Turn Signal and Dimmer Switches—Riviera

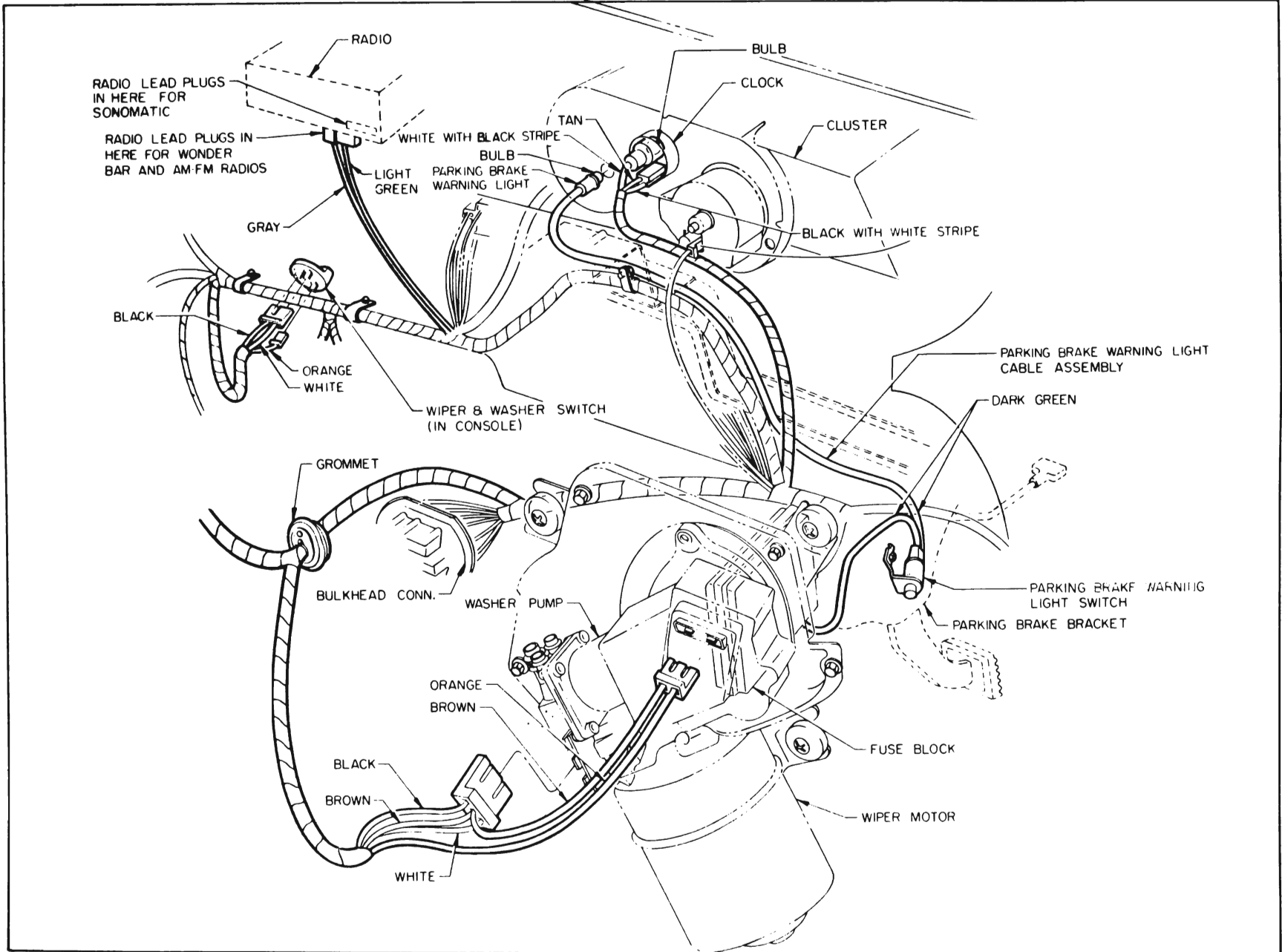

Figure 10-151—Radio, Clock, Parking Brake Warning Light and Wiper Connections—Riviera

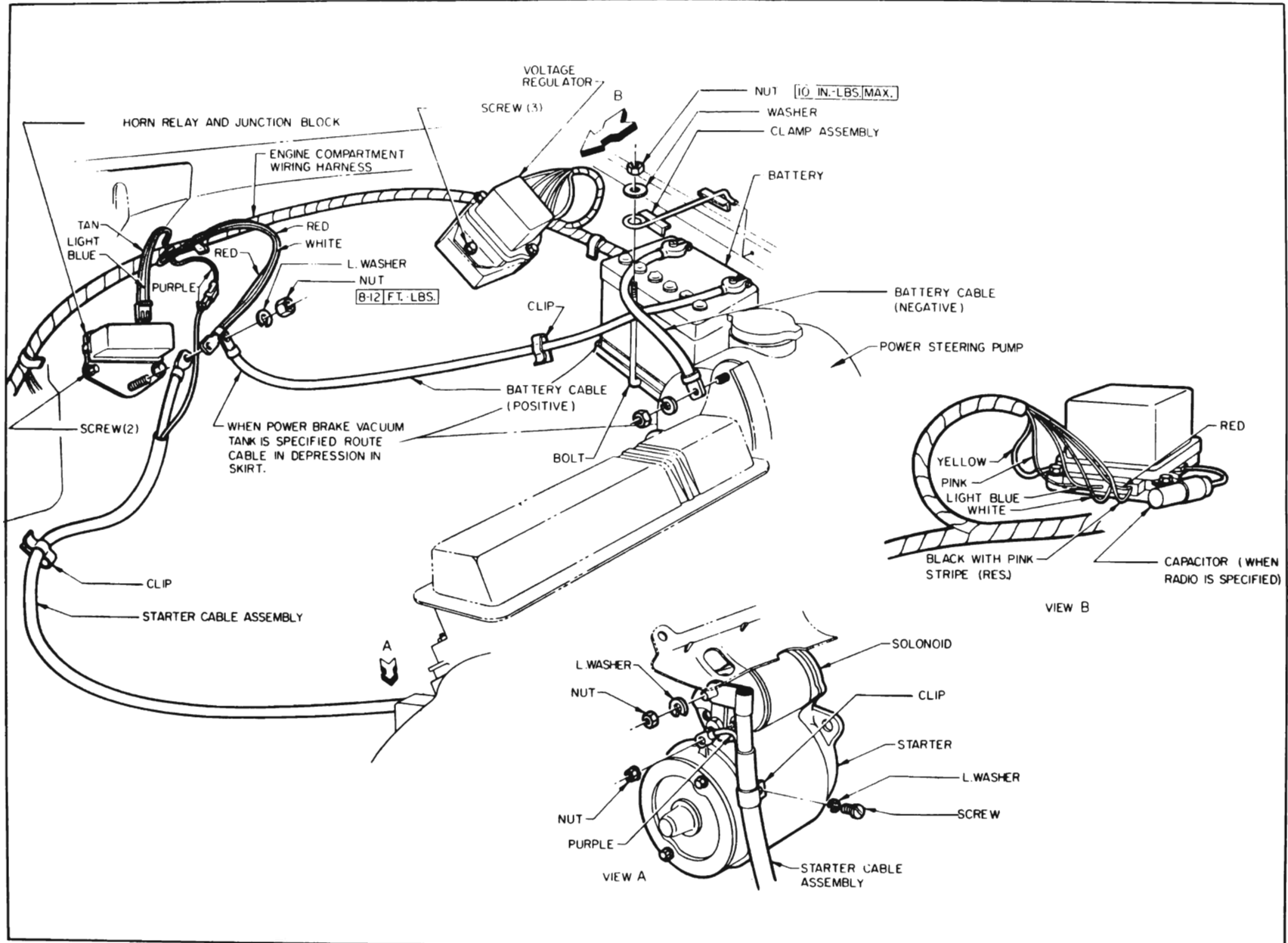

Figure 10-152—Starter, Battery, Voltage Regulator, Horn Relay and Junction Block—Riviera

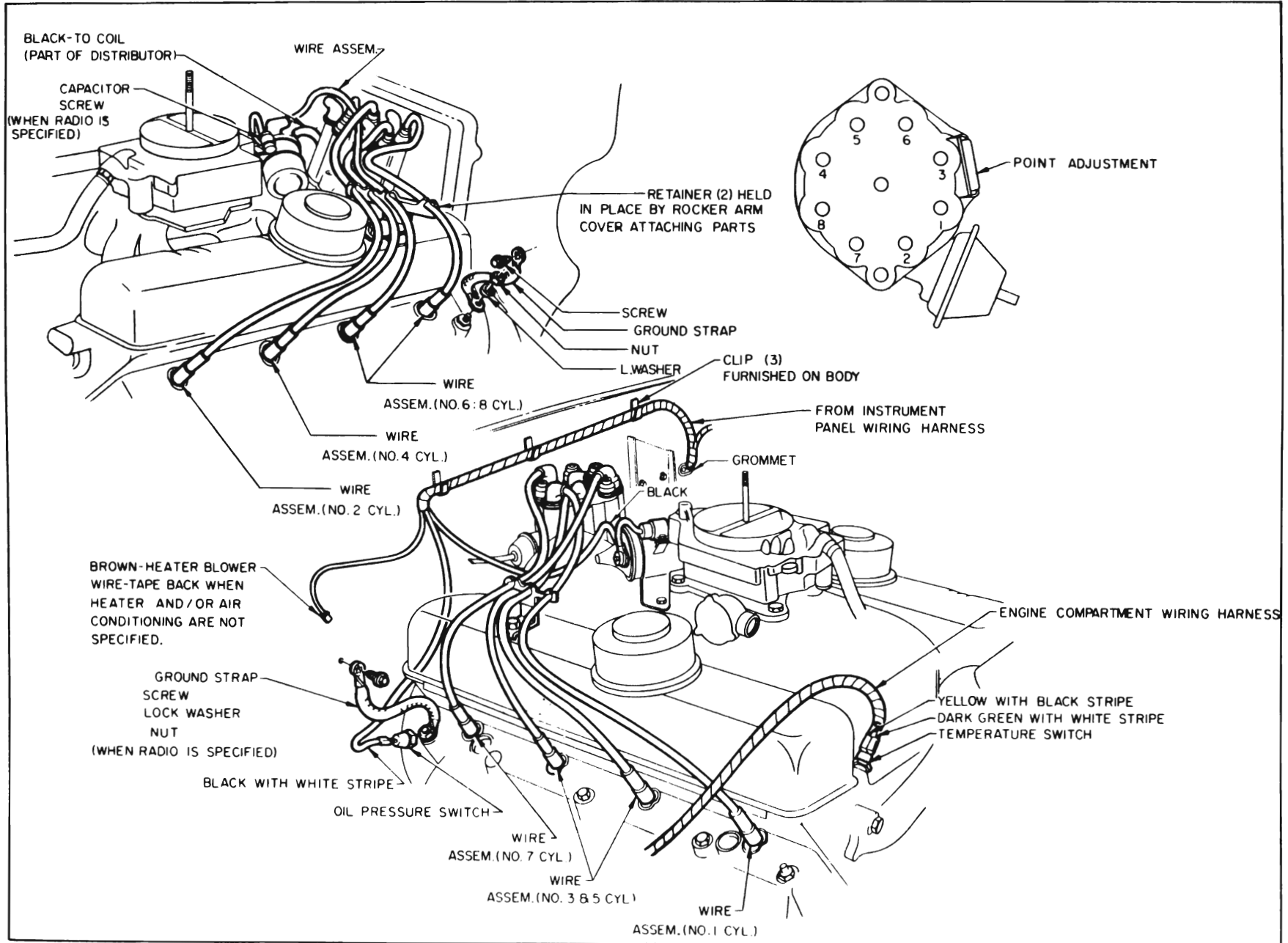

Figure 10-153—Engine Wiring—Riviera

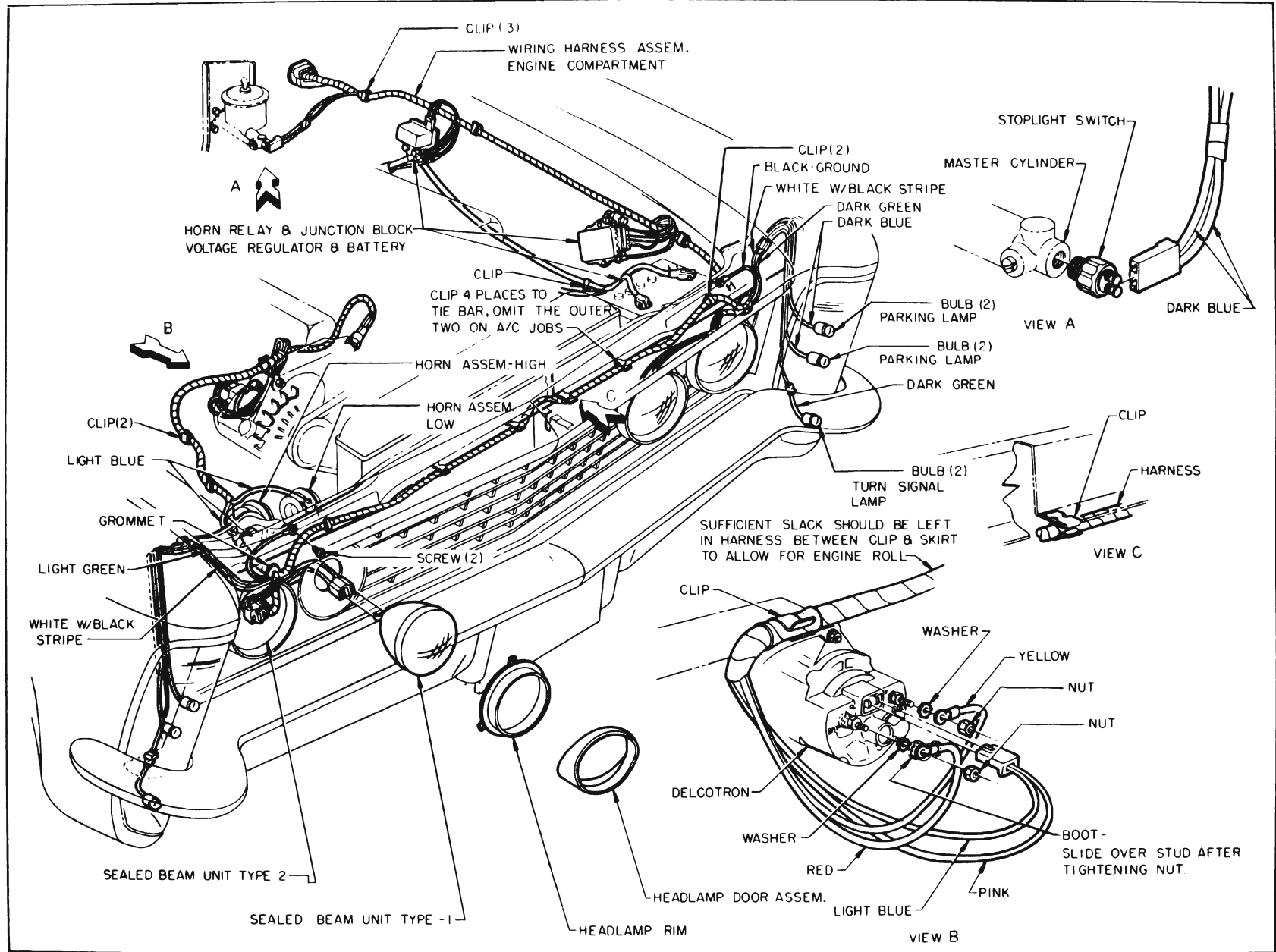

Figure 10-154—Front Lamp and Engine Compartment Wiring—Riviera

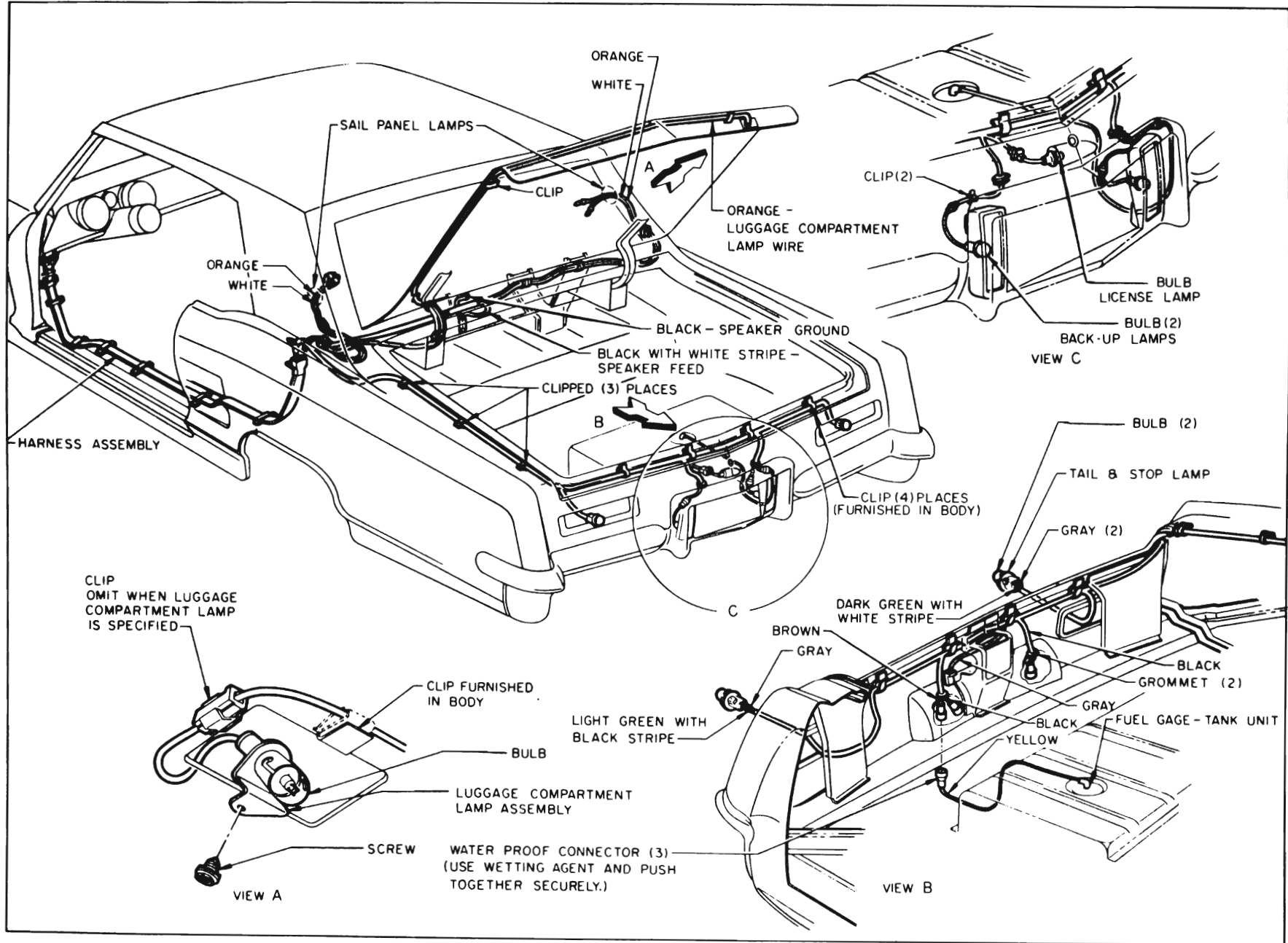

Figure 10-155—Rear Lamps and Fuel Gauge—Riviera

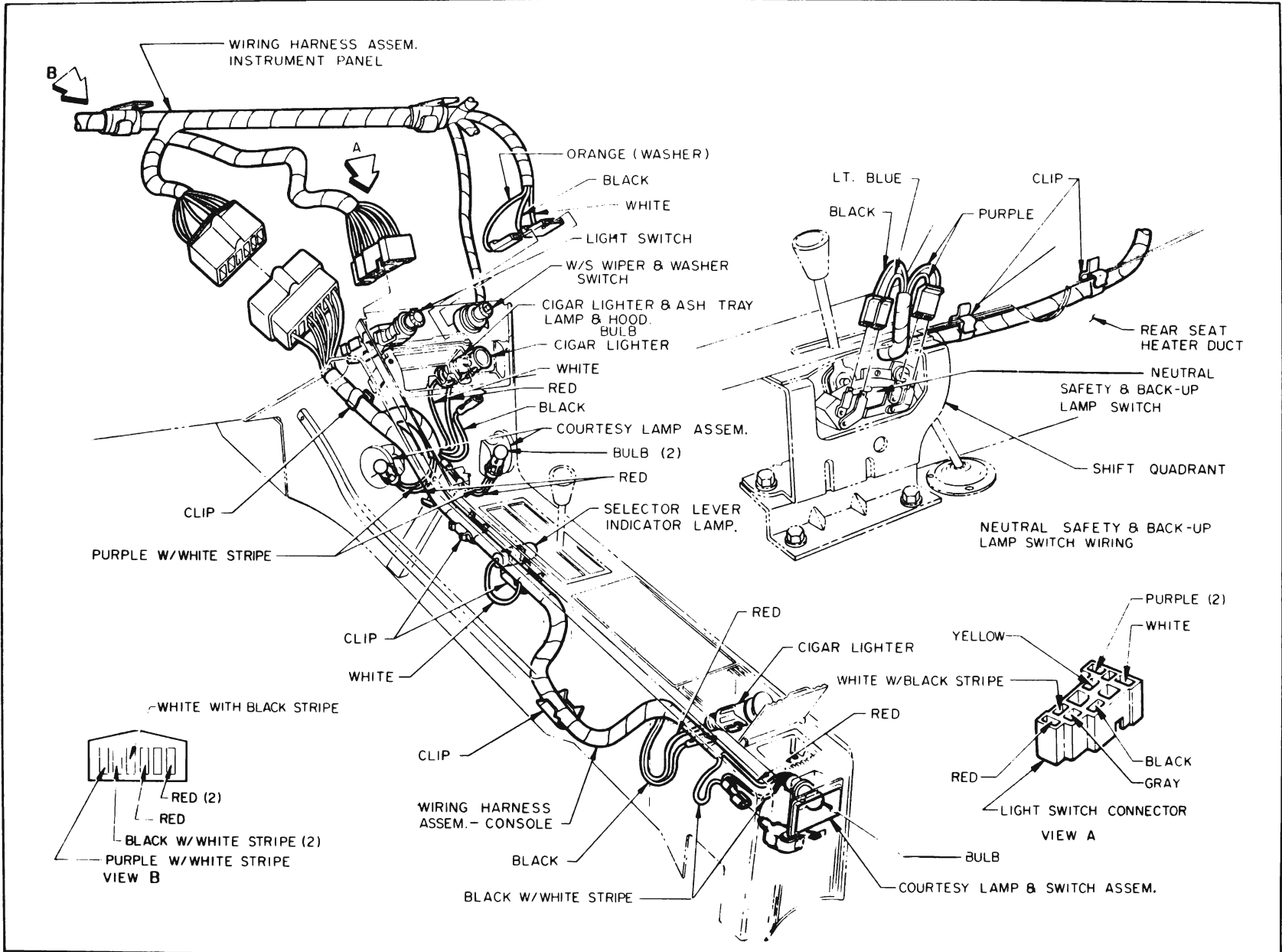

Figure 10-156—Console Wiring—Riviera

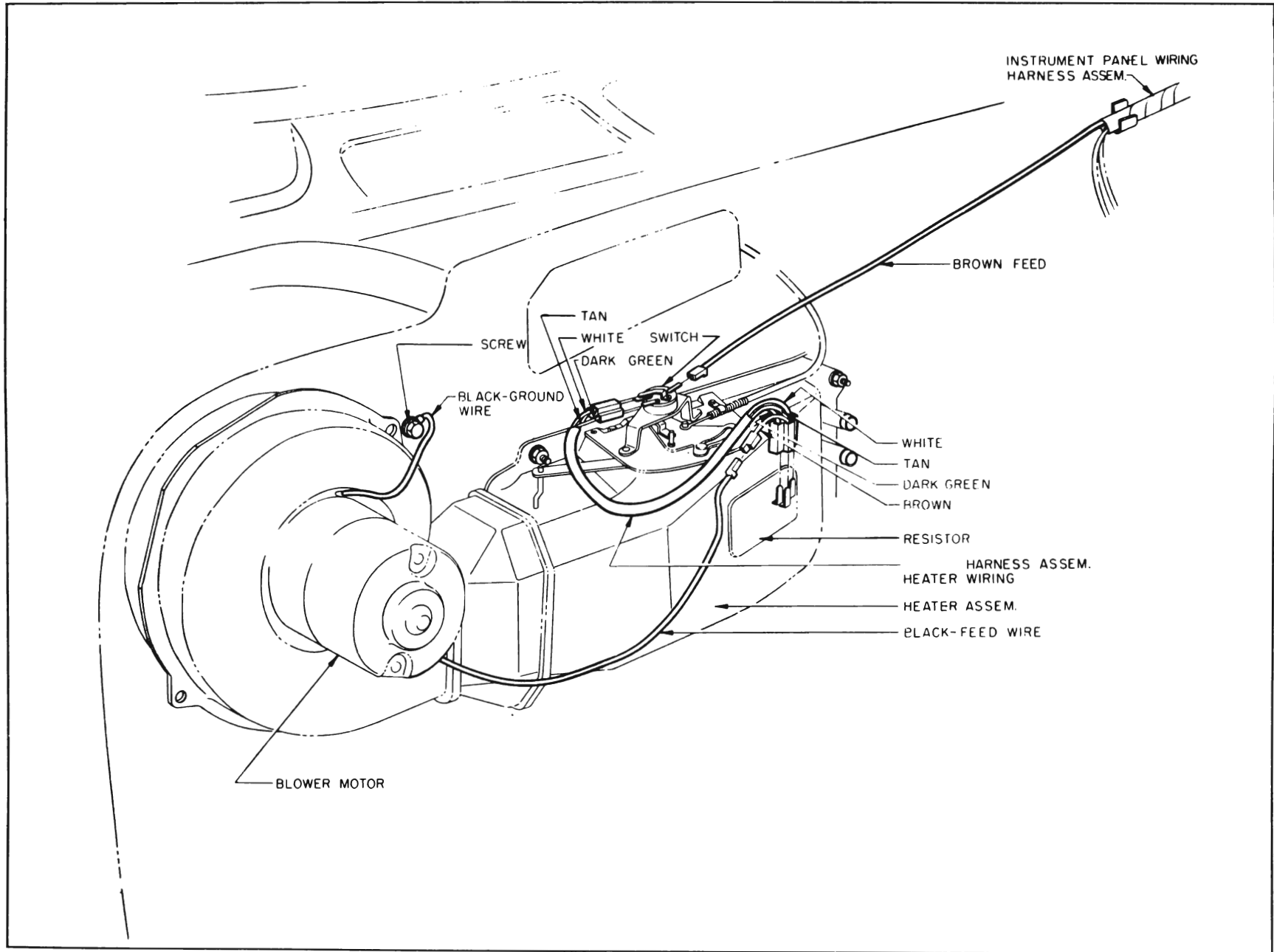

Figure 10-157—Heater—Riviera

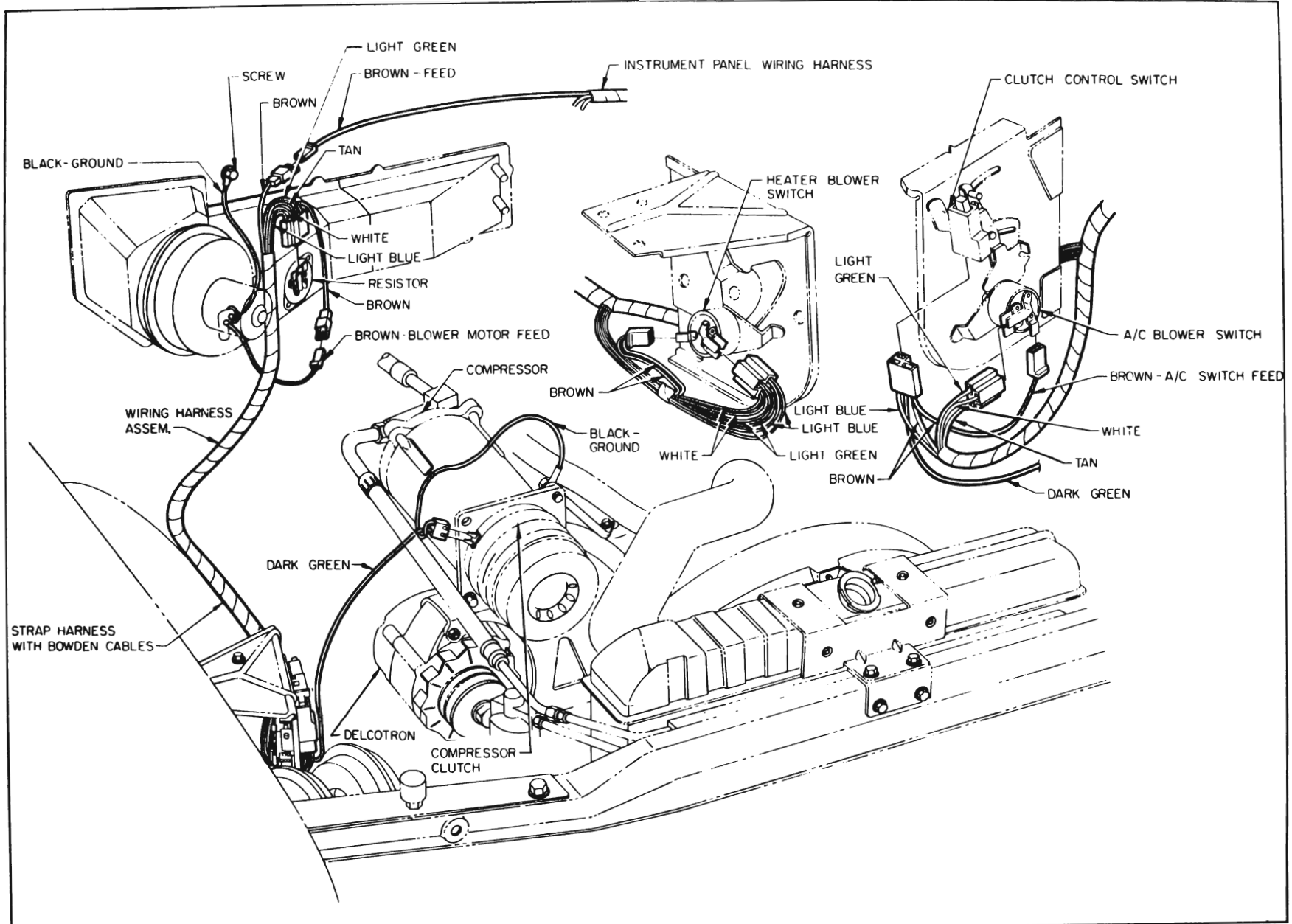

Figure 10-158—Air Conditioning Wiring—Riviera

