

SECTION 4-C

ESTATE WAGON TAIL GATE

CONTENTS OF SECTION 4-C

Paragraph	Subject	Page	Paragraph	Subject	Page
4-7	Description.....	4-17	4-10	Tail Gate Lock.....	4-24
4-8	Tail Gate and Hinges.....	4-17	4-11	Tail Gate Sealing.....	4-27
4-9	Tail Gate Window.....	4-19			

4-7 DESCRIPTION

All tail gates incorporate either a manually operated or electrically operated tail gate window which can be lowered into the tail gate or raised into the upper portion of the back body opening. The manually operated tail gate window is operated by means of a window regulator control handle (folding type) located in the tail gate outer panel. The electrically operated tail gate window can be operated from any one of two control switches: (1) control switch located on instrument panel; (2) lock cylinder control switch (key operated) located in tail gate outer panel. On three seat estate wagon styles, the electric window is standard. A switch located at the bottom of the gate prevents the up cycle operation of the electrically operated tail gate window when the tail gate is not completely closed.

After lowering the tail gate window, the tail gate can be opened by means of a tail gate lock remote control inside handle located at the tail gate belt finishing molding. The tail gate lock remote control incorporates a safety feature which prevents operation of the inside handle unless the tail gate window is in the full down position.

On the Estate Wagon the tail gate is counter-balanced by two torque rods extending between the tail gate hinges. They assist in opening and closing the tail gate. Figure 4-16 is a phantom view which identifies and shows the relationship of major component parts of the tail gate assembly.

4-8 TAIL GATE AND HINGES

a. Removal of Tail Gate Assembly

Due to the design of the tail gate hinges, the most practical method of removing the tail gate assembly from the body is to remove the tail gate from the hinges.

1. Remove rear bumper.

2. Disconnect the tail gate wiring harness inside the body. The connectors are located behind the left rear quarter trim panel. Disconnect the connectors and pull the wiring harness out of the body. Unhook it also from the two retaining clips on the body.

3. Open tail gate. Raise floor-to-tail gate filler panel and prop in up position.

4. Suitably support tail gate to facilitate detachment of tail gate supports; then remove support attaching screws (Figure 4-18) from both sides of the tail gate and fold tail gate support against the body.

5. Close the tail gate and mark the position of the tail gate hinge to facilitate installation in the same position.

6. Open the tail gate about 12 inches. The torque rods are now in a neutral position. Remove the torque rods while a helper steadies the tail gate. The torque rods are held in position by the small plate and bolt shown in Figure 4-17.

CAUTION: The tail gate now has no counter-balance - it is heavy.

7. Close the tail gate and remove the bolts attaching the hinges to the gate. (Figure 4-17)

8. With the aid of a helper open the gate slightly and lift the assembly upward to remove it from the hinges.

b. Installation of Tail Gate Assembly

To install tail gate assembly, first lubricate hinge pivot pin on both hinges with a dripless oil and apply a coat of heavy-bodied sealer to surface of hinge strap which contacts tail gate; then reverse removal procedure.

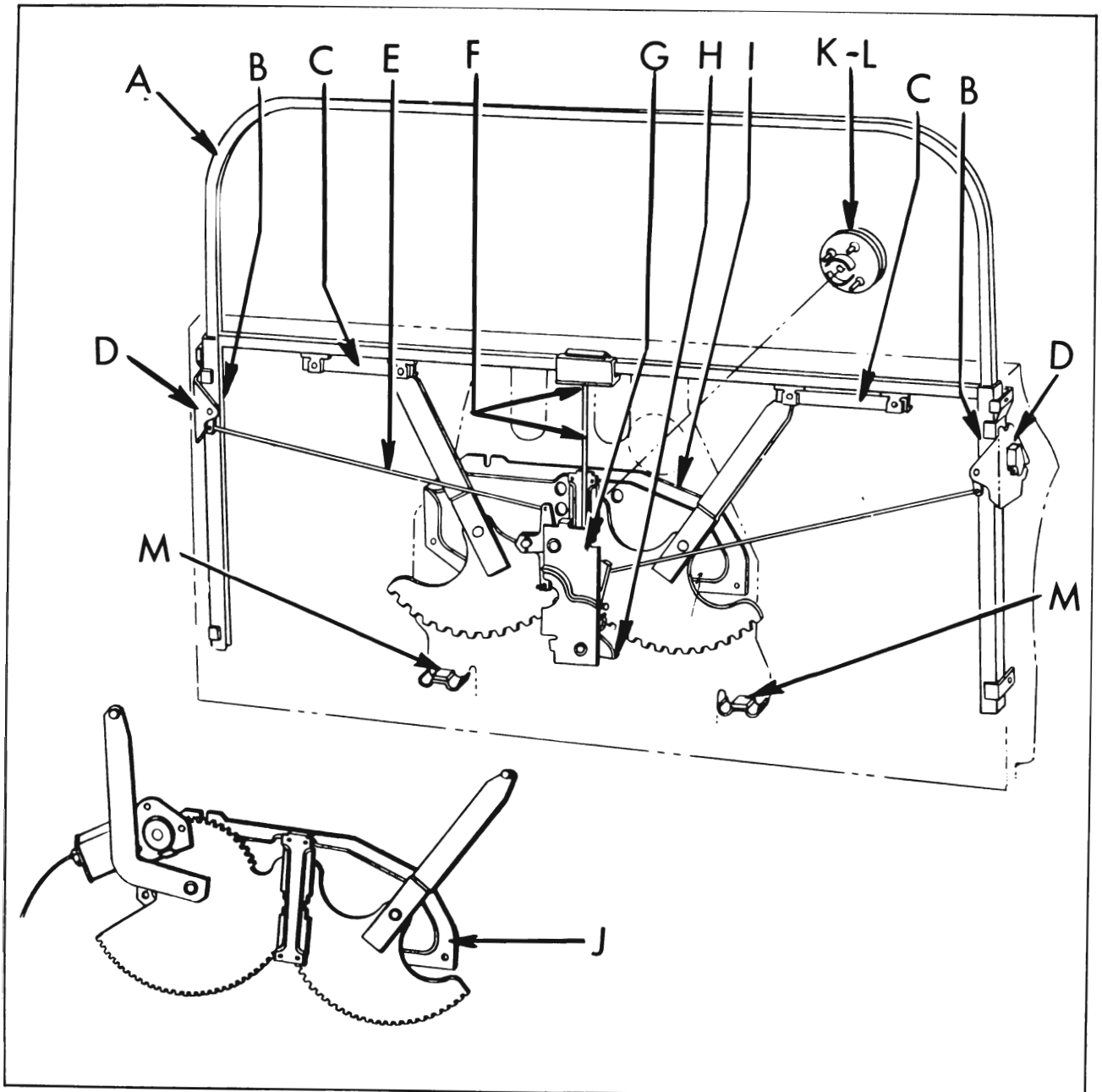

Figure 4-16—Tail Gate Assembly

c. Removal and Installation of Tail Gate Hinge Assembly

1. Remove tail gate assembly, as previously described.
2. Scribe or mark position of hinge to facilitate installation in same position.
3. Remove hinge attaching bolts and remove hinge from body side pillar.

4. To install tail gate hinge assembly, reverse removal procedure. Prior to installing hinge, coat attaching surface of hinge with heavy-bodied sealer. Install tail gate assembly as described under "Tail Gate Assembly - Installation".

d. Removal and Installation of Tail Gate Hinge Torque Rod

1. Remove rear bumper assembly from car.

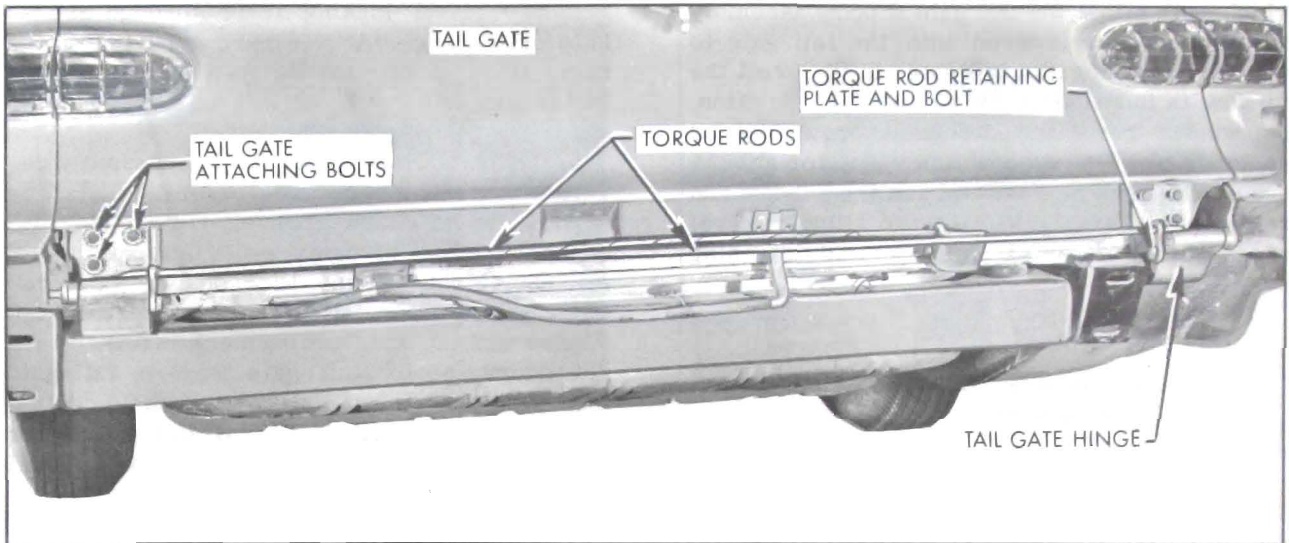

Figure 4-17—Tail Gate and Torque Rod Attachment

2. Remove torque rod side retainer at each tail gate hinge (Figure 4-17) and remove torque rod from body.

3. To install tail gate hinge torque rod, reverse removal procedure.

e. Removal and Installation of Tail Gate Support Assembly

1. Lower tail gate.

2. Suitably support tail gate to prevent damage to tail gate outer panel.

3. Remove tail gate support attaching screws securing support plates to body and tail gate (Figure 4-18) and remove support assembly.

4. To install tail gate support assembly, reverse removal procedure.

4-9 TAIL GATE WINDOW

a. Description

The tail gate has been designed to facilitate serving (lowering) the window in the event the tail gate cannot be opened due to an inoperative tail gate window. If this condition is encountered, first remove the tail gate follower board, then the tail gate inner cover panel can be removed, with the tail gate in the closed position, by removing the cover panel attaching screws and pulling the cover upwards to disengage cover from under lower retainer. The inner panel access hole covers and the window lower sash channel cams can then be removed

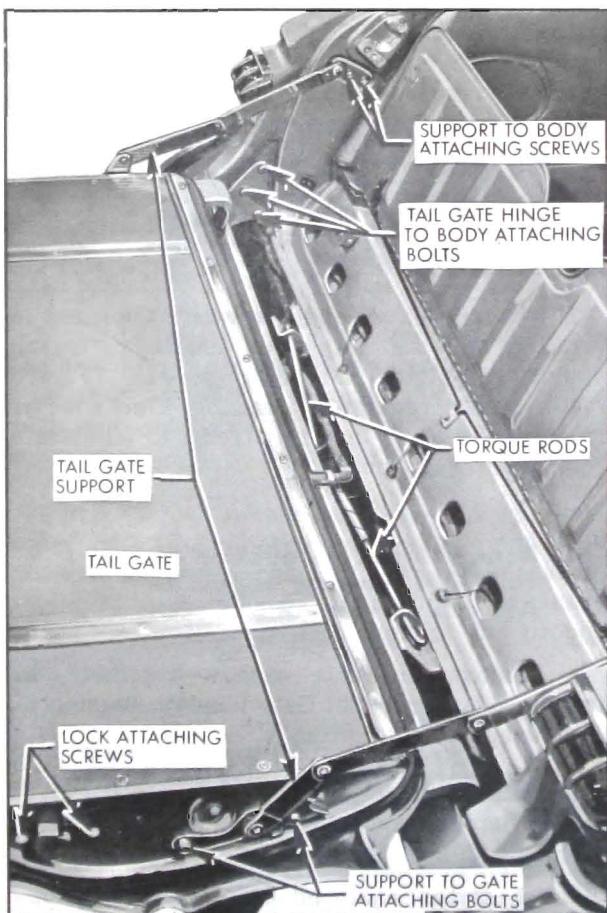

Figure 4-18—Tail Gate Support

which will allow the tail gate window assembly to be manually lowered into the tail gate to facilitate opening the tail gate. In the event the window is inoperative in the full "up" position, the window regulator attaching screws can be removed and the window and regulator attaching screws can be removed and the window and regulator lowered sufficiently to allow removal of the window lower sash channel cam attaching screws.

b. Removal and Installation of Tail Gate Assembly

1. Remove tail gate skid strips, tail gate inner cover panel finishing moldings and tail gate inner cover panel.

2. Detach tail gate inner panel water deflector sufficiently to gain access to window lower sash channel cam attaching bolts (Fig. 4-19). Remove tail gate inner panel access hole cover.

3. Carefully operate window upward until the window lower sash right and left cam attaching bolts are accessible through access holes, as shown in Figure 4-19.

4. Remove window lower sash channel right and left cam attaching bolts (Figure 4-19), disengage cams from window lower sash channel; then, carefully pull window assembly out of tail gate.

CAUTION: DO NOT OPERATE REGULATOR MOTOR after the window assembly is disengaged from the regulator or removed from the tail gate as operation of the motor with the load removed may damage the unit and make it inoperative.

NOTE: To open the tail gate when window assembly is removed, depress tail gate lock

remote control locking lever through access hole at location "A", (Figure 4-19) and at the same time operate the tail gate remote control inside handle.

5. To install tail gate window assembly reverse removal procedure. Prior to installing window lower sash channel cams, lubricate channel portion of cams with "Lubriplate" or its equivalent. Prior to resealing tail gate inner panel water deflector, check operation of window and tail gate locking mechanisms. Where necessary, adjust tail gate window, tail gate lock strikers or tail gate lock remote control for proper operation. Reseal tail gate inner panel water deflector as specified under "Tail Gate Inner Panel Sealing".

c. Tail Gate Window Adjustments

1. To adjust the tail gate window forward or rearward for proper alignment with the window glass run channels on the body and/or to eliminate a binding condition of the window in the tail gate glass run side channel(s) loosen lower attaching bolt at tail gate lock pillar; move lower end of channel forward or rearward, as required, and tighten lower attaching bolt.

NOTE: The vertical portion of the tail gate window glass upper run channels are adjustable forward or rearward for proper alignment with the tail gate glass.

2. To correct a condition where the glass is "cocked" in the glass run channels, loosen window regulator attaching screws (Figure 4-20), rotate regulator assembly clockwise or counterclockwise, as required, to eliminate "cocked" condition.

d. Removal and Installation of Tail Gate Window Regulator Assembly—Manual or Electric

1. Remove tail gate window assembly, as described under "Tail Gate Window Assembly—Removal and Installation".

2. Detach tail gate lock remote control right connecting rod from remote control at "A" (Figure 4-20).

3. On styles equipped with electrically operated tail gate window, disconnect tail gate harness connector from regulator motor.

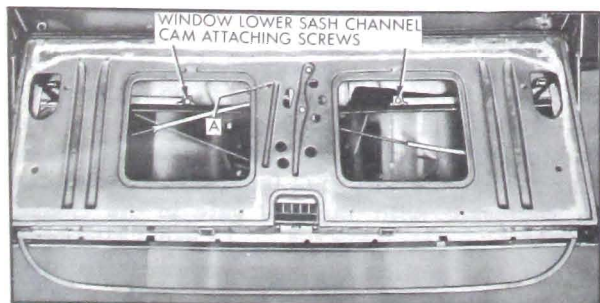

Figure 4-19—Tail Gate Window Removal

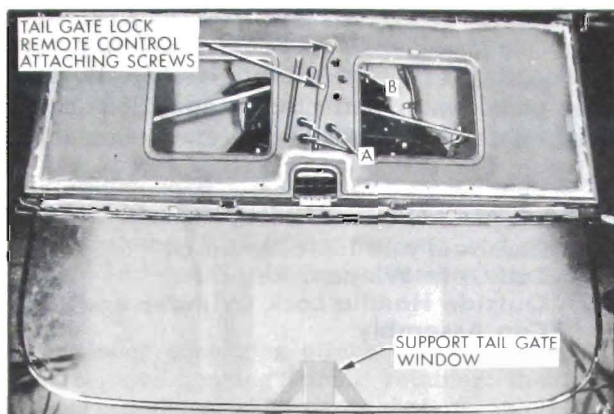

Figure 4-20—Window Regulator Removal

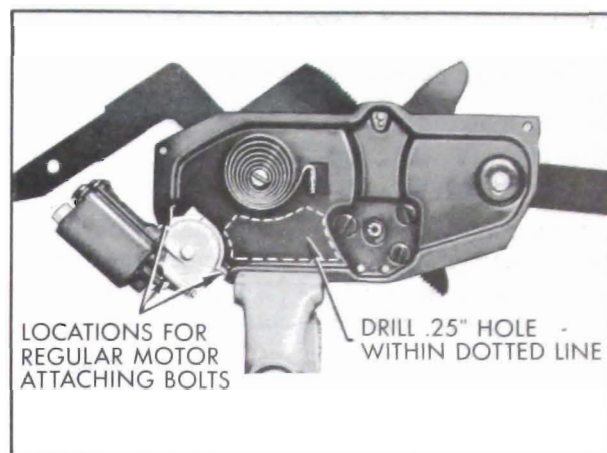

Figure 4-21—Window Regulator Motor Removal

CAUTION: DO NOT OPERATE REGULATOR MOTOR after window assembly is disengaged from the regulator or after the regulator is removed from the tail gate. Operation of the motor with the load removed may damage the unit and make it inoperative.

4. Remove regulator attaching screws through access holes at locations shown in Figure 4-20. Remove regulator assembly through large access hole.

NOTE: To remove electric motor from regulator assembly see "Tail Gate Window Regulator Electric Motor Assembly--Removal and Installation".

5. To install tail gate window regulator assembly, reverse removal procedure. Prior to installing regulator, lubricate the teeth on the regulator sectors with "Lubriplate" or its equivalent.

Prior to resealing tail gate inner panel water deflector, check operation of window and tail gate locking mechanism. Where necessary, adjust tail gate window, tail gate lock strikers or tail gate lock remote control for proper operation.

e. Removal and Installation of Tail Gate Window Regulator Electric Motor Assembly

1. Remove tail gate window regulator and electric motor assembly as described under "Tailgate Window Regulator Assembly--Removal and Installation".

2. Place regulator assembly in a vise as shown in Figure 4-21.

CAUTION: BE SURE to perform steps 3 and 4 before attempting to remove the motor from the regulator. The regulator lift arms which are under tension from the counterbalance spring can cause serious injury if the motor is removed without locking the sectors in position.

3. Drill a 1/4 inch hole through regulator backplate and main sector within area indicated by dotted lines (Figure 4-21).

NOTE: Do not locate hole less than 1/2 inch away from edge of backplate, sector or holes in backplate and sector. Do not use holes in backplate or sector as they are too large and locking bolt can slip out.

4. Insert a 3/16 inch bolt through hole in backplate and sector and install nut to bolt. (Do not tighten nut).

5. Remove three (3) motor attaching bolts, at locations shown in Figure 4-21, and remove motor assembly from regulator.

NOTE: Clean off steel chips from the regulator sectors and motor pinion gear after drilling operation.

6. To install regulator electric motor assembly, reverse removal procedure.

NOTE: Be sure to remove nut and bolt locking sector after motor is installed.

f. Removal and Installation of Tail Gate Window Regulator Outside Handle Assembly

1. Remove tail gate skid strips, tail gate inner cover panel finishing moldings and tail gate inner cover panel.

2. Detach tail gate inner panel water deflector sufficiently to gain access to access holes, shown at "B" in Figure 4-20, for removal of handle attaching nuts.

3. Carefully raise window until holes in window regulator are aligned with inner panel access holes, shown at "B" in Figure 4-20, for removal and installation of outside handle attaching nuts.

CAUTION: Support portion of window assembly extending out of tail gate (Figure 4-20).

4. Through access holes, shown at "B" in Figure 4-20, remove tail gate handle attaching nuts and remove handle assembly and gasket from tail gate. To assemble tail gate handle assembly, see "Tail Gate Handle Assembly--Disassembly and Assembly".

5. To install tail gate handle assembly, reverse removal procedure. Make sure sealing gasket is installed between tail gate outer panel and handle escutcheon and make sure handle

clutch is properly engaged with window regulator clutch. Check operation of window prior to resealing water deflector. Reseal tail gate inner panel water deflector as specified under "Tail Gate Inner Panel Water Deflector".

g. Removal and Installation of Tail Gate Window Regulator Outside Handle Lock Cylinder and Cap Assembly

1. Using an awl or suitable punch, carefully punch through webbed hole in face of lock cylinder cap (selector lever).

2. With key in lock cylinder and selector lever in "Lock" position insert a piece of wire (paper clip) in hole on face of lock cylinder cap (selector lever) and depress plunger with wire sufficiently to allow key and selector lever to be turned counterclockwise approximately 1/8 turn; then, remove lock cylinder and cap assembly.

3. To install lock cylinder and cap assembly, reverse removal procedure. Prior to installation, lubricate frictional surfaces of lock cylinder and cap parts with "Lubriplate" or its equivalent.

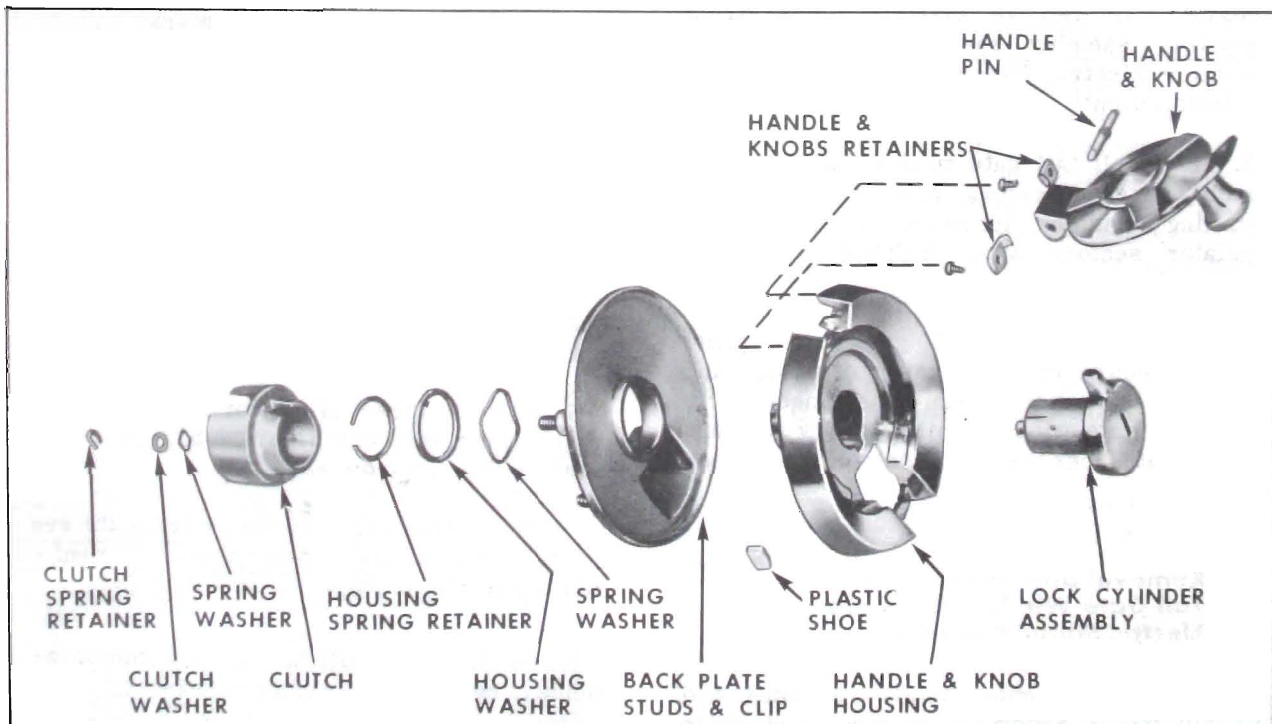

Figure 4-22—Disassembly of Window Regulator Outside Handle

h. Disassembly and Assembly of Tail Gate Window Regulator Outside Handle Assembly

1. Remove window regulator handle assembly.
2. Using a hooked tool or other suitable tool, remove clutch spring retainer; then remove clutch washer and spring washer, and remove clutch and lock cylinder assembly from unit (Figure 4-22).
3. Using snap ring pliers or other suitable tool remove housing spring retainer; then remove housing washer and spring washer, and remove back plate from handle and knob housing (Figure 4-22).

NOTE: Plastic shoes can be removed from handle and knob housing by carefully prying shoes from housing (Figure 4-22).

4. If replacing handle and knob assembly remove screws securing handle and knob retainers; then disengage handle and knob including handle pin from housing (Figure 4-22).

5. To install handle assembly, reverse removal procedure. Prior to installation, lubricate frictional surfaces of parts with "Lubriplate" or its equivalent.

i. Disassembly and Assembly of Tail Gate Window Regulator Outside Handle Lock Cylinder and Case Assembly

1. Using an awl or suitable punch, carefully punch through webbed hole in face of lock cylinder cap (selector lever). Remove window regulator handle assembly.

2. Using an awl or other suitable tool, remove clutch spring retainer; then remove clutch washer and spring washer and remove clutch and lock cylinder assembly from unit (see Figure 4-22).

3. Insert a piece of wire (paper clip) in hole on face of lock cylinder cap (selector lever). While holding lock cylinder case, depress plunger with wire sufficiently to allow key and selector lever to be turned counterclockwise approximately 1/8 turn; then, remove lock cylinder and cap (selector lever) assembly from handle assembly (Figure 4-23).

NOTE: When removing lock cylinder and cap assembly from case, place finger over locking pawl to prevent pawl and spring from popping out (Figure 4-23).

4. Remove locking pawl and pawl spring from lock cylinder case.

5. To install lock cylinder and case assembly, reverse removal procedure. Prior to installation, lubricate frictional surfaces of parts with "Lubriplate" or its equivalent.

j. Removal and Installation of Tail Gate Electric Window Lock Cylinder, Switch and Escutcheon Assembly

1. Remove tail gate skid strips, tail gate inner cover panel finishing moldings and tail gate inner cover panel.

2. Detach tail gate inner panel water deflector sufficiently to gain access to access holes, shown at "B" in Figure 4-20, for removal of assembly attaching nuts.

3. Carefully operate window upward until holes in window regulator assembly are aligned with inner panel access holes, shown at "B" in Figure 4-20, for removal and installation of attaching nuts.

CAUTION: Support portion of window extending out of tail gate.

4. Through access holes, shown at "B" in Figure 4-20, remove lock cylinder, switch and escutcheon assembly attaching nuts. Detach assembly from tail gate outer panel sufficiently to disconnect junction block from switch; then, remove assembly and gasket from tail gate.

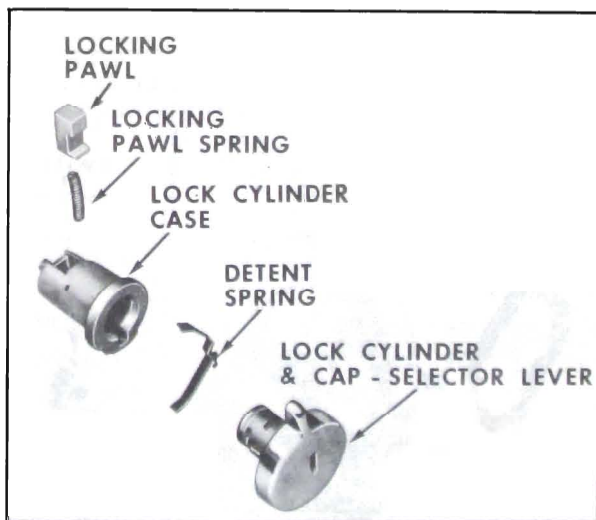

Figure 4-23—Disassembly of Outside Handle Lock Cylinder and Case

To disassemble electric window lock cylinder, switch and escutcheon assembly see "Electric Window Lock Cylinder, Switch and Escutcheon Assembly - Disassembly and Assembly".

k. Removal and Installation of Tail Gate Electric Window Lock Cylinder and Switch Assembly

1. Remove tail gate electric window lock cylinder, switch and escutcheon assembly.
2. Disengage lock cylinder and switch retainer (Figure 4-24) and remove lock cylinder and switch assembly from escutcheon.
3. To install lock cylinder and switch assembly, reverse removal procedure.

Disassembly and Assembly

1. Using a pointed tool inserted through holes in lock cylinder case, depress tab of switch clips and remove clips (Figure 4-24).
2. Carefully pull switch and switch cam from lock cylinder case (Figure 4-24).
3. Using a suitable tool, bend out crimped flange of lock cylinder case cap sufficiently to remove cap; then remove lock cylinder cap and springs.

NOTE: The crimped flange on production lock cylinder case caps necessitates damaging cap during removal from lock cylinder case;

however, service replacement caps are available which have four (4) bend over tabs for installation.

4. To assemble lock cylinder and switch assembly, reverse removal procedure. Prior to installation, lubricate frictional surfaces of lock cylinder and switch parts with "Lubriplate" or its equivalent. Install a new service replacement lock cylinder case cap.

4-10 TAIL GATE LOCK

a. Removal and Installation of Tail Gate Lock Assembly—Right or Left

1. Remove tail gate window assembly.
2. Remove tail gate window glass run side channel attaching screws (Figure 4-18) and remove channel from side of tail gate from which lock is being removed.
3. Disengage spring clip and detach lock remote control connecting rod from lock remote control (see Figure 4-).
4. Remove tail gate lock attaching screws (Figure 4-18) and remove tail gate lock with attached connecting rod from tail gate; then detach connecting rod from lock.
5. To install tail gate lock assembly, reverse removal procedure. Prior to installing lock assembly into tail gate, apply a bead of body caulking compound to lock frame along the joint of the lock bolt housing, as indicated at "1" in Figure 4-25.

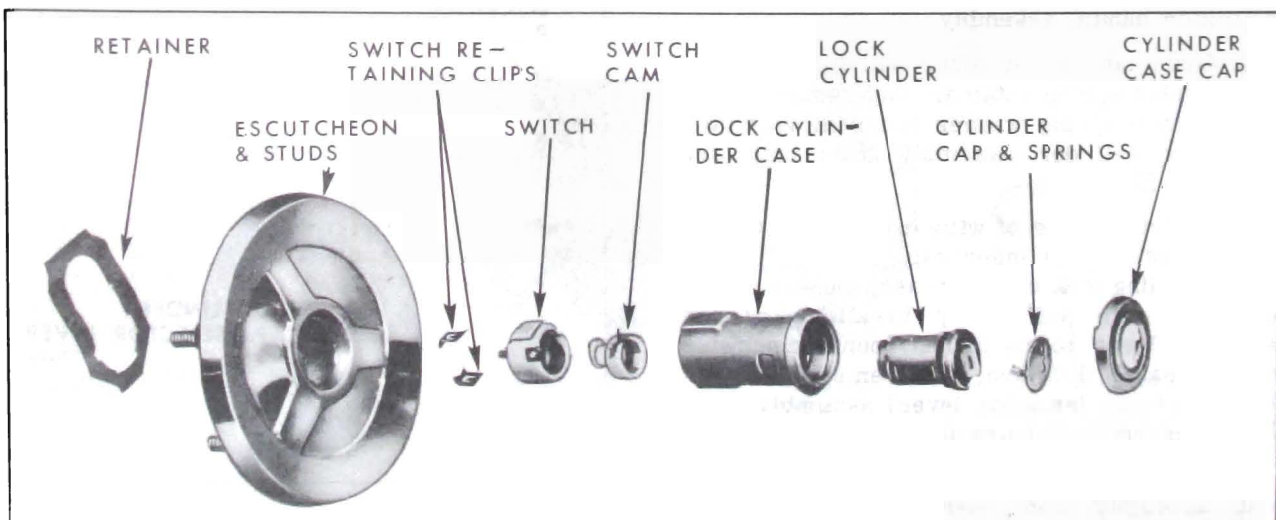

Figure 4-24—Disassembly of Window Electric Lock Cylinder and Switch

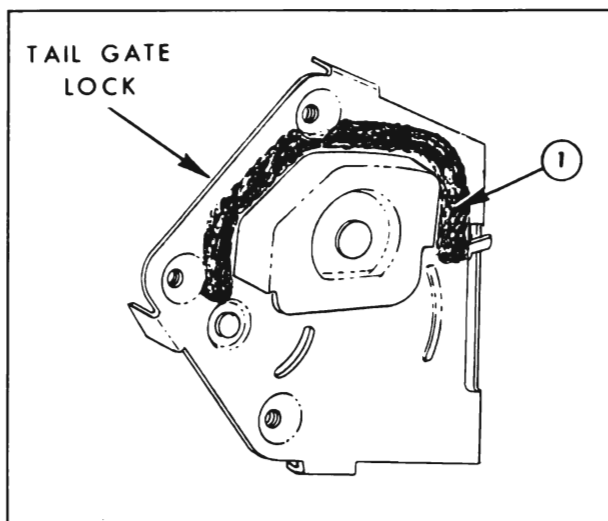

Figure 4-25—Tail Gate Lock Sealing

To attach lock connecting rod to remote control lever, first loosen connecting rod adjustment locking bolt at remote control (see Figure 4-28); then, install rod to lever and tighten locking bolt.

NOTE: Check clips at ends of remote control levers for proper retention of connecting rods and replace if necessary.

Prior to resealing water deflector, check operation of tail gate locking mechanism.

b. Removal and Installation of Tail Gate Lock Striker

1. Open tail gate with pencil, mark position of striker on body pillar.

2. Remove lock striker attaching screws and remove striker and adjusting plates from body pillar.

3. To install tail gate lock striker, place striker and adjusting plates within marks on body pillar and install striker attaching screws.

c. Tail Gate Lock Striker Adjustments

1. To adjust the tail gate lock striker up or down or forward or rearward, loosen striker attaching screws, shift striker and adjusting plates to desired position, then tighten striker attaching screws.

2. **DIMENSIONAL SPECIFICATIONS FOR USE OF DOOR LOCK STRIKER EMERGENCY SPACERS.**

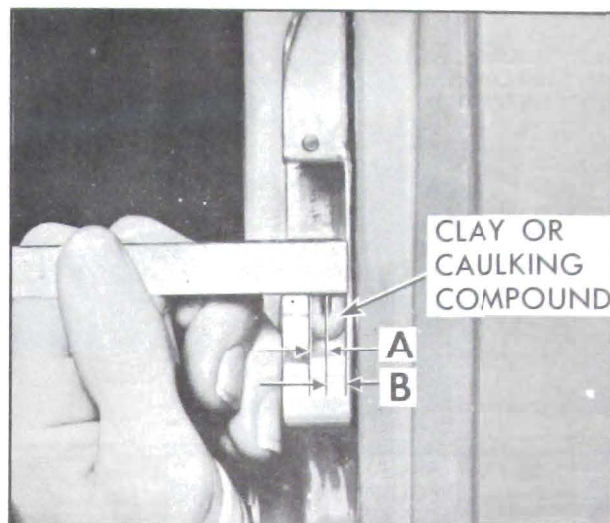

Figure 4-26—Striker Engagement Check

a. Tail gate should be properly aligned before checking spacer requirements.

b. To determine if tail gate lock striker emergency spacers are required, apply molding clay or body caulking compound in the lock striker notch where the lock extension engages and then close the tail gate to form a measurable impression in the clay or caulking compound, as shown in Figure 4-26.

When dimension "A" from inside face of striker teeth to center of lock extension is less than $\frac{3}{16}$ " install emergency spacers and proper length striker attaching screws as directed.

Dimension "A"	No. of Spacers Required	Spacer Thickness	Striker Attaching Screws*
$\frac{3}{16}$ " to $\frac{1}{8}$ "	1	$\frac{1}{16}$ "	Original Screw
$\frac{1}{8}$ " to $\frac{1}{16}$ "	1	$\frac{1}{8}$ "	Emergency Screw (1/8" longer)
$\frac{1}{16}$ " to 0	1 (1/8" Spacer) 1 (1/16" Spacer)	$\frac{3}{16}$ " (Total)	Emergency Screw (1/4" longer)
0 to $\frac{1}{16}$ " Interference	2 (1/8" Spacers)	$\frac{1}{4}$ " (Total)	Emergency Screw (1/4" longer)

* Zinc or cadmium-plated flat-head cross-recess screw with countersunk washer.

NOTE: Dimension "B" from center of lock extension to inside face of striker should never be less than $\frac{1}{16}$ ".

d. Removal and Installation of Tail Gate Lock Remote Control Inside Handle Assembly

1. Remove tail gate belt finishing molding and tail gate inner cover panel. Detach inner

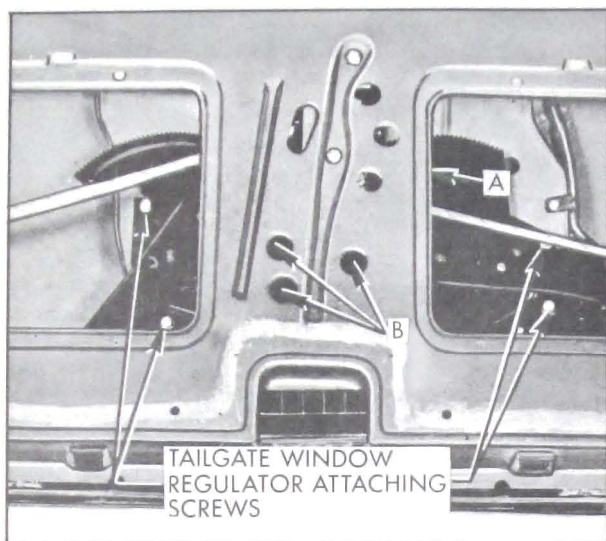

Figure 4-27—Tail Gate Window Regulator Attachment

panel water deflector sufficiently to gain access to inner panel.

2. Loosen tail gate lock remote control attaching screws (Figure 4-27) and move remote control towards bottom of tail gate sufficiently to disengage end of handle push rod from hole in remote control lever.

NOTE: In some instances it may be necessary to reach into tail gate and actuate remote control lever to disengage push rod from lever.

3. Remove handle attaching screws located under handle (Figure 4-27) and remove handle assembly (includes push rod) from tail gate.

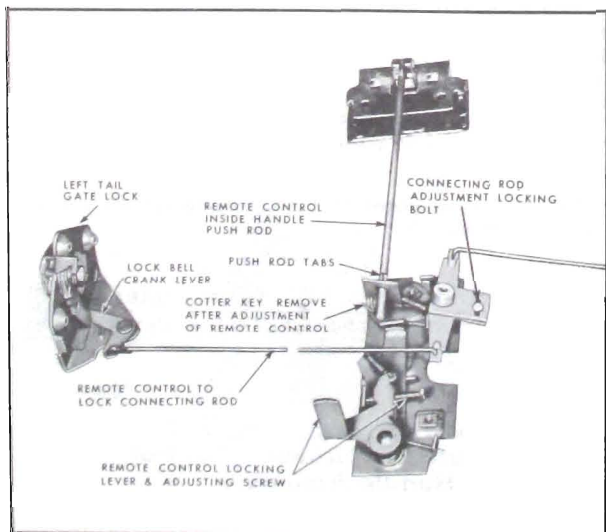

Figure 4-28—Tail Gate Lock Remote Control

4. To install tail gate lock remote control handle assembly, reverse removal procedure. Lubricate frictional points of inside handle assembly with "Lubriplate" or its equivalent.

NOTE: To engage end of handle push rod into hole in remote control lever, it may be necessary to raise window in tail gate to gain access to lever. Adjust remote control upward until tabs on handle push rod (see Figure 4-28) just contact remote control lever.

Prior to resealing tail gate inner panel water deflector check operation of tail gate lock mechanism and, where necessary, adjust door lock strikers or remote control for proper operation.

e. Removal of Tail Gate Lock Remote Control Assembly

1. Remove tail gate window assembly.

2. Disengage clips securing lock connecting rods to remote control (Figure 4-28) and detach connecting rods from remote control.

3. Remove tail gate lock remote control attaching screws (Figure 4-27). Disengage remote control from inside handle push rod and remove remote control from tail gate.

f. Installation of Tail Gate Lock Remote Control Assembly

1. Engage inside handle push rod into hole in remote control attaching screws.

2. Adjust remote control assembly up or down until tabs on push rod (see Figure 4-28) just contact remote control attaching screws.

3. To attach lock connecting rods to remote control lever, first loosen connecting rod adjustment locking bolt (see Figure 4-28); then, install rods to levers and tighten locking bolt.

NOTE: Check clips at ends of remote control levers for proper retention of connecting rods and replace, if necessary.

IMPORTANT: If installing a new remote control assembly, remove cotter key (see Figure 4-28), after adjustment, to free locking lever.

4. Check operation of tail gate locking mechanism. To open tail gate when window assembly is removed, depress tail gate lock remote control locking lever at location "B" (Figure 4-27) and at the same time operate the tail gate remote control inside handle.

5. Install tail gate window assembly, as described under "Tail Gate Window Assembly-Installation".

6. Lower window to just below the tail gate window side reveal moldings then adjust remote control locking lever adjusting screw (Figure 4-28) so that lever is just contacting window lower sash channel frame. Check operation of remote control inside handle - handle should remain locked until window upper sash channel frame is below tail gate side reveal moldings.

4-11 TAIL GATE SEALING

a. Description of Tail Gate Inner Panel Water Deflector

On all station wagon styles a waterproof paper tail gate inner panel water deflector is sealed to the tail gate inner panel and deflects water into the bottom of the tail gate where it can drain out the bottom drain holes. The bottom of the water deflector is sealed to the inner panel in a manner that will deflect water towards designated access holes where the water can readily enter into the bottom of the tail gate.

IT IS IMPORTANT THAT WHENEVER ANY WORK IS PERFORMED ON THE TAIL GATE WHERE THE WATER DEFLECTOR HAS BEEN DISTURBED, THE DEFLECTOR MUST BE PROPERLY SEALED TO THE TAIL GATE INNER PANEL.

b. Removal or Partial Detachment of Water Deflector

1. Remove tail gate inner cover panel lower retainer and inner cover panel.

2. Using a sharp scraper or other suitable tool carefully lift up edge of deflector and detach sealer and water deflector as required.

NOTE: DO NOT TEAR WATER DEFLECTOR.

c. Installation or Resealing Procedure of Water Deflector

1. If installing old deflector or resealing partially detached deflector first inspect water deflector for any tears or holes and, where necessary, repair any tears or holes with

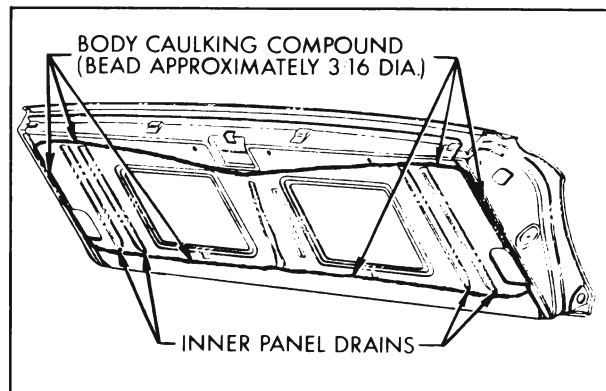

Figure 4-29—Tail Gate Water Deflector Sealing

water proof body tape applied to both sides of deflector.

2. If installing new deflector use old deflector or tail gate inner panel to trim new deflector to proper size.

3. Apply a bead of body caulking compound (approximately 3/16" diameter) to tail gate inner panel along a line as indicated in Figure 4-29.

IMPORTANT: The body caulking compound should be applied along the lower portion of the tail gate exactly as shown in illustration to assure proper drainage of water through inner panel access holes into bottom of tail gate.

4. Position water deflector to tail gate inner panel with polyethylene coated side of deflector against inner panel. Firmly press or roll sealed areas to obtain a good bond between deflector and tail gate inner panel.

5. Clean off all excess caulking compound; then install previously removed tail gate inner cover panel.

d. Removal of Tail Gate Weatherstrip

1. Remove tail gate belt finishing molding.

At both sides of tail gate disengage snap fasteners upper ends of weatherstrip.

2. With a sharp scraper, carefully break cement bond securing weatherstrip along tail gate lock pillars.

3. Insert tip of mechanically-retained weatherstrip inserting tool J-5757, or any other suitable tool, at clip locations and carefully snap clips from retaining holes and remove weatherstrip from tail gate.

e. Installation of Tail Gate Weatherstrip

1. Clean off old cement to insure a clean cementing surface.

2. Check weatherstrip clips for proper contour and reform clips, if necessary, using clip reforming tool J-5984 (Figure 4-30).

3. Check weatherstrip clip hole sealing plugs along bottom of tail gate for cracks or damage and replace, where necessary.

NOTE: If sealing plugs are loose and will not remain engaged in panel, install a 1/2" x 1" piece of cloth backed waterproof body tape over sealing plug retaining hole, as shown in Section "A-A" (Figure 4-31) to form an "X" pattern. Check sealing plug for snug fit. If plug is still loose, repeat above operation by installing second piece of tape over existing repair.

4. Apply (brush coat) weatherstrip adhesive (neoprene type) on face of rabbet contacted by weatherstrip along full length of lock pillar as indicated at "1" in Section "B-B" (Figure 4-31).

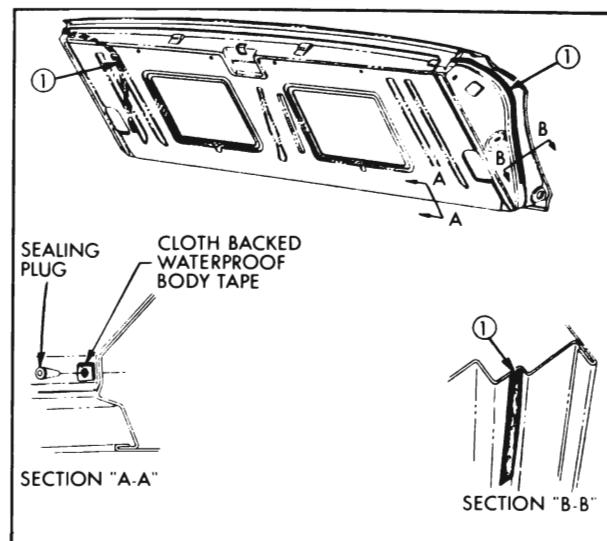

Figure 4-31—Tail Gate Weatherstrip Installation

5. Properly position weatherstrip to tail gate. Install weatherstrip clips into retaining holes using Weatherstrip Inserting Tool J-5757. Press or roll cemented areas to assure a good cement bond.



Figure 4-30—Reforming Weatherstrip Clip

f. Removal and Installation of Tail Gate Bottom Drain Hole Sealing Strips

1. With a flat-bladed tool carefully pry out snap-on fastener at each end of strip and remove sealing strip from tail gate.

2. To install sealing strips, reverse removal procedure. To prevent strip from adhering to the tail gate panel and blocking the drain holes, apply a sparing amount of silicone rubber lubricant on the center section of the sealing strip. (See illustration under "Front and Rear Door Bottom Drain Hole Sealing Strips").